

INDEX OF SHEETS

- 1 COVER SHEET & INDEX OF SHEETS & STATE STANDARDS
- 2 SUMMARY OF QUANTITIES
- 3 TYPICAL SECTIONS
- 4 GENERAL NOTES
- 5 SCHEDULE OF QUANTITIES
- 6 EARTHWORK SCHEDULE
- 7-8 PLAN SHEETS
- 9 HOT-MIX ASPHALT SHOULDER (DIST STD 23.4c)
- 9 DELINEATOR AND POST (DIST STD 37.4)
- 9 TYPICAL BENCHING DETAIL ON EXISTING EMBANKMENT (DIST STD 50.4)
- 10-11 TYPICAL PAVEMENT MARKINGS (DIST STD 41.1)
- 12-19 CROSS SECTIONS

STATE STANDARDS

- 000001-05 STANDARD SYMBOLS, ABBREVIATIONS, AND PATTERNS
- 280001-04 TEMPORARY EROSION CONTROL SYSTEMS
- 482001-02 HMA SHOULDER ADJACENT TO FLEXIBLE PAVEMENT
- 542546 FLUSH INLET BOX FOR MEDIAN
- 635001 DELINEATORS
- 642001 SHOULDER RUMBLE STRIPS
- 701001-01 OFF-ROAD OPERATIONS, 2L, 2W, MORE THAN 4.5m (15') AWAY
- 701006-02 OFF-ROAD OPERATIONS, 2L, 2W, 4.5m (15') TO 600mm (24") FROM PAVEMENT EDGE
- 701011-01 OFF-ROAD MOVING OPERATIONS, 2L, 2W, DAY ONLY
- 701201-02 LANE CLOSURE, 2L, 2W, DAY ONLY, FOR SPEEDS ≥ 45 MPH
- 701301-02 LANE CLOSURE, 2L, 2W, SHORT TIME OPERATIONS
- 701311-02 LANE CLOSURE, 2L, 2W, MOVING OPERATIONS - DAY ONLY
- 701326-02 LANE CLOSURE, 2L, 2W, PAVEMENT WIDENING, FOR SPEEDS ≥ 45 MPH
- 701901 TRAFFIC CONTROL DEVICES
- 720011 METAL POSTS FOR SIGNS, MARKERS AND DELINEATORS
- 728001 TELESCOPING STEEL SIGN SUPPORT
- 729001 APPLICATIONS OF TYPES A AND B METAL POSTS (FOR SIGNS AND MARKERS)

STATE OF ILLINOIS
DEPARTMENT OF TRANSPORTATION
DIVISION OF HIGHWAYS
PROPOSED
HIGHWAY PLANS

FAP ROUTE 646 (IL 40)
SECTION 5M-1
PROJECT ACHSIP-0646(067)
CARROLL COUNTY
C-92-010-09



F.A.P. RTE.	SECTION	COUNTY	TOTAL SHEETS	SHEET NO.
646	5M-1	CARROLL	19	1
FED. ROAD DIST. NO.	ILLINOIS	CONTRACT NO. 64E50		

D-92-016-08



LOCATION OF SECTION INDICATED THUS: - [black rectangle] -

WYSOX TOWNSHIP 16 & 17

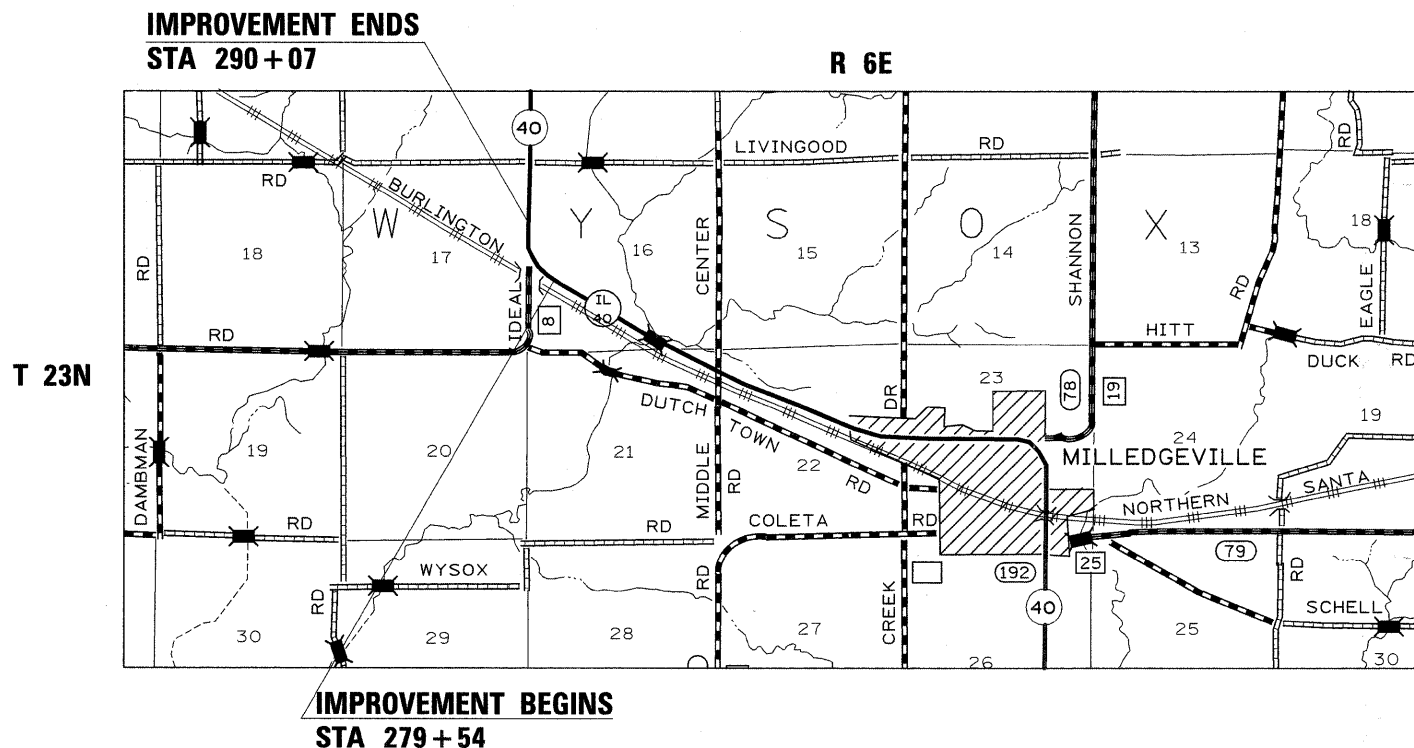

J.U.L.I.E.
 JOINT UTILITY LOCATION INFORMATION FOR EXCAVATION
 1-800-892-0123
 OR 811

PROJECT ENGINEER: MASOOD AHMAD
SENIOR SQUAD LEADER: SAM ABDULLAH (815) 284-5935
SQUAD LEADER: DAVID DOSS (815) 284-5516
CONTRACT NO. 64E50

GROSS LENGTH = 1053 FT. = 0.20 MILE
NET LENGTH = 1053 FT. = 0.20 MILE

STATE OF ILLINOIS
DEPARTMENT OF TRANSPORTATION
DIVISION OF HIGHWAYS

SUBMITTED August 4, 2008

George F. Ryan
 DEPUTY DIRECTOR OF HIGHWAYS, REGION ENGINEER

October 3, 2008
Eric E. Blum
 INTERIM ENGINEER OF DESIGN AND ENVIRONMENT

October 3, 2008
Christine M. Reed
 DIRECTOR OF HIGHWAYS, CHIEF ENGINEER

PRINTED BY THE AUTHORITY
OF THE STATE OF ILLINOIS

SUMMARY OF QUANTITIES

SFTY-2A

CODE NUMBER	ITEM	UNIT	TOTAL QUANTITY	90% FED 10% STATE
20200100	EARTH EXCAVATION	CU YD	618	618
28000300	TEMPORARY DITCH CHECKS	EACH	46	46
28000500	INLET AND PIPE PROTECTION	EACH	1	1
40603310	HOT-MIX ASPHALT SURFACE COURSE, MIX "C", N50	TON	58	58
48101600	AGGREGATE SHOULDERS, TYPE B 8"	SQ YD	790	790
48203023	HOT-MIX ASPHALT SHOULDERS, 6 1/2"	SQ YD	687	687
50104400	CONCRETE HEADWALL REMOVAL	EACH	1	1
54244405	FLUSH INLET BOX FOR MEDIAN, STANDARD 542546	EACH	1	1
63500105	DELINEATORS	EACH	4	4
64200105	SHOULDER RUMBLE STRIP	FOOT	1,545	1,545
67100100	MOBILIZATION	L SUM	1	1
70100450	TRAFFIC CONTROL AND PROTECTION, STANDARD 701201	L SUM	1	1
70100500	TRAFFIC CONTROL AND PROTECTION, STANDARD 701326	L SUM	1	1
* 78001110	PAINT PAVEMENT MARKING - LINE 4"	FOOT	8,104	8,104
●* Z0014800	CULVERT TO BE CLEANED	FOOT	38	38

* SPECIALTY ITEM ● NP 100% STATE

STA 279+54 TO STA 280+54
 STA 289+07 TO STA 290+07

IL 40

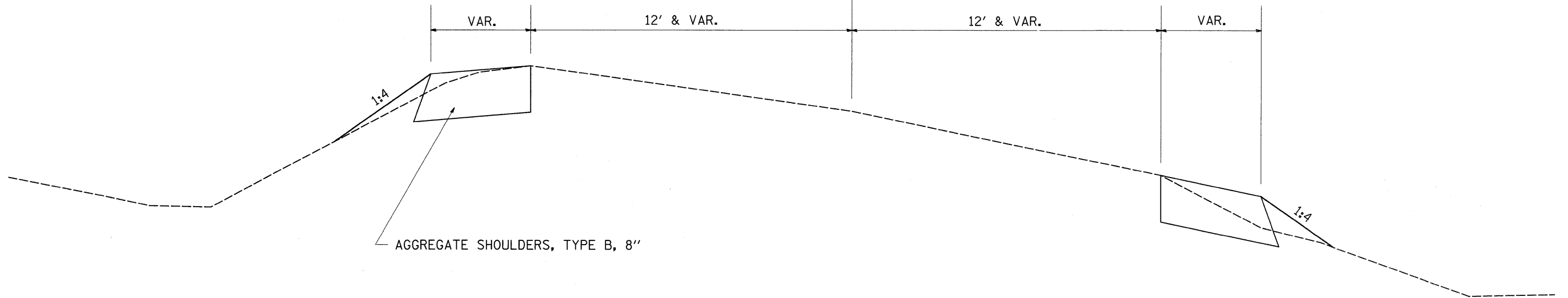

STA 280+54 TO STA 289+07

IL 40

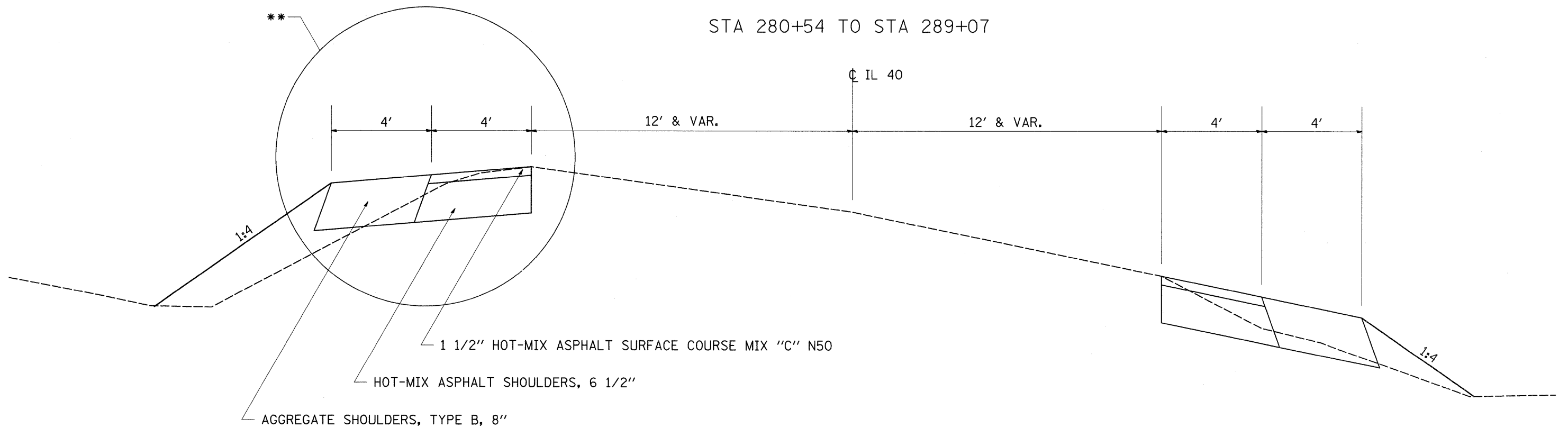

** = ELIMINATE AGGREGATE SHOULDER, TYPE B, 8" FROM STA 285+45.31 LT TO STA 286+72.89 LT

FILE NAME = c:\projects\p201608\d01608typ.dgn	USER NAME = dosadd	DESIGNED -	REVISED -	STATE OF ILLINOIS DEPARTMENT OF TRANSPORTATION	TYPICAL SECTION				F.A.P. RTE. 646	SECTION 5M-1	COUNTY CARROLL	TOTAL SHEETS 19	SHEET NO. 3
	PLOT SCALE = 20.0000' / IN.	DRAWN -	REVISED -		SCALE:	SHEET NO.	OF	SHEETS	STA.	TO STA.	CONTRACT NO. 64E50		
	PLOT DATE = Wed Jul 30 11:01:20 2008	CHECKED -	REVISED -		FED. ROAD DIST. NO. ILLINOIS FED. AID PROJECT								
		DATE -	REVISED -										

GENERAL NOTES

ROUTE NO.	SEC.	COUNTY	TOTAL SHEETS	SHEET NO.
FAP 646 (IL 40)	5M-1	Carroll	19	4
FED ROAD DIST. NO.	ILLINOIS	PROJECT		
Contract #64E50				

See cross sections for special ditches and backslopes.

The final top 100 mm (four inches) of soil in any right-of-way area disturbed by the Contractor must be capable of supporting vegetation. The soil must be from the A horizon (zero to 2' deep) of soil profiles of local soils.

All Borrow/Waste/Use sites must be approved by the Department prior to removing any material from the project or initiating any earthmoving activities, including temporary stockpiling outside the limits of construction.

The Contractor shall seed all disturbed areas within the project limits. Seeding Class 4 or 2A shall be used, except in front of properties where the grass will be mowed, then use Seeding, Class 1. Class 2A shall be used on front slopes and ditch bottoms. Class 4 shall be used behind Type A gutter, on all backslopes and areas behind the backslope, and beyond the toe of front slope on fill sections without ditches. This work will be included in the contract unit price per Cubic Meter (Cubic Yard) for EARTH EXCAVATION.

Fertilizer shall be applied to all disturbed areas and incorporated into the seedbed prior to seeding or placement of sod at the rate specified in Sections 250 and 252 of the Standard Specifications. This work shall be included in the cost of EARTH EXCAVATION.

Mulch Method II shall be applied over all seeded areas. This shall be included in the cost of the EARTH EXCAVATION.

The following Mixture Requirements are applicable for this project:

Mixture Uses(s):	Top Shoulder	Bottom Shoulder	
PG:	PG 58-22	PG 58-22	
Design Air Voids	3.0% @ N50	2.0% @ N50	
Mixture Composition (Gradation Mixture)	IL 9.5 or 12.5	IL 19.0 or BAM	
Friction Aggregate	C	---	
20 Year ESAL	0.7	---	

Install rumble strips in all shoulders in accordance with State Standard 642001. Rumble Strips shall be placed on shoulders on both sides of the pavement.

The Contractor shall be responsible for protecting utility property during construction operations as outlined in Article 107.31 of the Standard Specifications. A minimum of 48 hours advance notice is required for non-emergency work. The JULIE number is 800-892-0123. The following listed utilities located within the project limits or immediately adjacent to the project construction limits are members of JULIE:

(Type names of JULIE companies from attached utility form. No addresses.)

Following are the known utilities located within the project limits or immediately adjacent to the project construction limits which are not members of JULIE and should be notified individually by the contractor:

(Type Non-Julie company name, address, and phone number.)

CADD data will be available to Contractors and Consultants working on this project. This information will be provided upon request as MicroStation CADD files and Geopak coordinate geometry files ONLY. If data is required in other formats it will be your responsibility to make these conversions. If any discrepancy or inconsistency arises between the electronic data and the information on the hard copy, the information on the hard copy should be used. Contact the District's Project Engineer to request these files.

The Department shall be responsible for installing the chevrons on the project.

Program #5
(Arch. Size)
Enlarge
200%
Enlarge 107%

28000300 TEMPORARY DITCH CHECKS

EACH	LOCATION
	IL 40
1	Sta 280+50 RT
1	Sta 282+0 RT
1	Sta 282+50 LT
1	Sta 283+0 RT
1	Sta 285+0 RT
1	Sta 285+0 LT
1	Sta 285+25 LT
1	Sta 285+36 RT
1	Sta 285+50 LT
1	Sta 285+72 RT
1	Sta 285+75 LT
1	Sta 286+0 RT
1	Sta 286+0 LT
1	Sta 286+25 RT
1	Sta 286+25 LT
1	Sta 286+50 RT
1	Sta 286+50 LT
1	Sta 286+75 RT
1	Sta 287+0 RT
1	Sta 287+20 RT
1	Sta 287+40 RT
1	Sta 287+60 RT
1	Sta 287+80 RT
1	Sta 288+0 RT
1	Sta 288+0 LT
1	Sta 288+15 LT
1	Sta 288+20 RT
1	Sta 288+30 LT
1	Sta 288+40 RT
1	Sta 288+45 LT
1	Sta 288+60 RT
1	Sta 288+60 LT
1	Sta 288+75 LT
1	Sta 288+80 RT
1	Sta 288+90 LT
1	Sta 289+0 RT
1	Sta 289+0 LT
1	Sta 289+15 RT
1	Sta 289+15 LT
1	Sta 289+30 RT
1	Sta 289+30 LT
1	Sta 289+45 RT
1	Sta 289+45 LT
1	Sta 289+60 RT
1	Sta 289+75 RT
1	Sta 289+90 RT
<u>46</u>	TOTAL

28000500 INLET AND PIPE PROTECTION

EACH	LOCATION
	IL 40
<u>1</u>	Sta 286+50 2' RT
1	TOTAL
40603310 HOT-MIX ASPHALT SURFACE COURSE, MIX "C", N50	
	TON LOCATION
	IL 40
31.8	Sta 280+54 - 289+07 RT
16.9	Sta 280+54 - 285+07 LT
48	Sta 285+45 - 286+73 LT
<u>42</u>	Sta 287+95 - 289+07 LT
57.7	TOTAL
48101600 AGGREGATE SHOULDERS, TYPE B 8"	
	SQ YD LOCATION
	IL 40
67	Sta 279+54 - 280+54 RT/LT
67	Sta 289+07 - 290+17 RT/LT
205	Sta 280+54 - 285+15 RT
25	Sta 285+15 - 285+40 FE+31 RT
163	Sta 285+40 - 289+07 RT
203	Sta 280+54 - 285+11 LT
<u>287</u>	Sta 60 +71 - 289+07 LT
790	TOTAL
48203023 HOT-MIX ASPHALT SHOULDERS, 6 1/2"	
	SQ YD LOCATION
	IL 40
379	Sta 280+54 - 289+07 RT
201	Sta 280+54 - 285+07 LT
57	Sta 285+45 - 286+73 LT
<u>287</u>	Sta 50 +95 - 289+07 LT
687	TOTAL
50104400 CONCRETE HEADWALL REMOVAL	
	EACH LOCATION
	IL 40
<u>1</u>	Sta 286+55 LT
1	TOTAL

54244405 FLUSH INLET BOX FOR MEDIAN, STANDARD 542546

EACH	LOCATION
	IL 40
<u>1</u>	Sta 286+55 LT
1	TOTAL

63500105 DELINEATORS

EACH	LOCATION
	IL 40
1	Sta 285+17.7 RT
1	Sta 285+45.4 RT
1	Sta 286+55.7 LT
<u>1</u>	Sta 286+75.8 LT
4	TOTAL

64200105 SHOULDER RUMBLE STRIP

FOOT	LOCATION
	IL 40
852	Sta 280+54 - 289+07 RT
453	Sta 280+54 - 285+07 LT
128	Sta 285+45 - 286+73 LT
<u>112</u>	Sta 287+95 - 289+07 LT
1,545	TOTAL

78001110 PAINT PAVEMENT MARKING - LINE 4" (2 APPLICATIONS)

FOOT	LOCATION
	IL 40
2,106	Sta 279+54 - 290+07 RT (WHITE)
1,106	Sta 279+54 - 285+07 LT (WHITE)
256	Sta 285+45 - 286+73 LT (WHITE)
424	Sta 287+95 - 290+07 LT (WHITE)
<u>4,212</u>	Sta 279+54 - 290+07 RT & LT (DBL YELLOW)
8,104	TOTAL

Z0014800 CULVERT TO BE CLEANED

FOOT	LOCATION
	IL 40
<u>38</u>	Sta 286+55 LT (15" RCP @ Ideal Rd.)
38	TOTAL

EARTHWORK SCHEDULE

LOCATION	EARTH EXC	EARTH EXC ADJ SHRINK	EMBANK	EARTH WORK BALANCE WASTE (+)
	(CUT)	25%	(FILL)	SHORTAGE (-)
	CU YD	CU YD	CU YD	CU YD
279+50 - 290+50	618	463	272	192

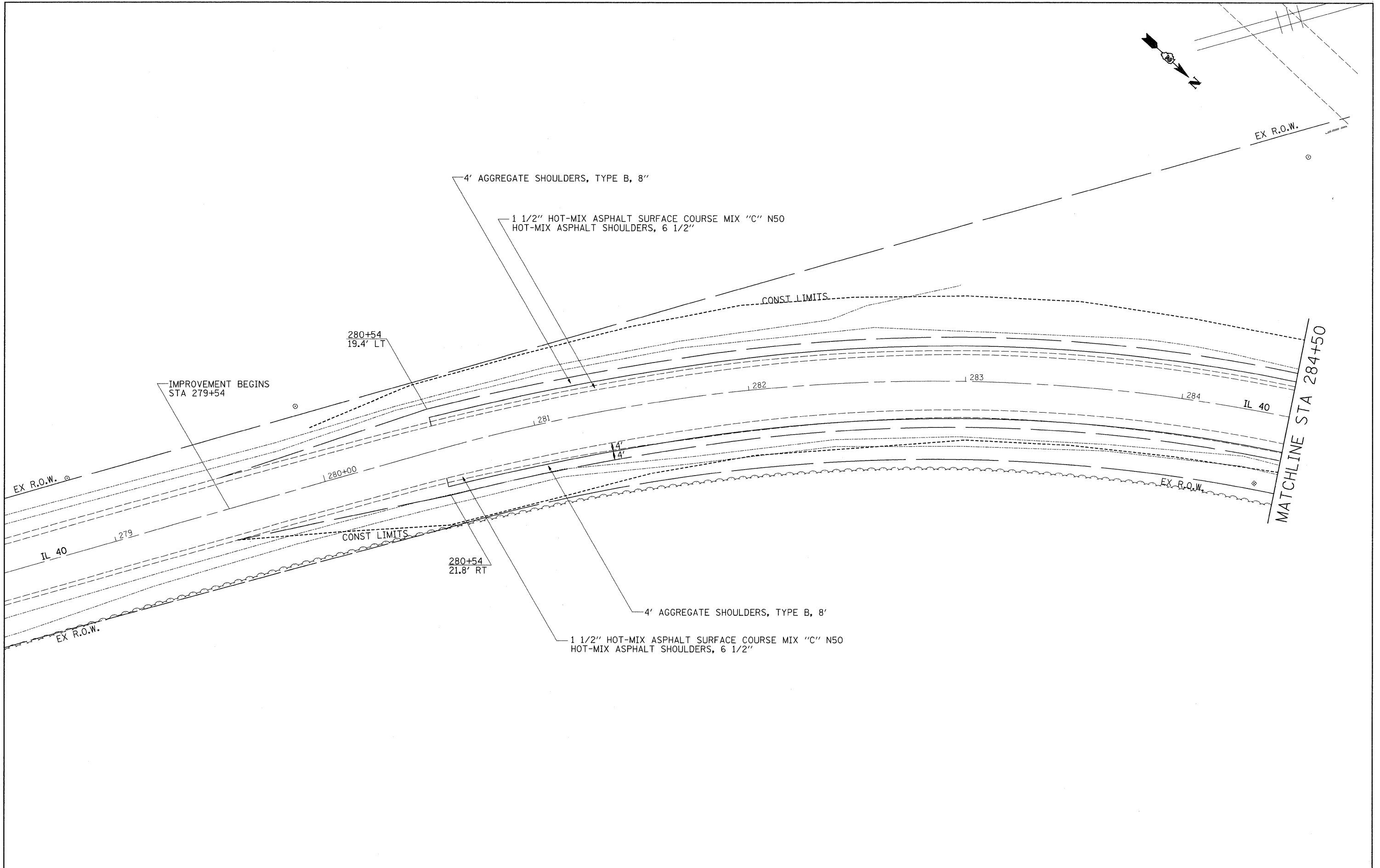

FILE NAME = c:\projects\p201608\d01608p1n.dgn	USER NAME = dosadd	DESIGNED -	REVISED -	STATE OF ILLINOIS DEPARTMENT OF TRANSPORTATION	IL 40			F.A.P. RTE. 646	SECTION 5M-1	COUNTY CARROLL	TOTAL SHEETS 19	SHEET NO. 7
	PLOT SCALE = 20.0000' / IN.	DRAWN -	REVISED -		SCALE:	SHEET NO.	OF	SHEETS	STA.	TO STA.	CONTRACT NO. 64E50	
	PLOT DATE = Wed Jul 30 11:02:19 2008	CHECKED -	REVISED -		FED. ROAD DIST. NO. [ILLINOIS] FED. AID PROJECT							
		DATE -	REVISED -									

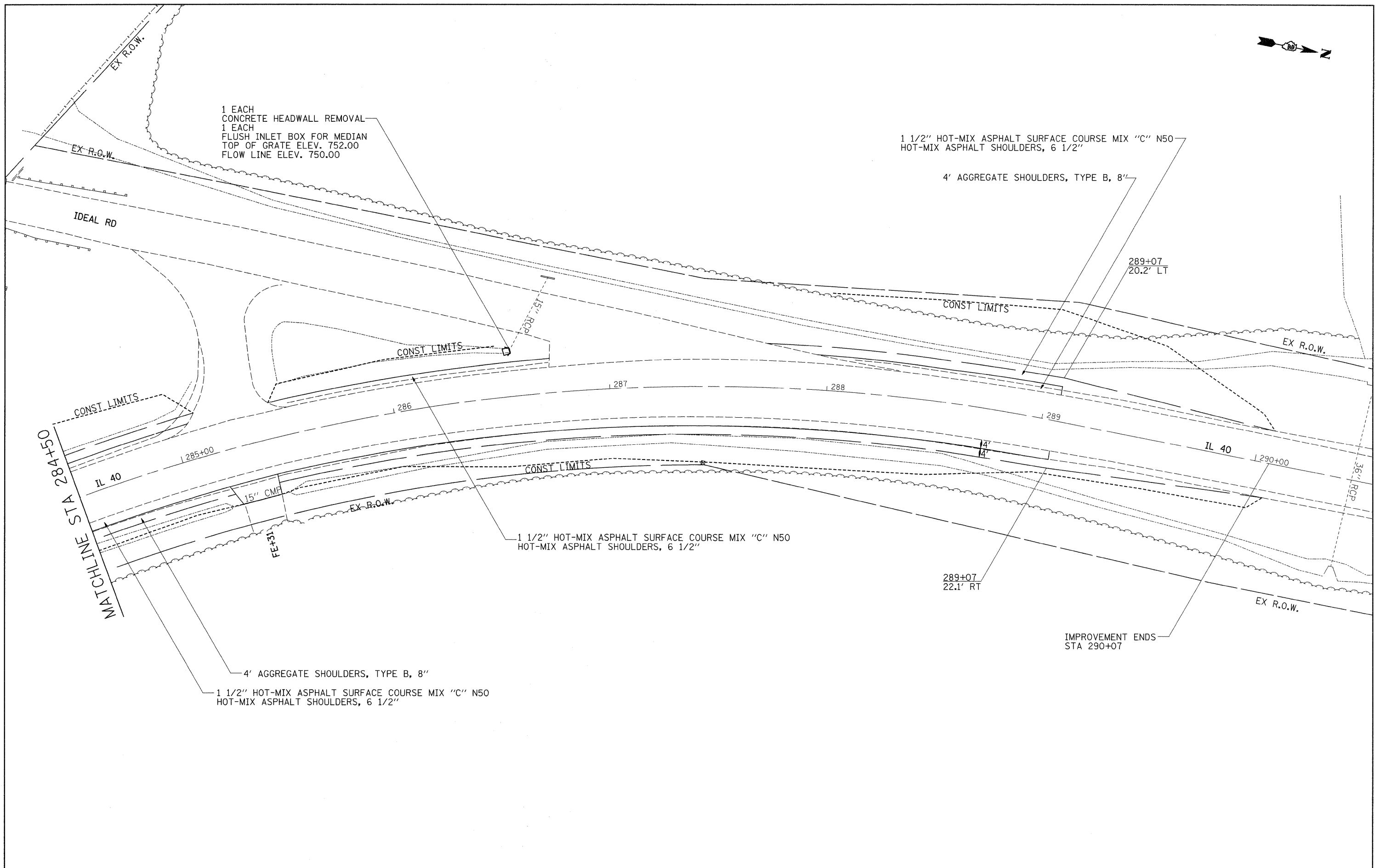

FILE NAME =
 c:\projects\p201608\d01608pin.dgn

USER NAME = dossed
 PLOT SCALE = 20.0000' / IN.
 PLOT DATE = Wed Jul 30 11:02:19 2008

DESIGNED -
 DRAWN -
 CHECKED -
 DATE -

REVISED -
 REVISED -
 REVISED -
 REVISED -

**STATE OF ILLINOIS
 DEPARTMENT OF TRANSPORTATION**

IL 40

SCALE: SHEET NO. OF SHEETS STA. TO STA.

F.A.P. RTE.	SECTION	COUNTY	TOTAL SHEETS	SHEET NO.
646	5M-1	CARROLL	19	8
FED. ROAD DIST. NO. ILLINOIS FED. AID PROJECT			CONTRACT NO. 64E50	

HOT-MIX ASPHALT SHOULDER

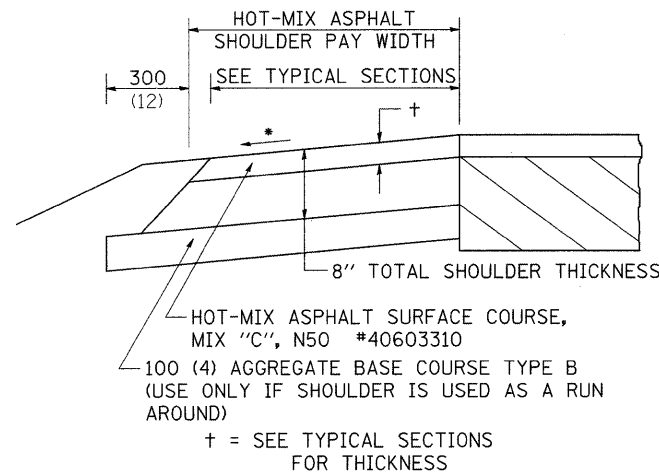

GENERAL NOTES

THE HOT-MIX ASPHALT SHOULDER SHALL BE CONSTRUCTED IN ACCORDANCE WITH SECTION 482 EXCEPT THE TOP LIFT SHALL BE HOT-MIX ASPHALT SURFACE COURSE, MIX "C", N50 *40603310. THE WORK WILL BE PAID FOR AT THE CONTRACT UNIT PRICE PER TON FOR HOT-MIX ASPHALT SURFACE COURSE, MIX "C", N50 *40603310 AND SQUARE YARD FOR HOT-MIX ASPHALT SHOULDERS OF THE THICKNESS SPECIFIED.

USE HOT-MIX ASPHALT SURFACE COURSE, MIX "C", N50 *40603310. WHEN RESURFACING EXISTING HOT-MIX ASPHALT SHOULDERS. THE THICKNESS IS SHOWN ON THE TYPICAL SECTIONS. THIS WORK WILL BE PAID FOR AT THE CONTRACT UNIT PRICE PER TON FOR HOT-MIX ASPHALT SURFACE COURSE, MIX "C", N50 *40603310.

REMOVAL OF MATERIAL FOR PLACEMENT OF THE HOT-MIX ASPHALT SHOULDER TO BE PAID FOR IN UNITS FOR EXCAVATING AND GRADING EXISTING SHOULDERS OR IN CUBIC YARDS FOR EARTH EXCAVATION OR EARTH EXCAVATION WIDENING.

* 4% WHEN MAINLINE IS ON TANGENT. FOR CROSS SLOPE ON SUPERELEVATION SECTION, SEE HIGHWAY STANDARD 482001 OR 482006.

ALL DIMENSIONS ARE IN MILLIMETERS (INCHES) UNLESS OTHERWISE NOTED.

REVISED - 11-01-07

HOT-MIX ASPHALT SHOULDER 23.4a

DELINEATOR AND POST ORIENTATION

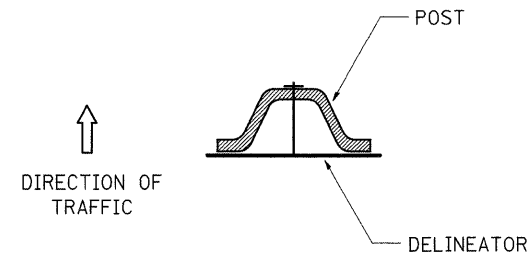

DELINEATORS SHALL BE INSTALLED ACCORDING TO STANDARD 635001 EXCEPT THAT THE POST SHALL BE ROTATED 180°. THE POST WILL HAVE THE WIDE SIDE FACING TRAFFIC AND THE DELINEATOR ATTACHED AS SHOWN ABOVE.

ALL DIMENSIONS ARE IN MILLIMETERS (INCHES) UNLESS OTHERWISE NOTED.

REVISED - 11-01-07

DELINEATOR AND POST ORIENTATION 37.4

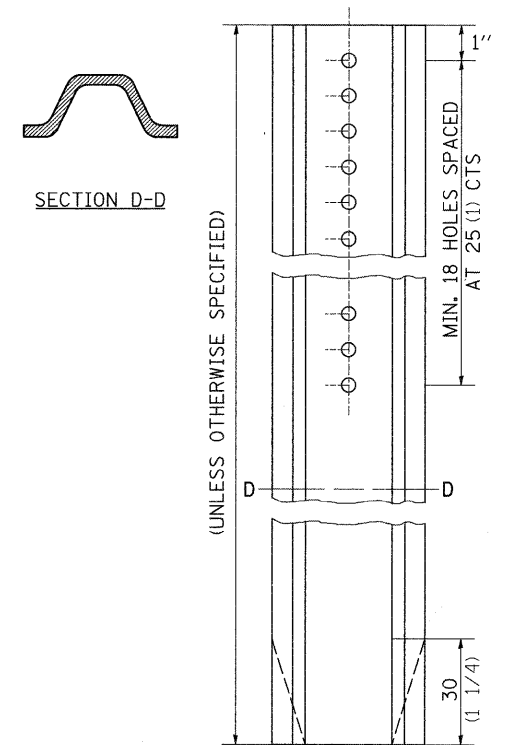

TYPICAL BENCHING ON EXISTING EMBANKMENT

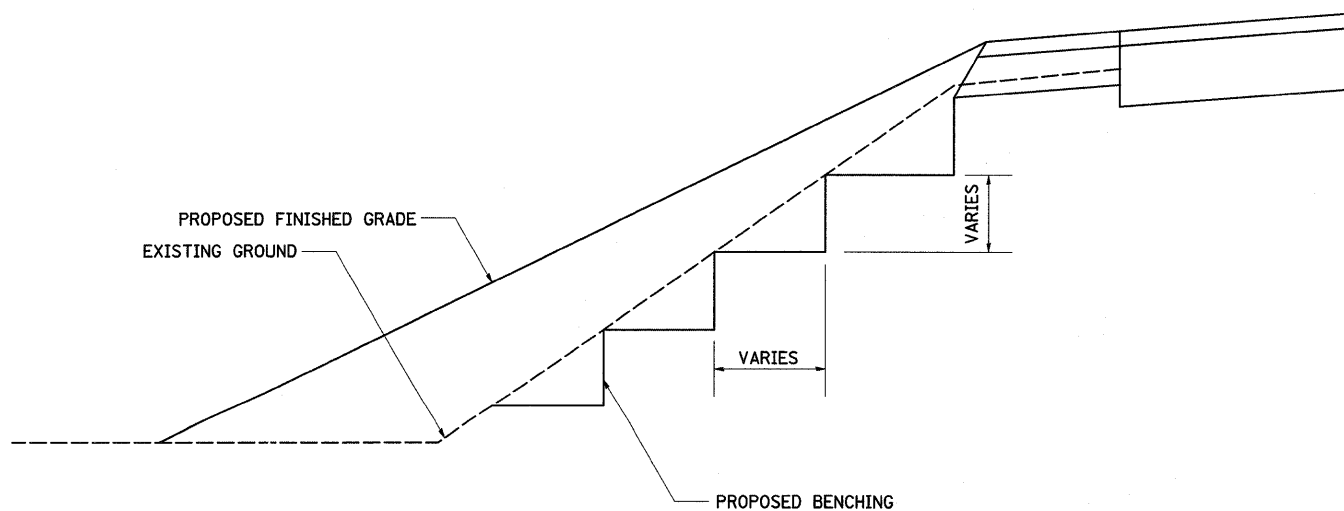

REVISED - 2-22-06

TYPICAL BENCHING ON EXISTING EMBANKMENT 50.4

REVISED -	REGION 2 / DISTRICT 2 STANDARD	F.A.P. RTE.	SECTION	COUNTY	TOTAL SHEETS	SHEET NO.	
REVISED -		646	5M-1	CARROLL	19	9	
REVISED -		CONTRACT NO. 64E50					
REVISED -		SCALE: 50.0000' / 1"	SHEET NO.	OF SHEETS	STA.	TO STA.	FED. ROAD DIST. NO. ILLINOIS FED. AID PROJECT
REVISED -							

PLOT DATE = Wed Jul 30 10:59:43 2008

TYPICAL PAVEMENT MARKINGS

TYPICAL PAVEMENT MARKING FOR FLUSH MEDIAN AT LEFT TURN LANE

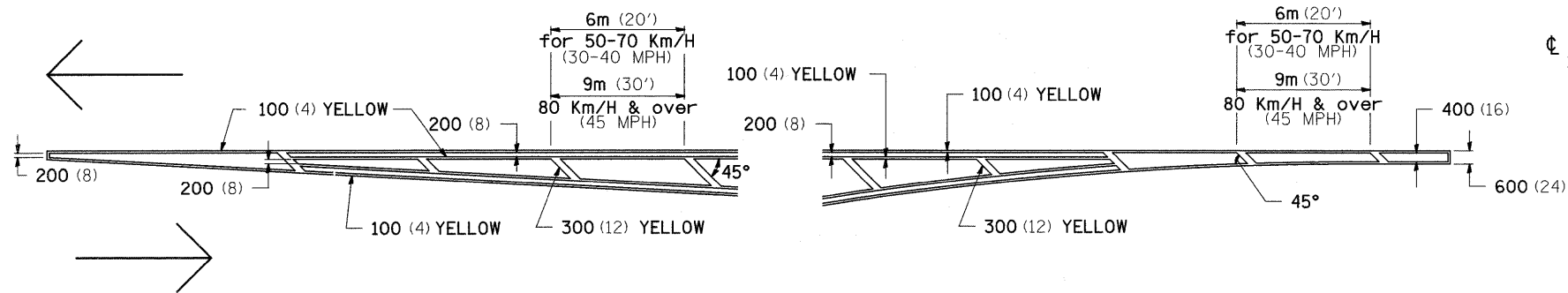

MEDIAN PAVEMENT MARKING

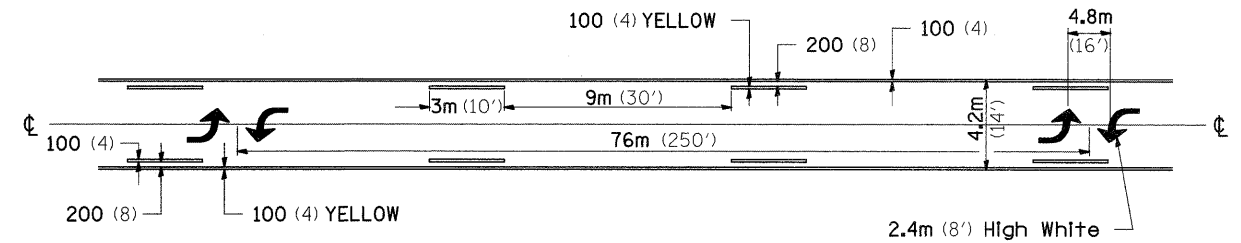

** ALL DIMENSIONS ARE IN MILLIMETERS (INCHES) UNLESS OTHERWISE NOTED.

TYPICAL ISLAND OFFSET SHOULDER WIDTH

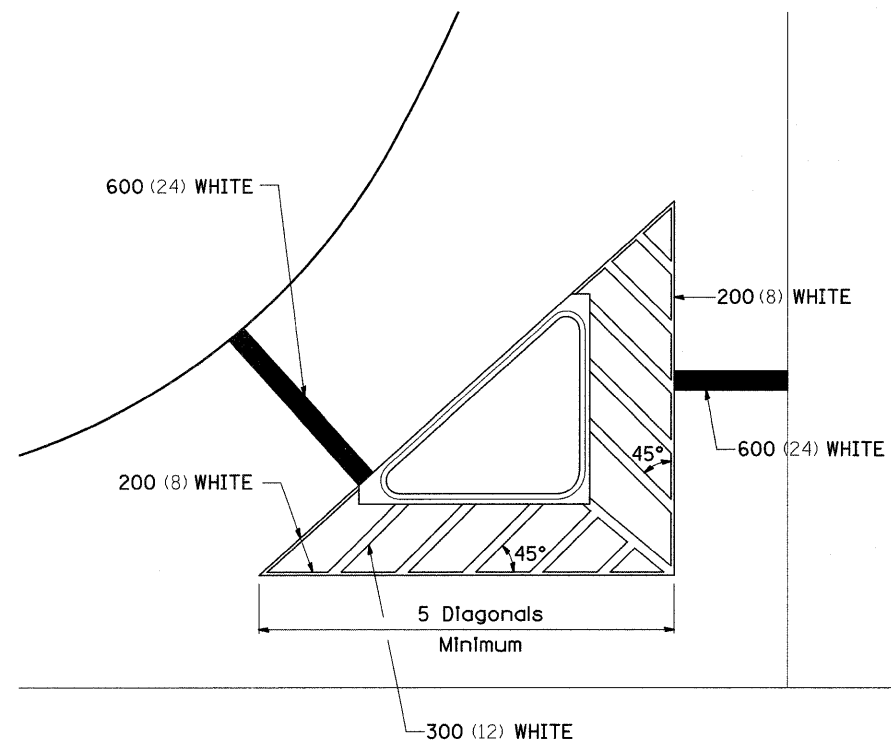

TYPICAL PARKING SPACING

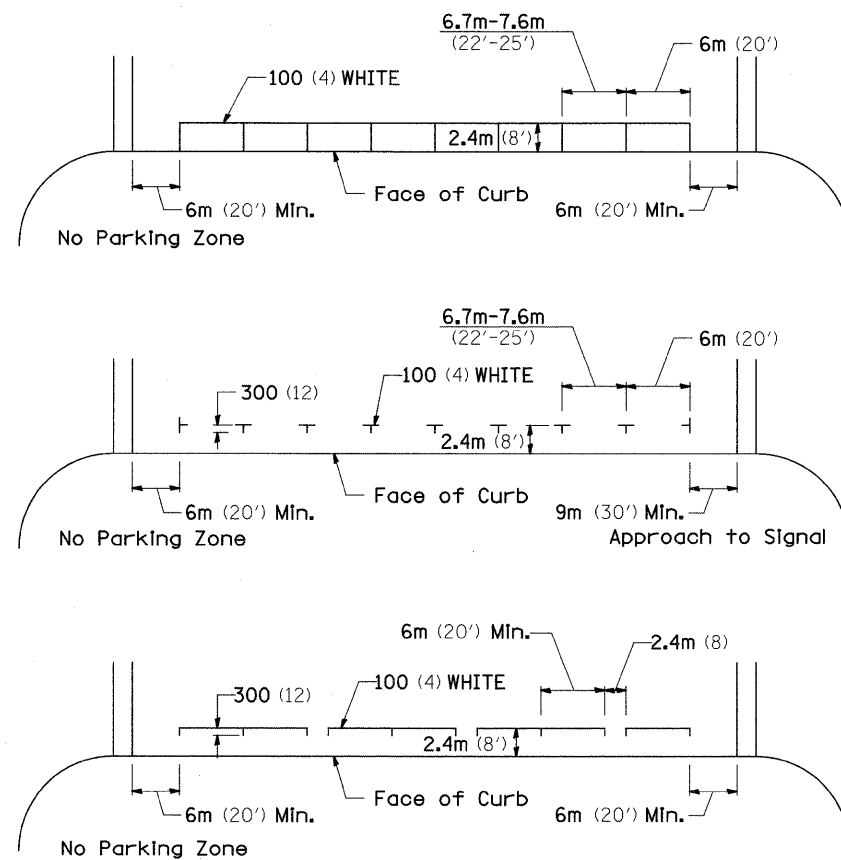

STANDARD CROSSWALK MARKING

See Schedules for Locations

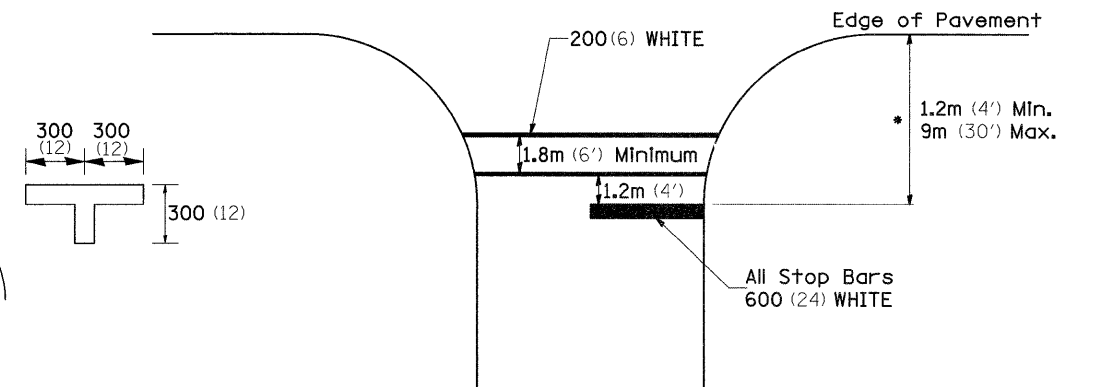

* Distance to the nearest edge of the intersecting roadway in the absence of a marked crosswalk.

FILE NAME = c:\projects\p201608\ad01608sp1.dgn	USER NAME = dosadd	DESIGNED -	REVISED - 1-11-08	STATE OF ILLINOIS DEPARTMENT OF TRANSPORTATION	REGION 2 / DISTRICT 2 STANDARD			F.A.P. RTE. 646	SECTION 5M-1	COUNTY CARROLL	TOTAL SHEETS 19	SHEET NO. 10
PLOT SCALE = 50.0000' / IN.		CHECKED -	REVISED -		SCALE:	SHEET NO.	OF SHEETS	STA.	TO STA.	FED. ROAD DIST. NO. ILLINOIS FED. AID PROJECT		
PLOT DATE = Wed Jul 30 10:59:43 2008		DATE -	REVISED -					CONTRACT NO. 64E50				
TYPICAL PAVEMENT MARKINGS SHEET 1 OF 2 41.1												

TYPICAL PAVEMENT MARKINGS

ARROW LAYOUT

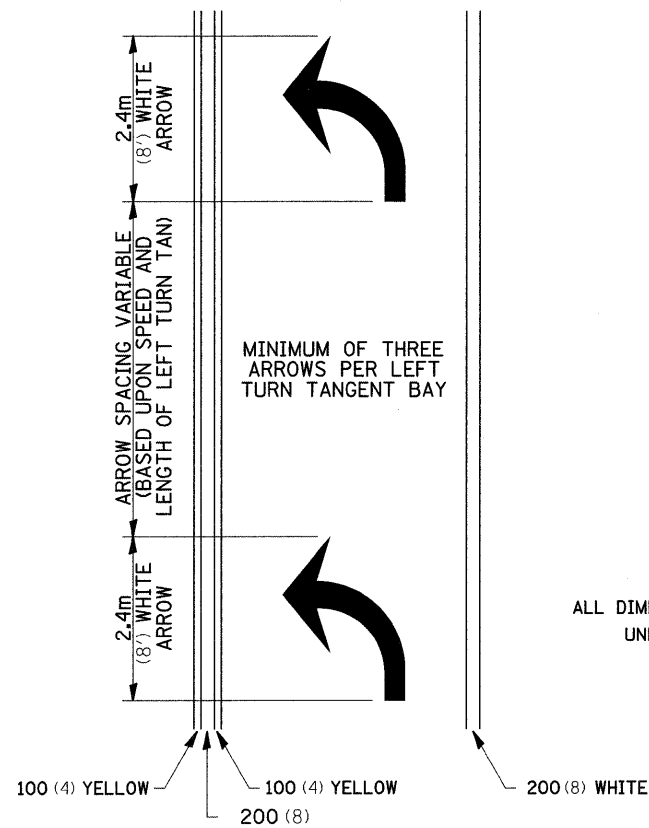

- ◀ ONE-WAY AMBER MARKER
- ◁ ONE-WAY CRYSTAL MARKER
- ◆ TWO-WAY AMBER MARKER

ALL DIMENSIONS ARE IN MILLIMETERS (INCHES) UNLESS OTHERWISE NOTED.

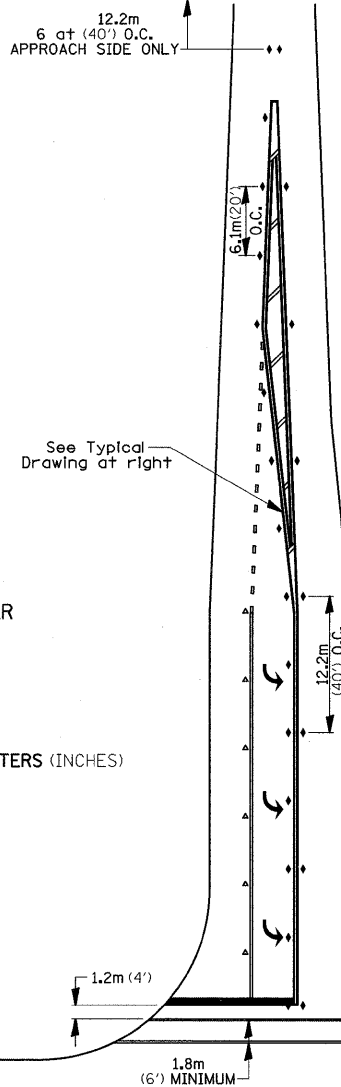

TYPICAL PAVEMENT MARKING FOR FLUSH MEDIAN

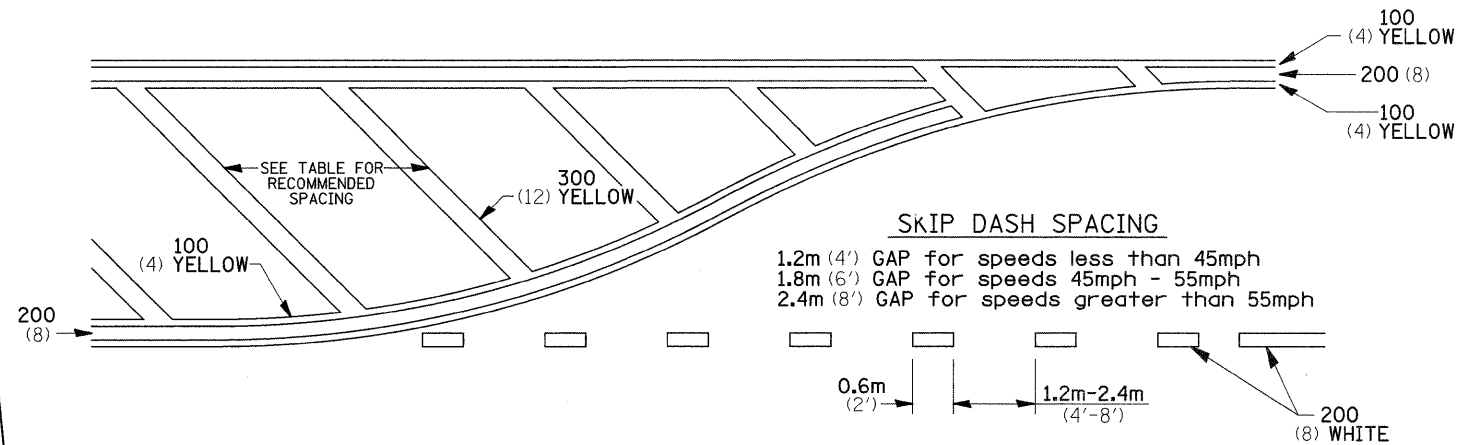

RECOMMENDED SPACING BETWEEN DIAGONALS (IN FEET)

Speed Limit Range	Continuous Median Area	Intersection Channelization	Objects (Islands)
less than 50Km/H (30MPH)	15.3m (50')	4.53m (15')	3.05m (10')
50-60Km/H (30-40MPH)	22.9m (75')	6.1m (20')	4.53m (15')
70Km/H (45MPH) & over	22.9m (75')	9.05m (30')	6.1m (20')

NOTE: If the spacing recommended in the Table does not permit at least five diagonal lines in the area being marked, the spacing from the next lowest speed range should be used. The recommended spacing is measured parallel to the pavement center line.

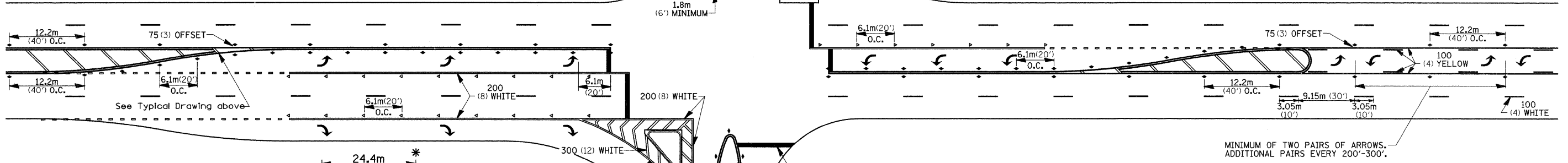

MINIMUM OF TWO PAIRS OF ARROWS, ADDITIONAL PAIRS EVERY 200'-300'.

TYPICAL PAVEMENT MARKING FOR TWO LANE SECTION - NO PASSING ZONES

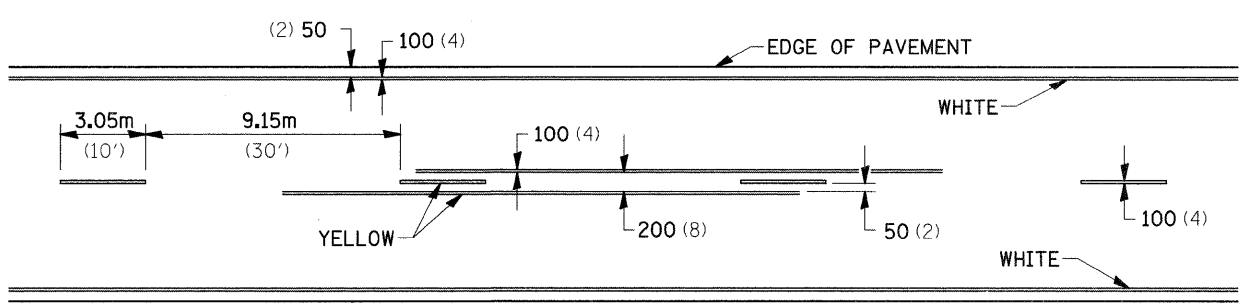

SYMBOLS

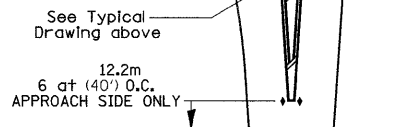

- * REDUCE TO 12.2m (40') O.C. ON CURVES WHERE ADVISORY SPEEDS ARE 15Km/H (10MPH) LOWER THAN POSTED SPEEDS.
- ** USE DOUBLE MARKERS WHEN ADT ≥ 25,000

MULTI-LANE / UNDIVIDED

FILE NAME =	USER NAME = dosddd	DESIGNED -	REVISED - 1-11-08	STATE OF ILLINOIS DEPARTMENT OF TRANSPORTATION	REGION 2 / DISTRICT 2 STANDARD			F.A.P. RTE. 646	SECTION 5M-1	COUNTY CARROLL	TOTAL SHEETS 19	SHEET NO. 11			
PROJECT NO. =	PLOT SCALE = 50,0000' / IN.	DRAWN -	REVISED -					SCALE:	SHEET NO. OF SHEETS	STA. TO STA.	FED. ROAD DIST. NO.	ILLINOIS FED. AID PROJECT	CONTRACT NO. 64E50		
	PLOT DATE = Wed Jul 30 10:59:43 2008	CHECKED -	REVISED -												
		DATE -	REVISED -												

DATE	
BY	
SURVEYED	
PLOTTED	
TEMPLATE	
NOTE BOOK	
AREAS CHECKED	

DATE	
BY	
SURVEYED	
PLOTTED	
TEMPLATE	
NOTE BOOK	
AREAS CHECKED	

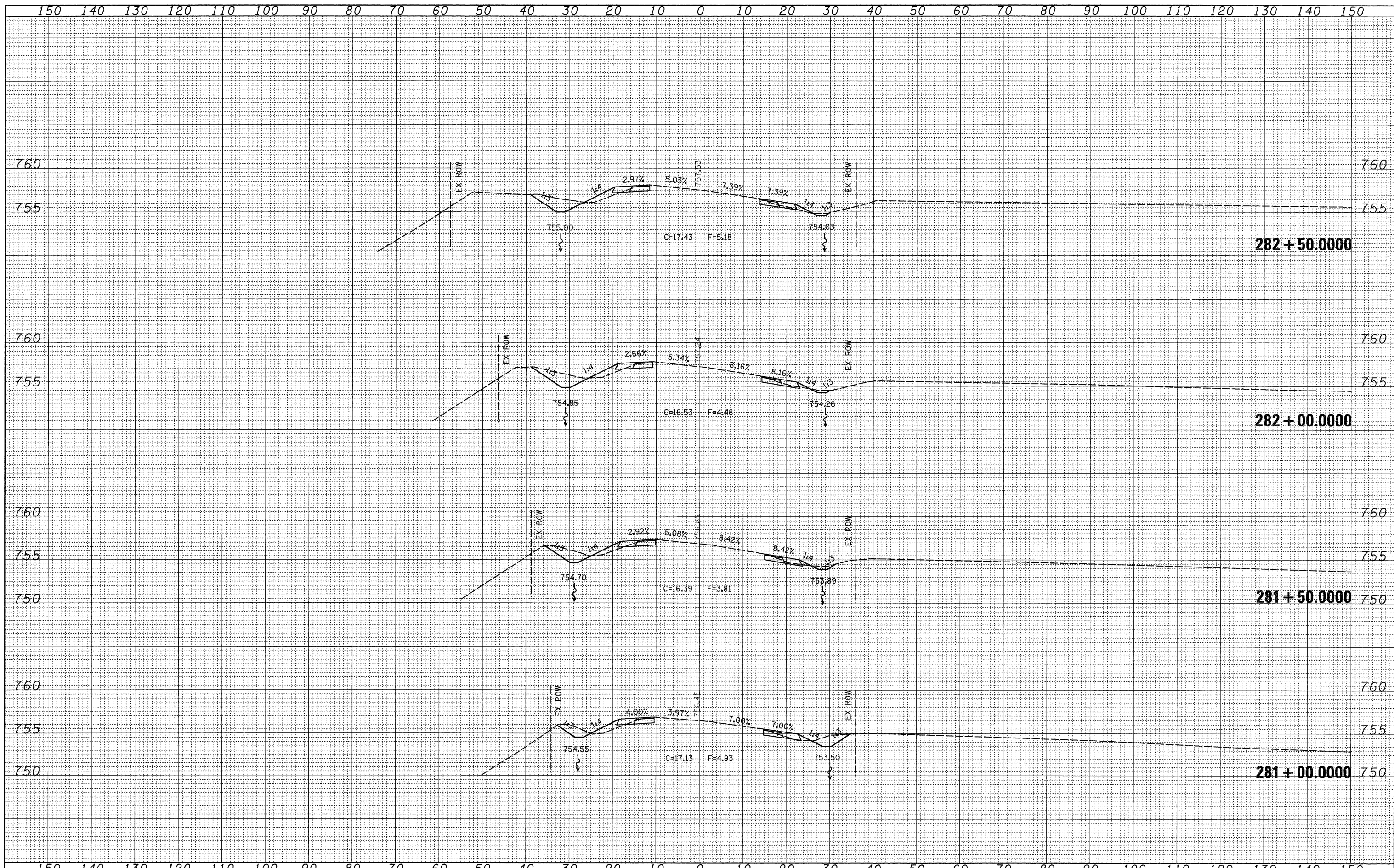

BY	DATE
SURVEYED	
PLOTTED	
TEMPLATE	
NOTE BOOK	
AREAS CHECKED	

BY	DATE
SURVEYED	
PLOTTED	
TEMPLATE	
NOTE BOOK	
AREAS CHECKED	

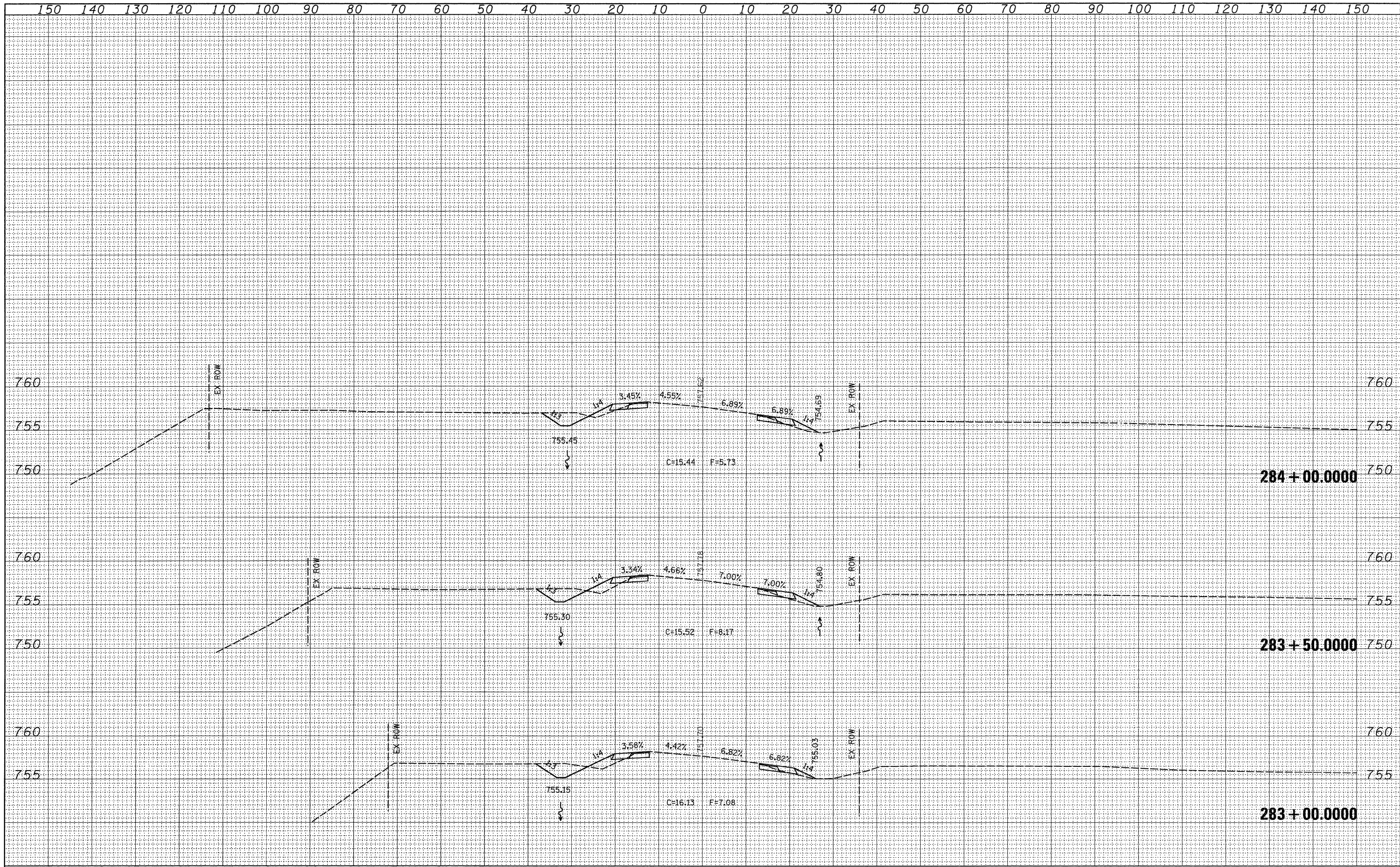

FILE NAME = c:\projects\p201608\d01608xm1.dgn
 USER NAME = dossed
 PLOT SCALE = 10.0000' / IN.
 PLOT DATE = Wed Jul 30 11:03:53 2008

DESIGNED -	REVISD -
DRAWN -	REVISD -
CHECKED -	REVISD -
DATE -	REVISD -

**STATE OF ILLINOIS
DEPARTMENT OF TRANSPORTATION**

SCALE:	SHEET NO.	OF	SHEETS	STA. 283+00.0000 TO STA. 284+00.0000
--------	-----------	----	--------	--------------------------------------

IL 40

F.A.P. RTE.	SECTION	COUNTY	TOTAL SHEETS	SHEET NO.
646	5M-1	CARROLL	19	14
CONTRACT NO. 64E50			FED. ROAD DIST. NO. [ILLINOIS] FED. AID PROJECT	

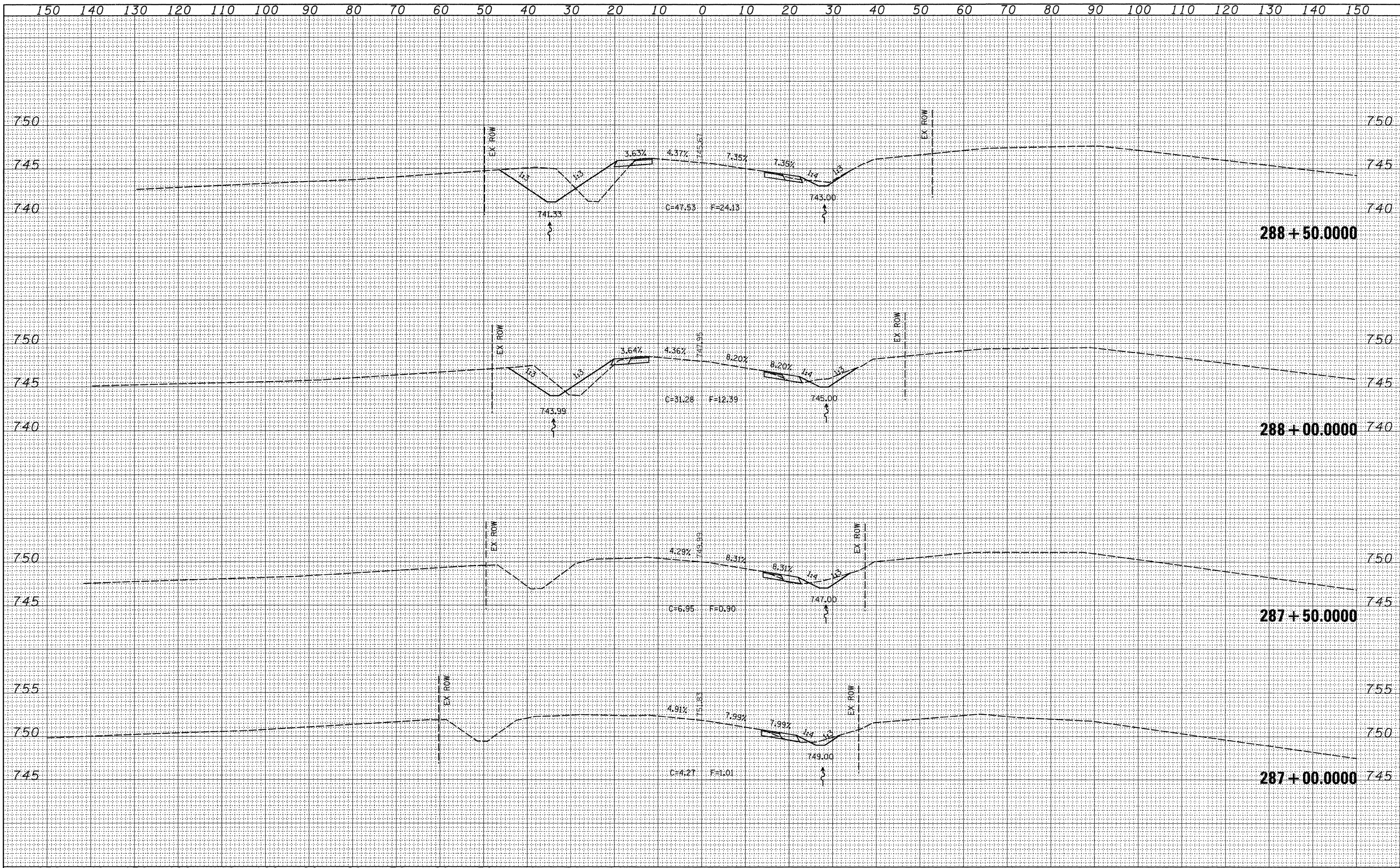

BY	DATE
SURVEYED	
PLOTTED	
TEMPLATE	
NOTE BOOK	
AREAS CHECKED	
NO.	

BY	DATE
ORIGINAL SURVEY	
PLOTTED	
TEMPLATE	
NOTE BOOK	
AREAS CHECKED	
NO.	

BY	DATE
SURVEYED	
PLOTTED	
TEMPLATE	
NOTE BOOK	
NO.	
AREAS CHECKED	

BY	DATE
SURVEYED	
PLOTTED	
TEMPLATE	
NOTE BOOK	
NO.	
AREAS CHECKED	

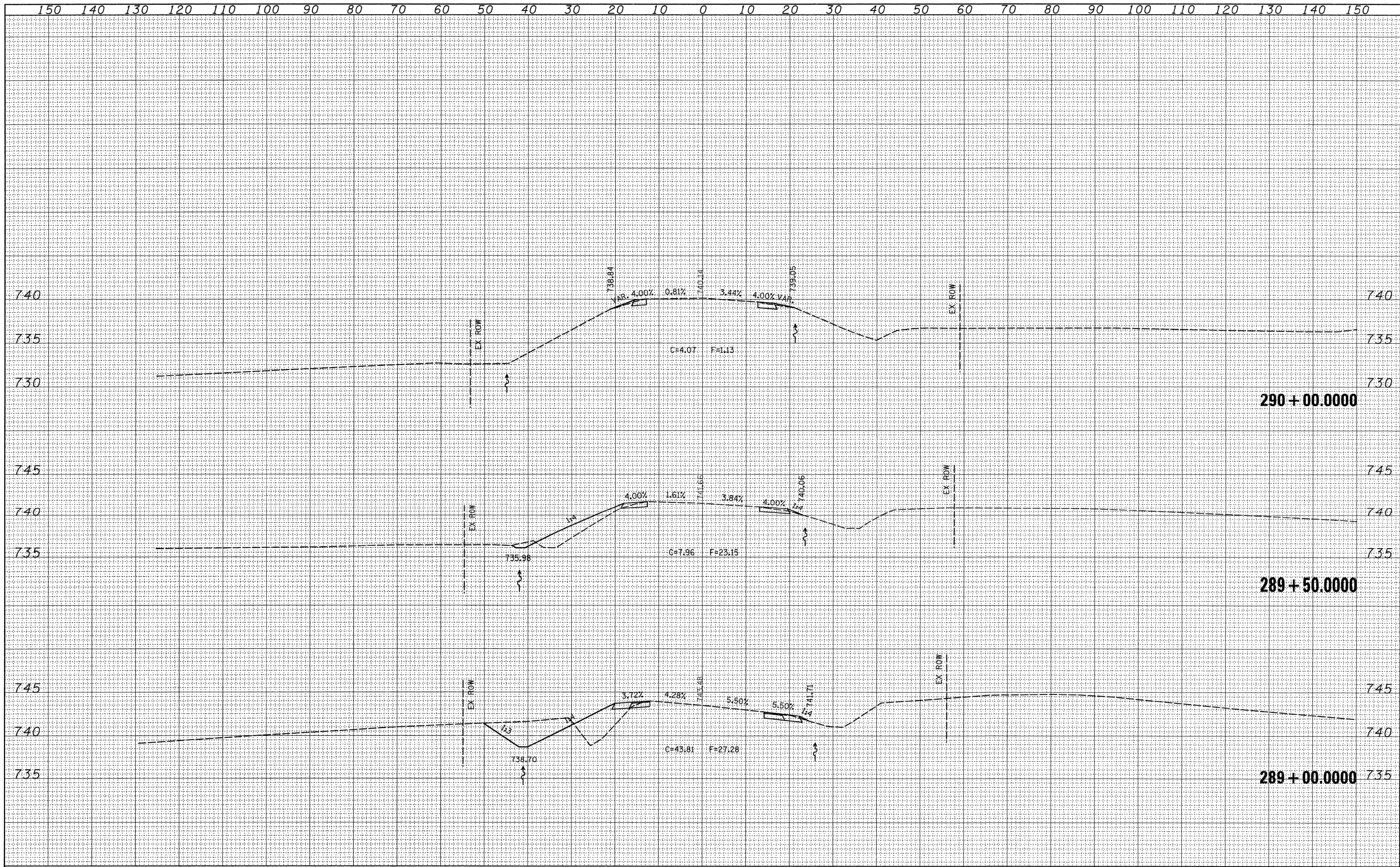

FILE NAME = c:\projects\p201608\d01608.xml.dgn	USER NAME = dossdd	DESIGNED - DRAWN - CHECKED - DATE -	REVISED - REVISED - REVISED - REVISED -	STATE OF ILLINOIS DEPARTMENT OF TRANSPORTATION		SCALE:	SHEET NO. OF SHEETS	STA. 289+00.0000 TO STA. 290+00.0000	F.A.P. RTE. 646	SECTION 5M-1	COUNTY CARROLL	TOTAL SHEETS 19	SHEET NO. 18
---	-----------------------	--	--	---	--	--------	---------------------	--------------------------------------	--------------------	-----------------	-------------------	--------------------	-----------------

IL 40		F.A.P. RTE. 646	SECTION 5M-1	COUNTY CARROLL	TOTAL SHEETS 19	SHEET NO. 18
--------------	--	--------------------	-----------------	-------------------	--------------------	-----------------

FED. ROAD DIST. NO. [ILLINOIS] FED. AID PROJECT CONTRACT NO. 64E50

DATE	
BY	
SURVEYED	
PLOTTED	
TEMPLATE	
NOTE BOOK	
AREAS CHECKED	

DATE	
BY	
SURVEYED	
PLOTTED	
TEMPLATE	
NOTE BOOK	
AREAS CHECKED	

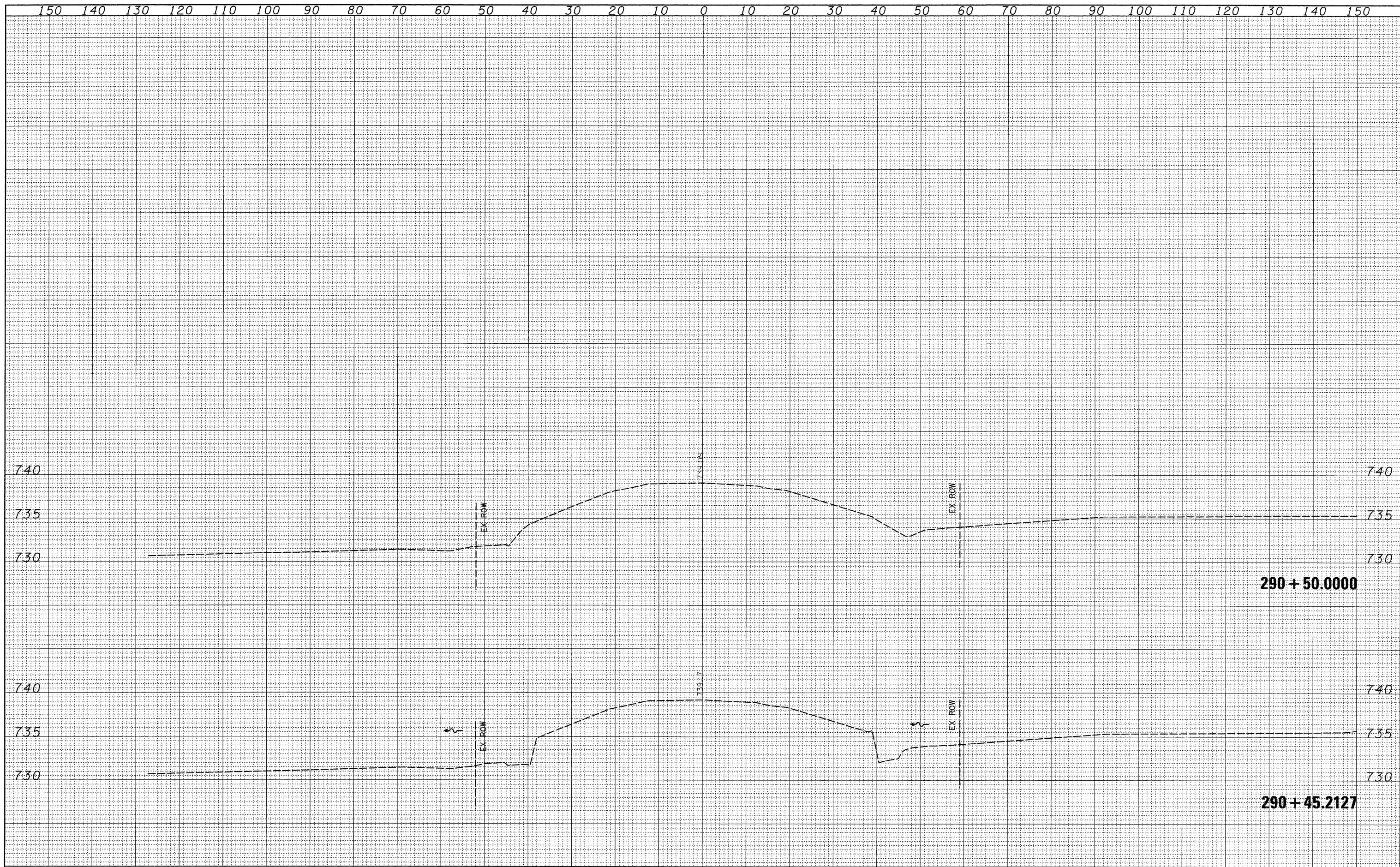

FILE NAME = c:\projects\p201608\d01608.xml.dgn
 USER NAME = dssdd
 PLOT SCALE = 10.0000' / IN.
 PLOT DATE = Wed Jul 30 11:03:54 2008

DESIGNED -	REVISD -
DRAWN -	REVISD -
CHECKED -	REVISD -
DATE -	REVISD -

**STATE OF ILLINOIS
 DEPARTMENT OF TRANSPORTATION**

IL 40

SCALE: SHEET NO. OF SHEETS STA. 290+45.2127 TO STA. 290+50.0000

F.A.P. RTE.	SECTION	COUNTY	TOTAL SHEETS	SHEET NO.
646	5M-1	CARROLL	19	19
CONTRACT NO. 64E50				
FED. ROAD DIST. NO. ILLINOIS FED. AID PROJECT				