

STATE OF ILLINOIS
DEPARTMENT OF PUBLIC WORKS & BUILDINGS
DIVISION OF HIGHWAYS

PROJECT NO.	SECTION	EX. DATE	DATE	SHEET NO.	SHEET NO. OF
4-47 (B119)	Grundy	34	16	7	7
FED. ROAD DIST. NO. 1 ILLINOIS FED. AID PROJECT F-204(5)					

BM. TOP OF NEW M.W. WING - 266.03
B.M. Top of M.W. Wing
Elev 265.00
Existing Structure
R.C. Deck Girders 3 Spans @ 24.5' @ R.L. 0
 roadway 21'-0" on R.C. C/Os over Abutts.
Sup. & Part of Abutts to be removed.
No Salvage.

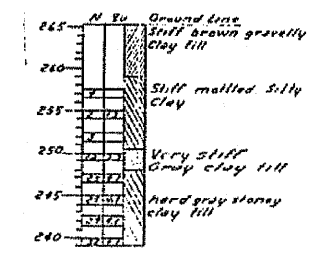
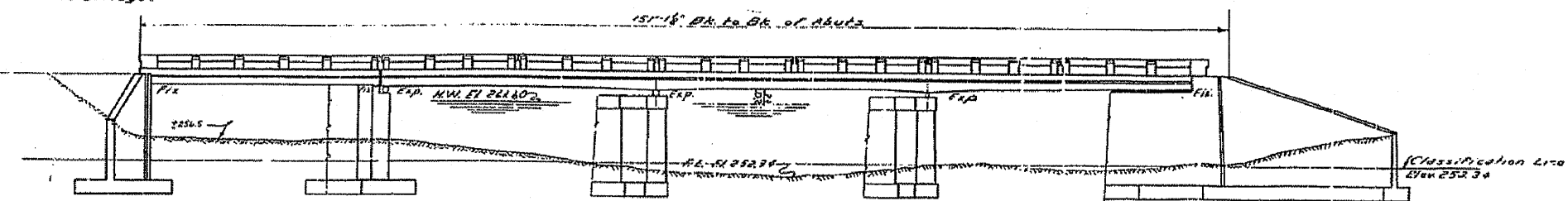

ELEVATION

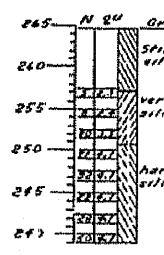
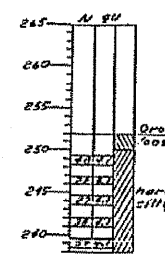
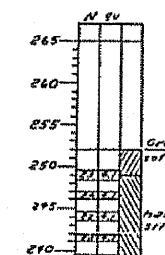
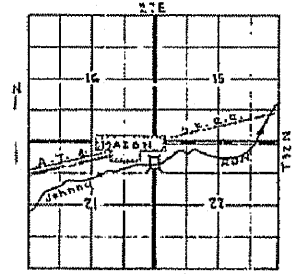

Note: N = Blows per foot of penetration of sampling spoon Hammer Weight 350 lbs.
Drop = 12 inches
qu = Unconfined compressive strength in tons per square foot

GENERAL NOTES

Class X Concrete shall be used throughout except as noted.
Handrail Concrete shall be used in Post & Rails. The Handrails shall not be poured until falsework has been removed.
The Concrete Floor Slab shall be finished in accordance with the applicable provisions of Section 27 of the Standard Specifications.
For Expansion Bolts, see special provisions.
All Rollers, Packers, Bearing Plates, Lead Plates, Pivots & Anchor Bolts shall be fabricated & set in accordance with Article 514 of the Standard Specifications & are included for payment as Structural Steel, Est. We. 610.
Expansion Guards shall be fabricated and erected in accordance with Article 512 (d) of the Standard Specifications & are included for payment as Structural Steel, Est. We. 610.
Except as otherwise provided, 1/2" Structural Steel shall receive one shop coat of red lead paint & two field coats of aluminum paint. See Articles 521 to 525 inclusive of the Standard Specifications. All paint shall be furnished & applied by the Contractor.
For backfill behind Abutments, refer to the Job by Super-structure, see Article 6010 of the Standard Specifications.
Boring Data are shown on the drawings only as a guide to bidders in determining soil conditions which may be encountered in the work.
The following surfaces of the bridge shall be waterproofed: back of Abutments & Back of Wing walls from top of footing to ground line.
No Piles Used in Existing Structure.

STATION 385+20
BUILT 195 BY
STATE OF ILLINOIS
S.B.I. RT. 47 SEC. 119-B-Y
F.A. PROJ. F-204(5)
LOADING H20-516

LETTERING FOR NAME PLATE
See Std. No. 2113

TOTAL BILL OF MATERIAL

ITEM	UNIT	SUPER	SUB	TOTAL
Handrail Concrete	Cu. Yds.	7.2		7.2
Class X Concrete	Cu. Yds.	398.4	302.8	701.2
Reinforcement Bars	Lbs.	94,270	14,920	109,190
Concrete Removal	Cu. Yds.		170	170
Name Plates	Each	one		one
Expansion Bolts	Each		181	181
Structural Steel	Cu. Yds.		525	525
Removal of Existing Superstr.	Each		one	one
Pavement Removal	Sq. Yds.		81	81
Class A Excavation for Strud.	Cu. Yds.		472	472
Class B Excavation for Strud.	Cu. Yds.		471	471
Temporary Bridge Complete	Each		one	one

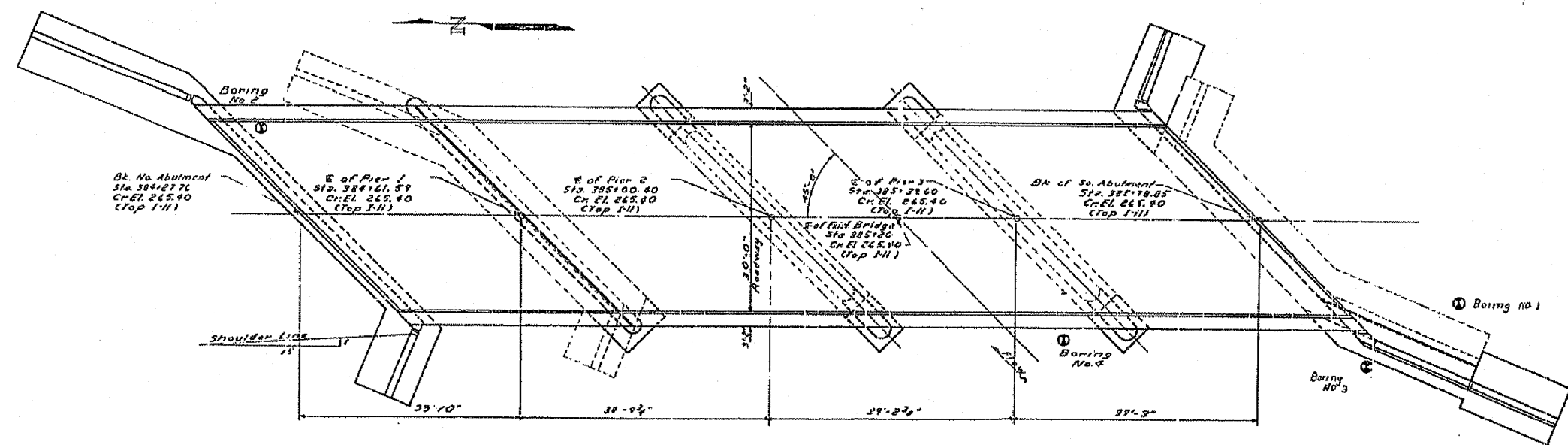

PLAN

WATERWAY INFORMATION

Drainage Area 29,200 acres
Character rolling, cultivated & wooded
Required Opening (30 yr Flood) 811' 0"
Present Opening 681' 0"
Proposed Opening 811' 0"

DESIGNED *David Johnson*
CHECKED *R.F. Elmer*
DRAWN D.S.S. *C. Green*
CHECKED *R.F. Elmer*

EXAMINED *W.B. Hanson*
PASSED *[Signature]*
APPROVED *R.F. Elmer*

STRESSES
fc = 4000 psi (Super)
fc = 3000 psi (Sub)
fs = 20,000 psi (Reinf)
fs = 17,100 psi (Pile)

GENERAL PLAN & ELEVATION
PROJ. F-204(5)
S.B.I. RT. 47 SEC. 119-B-Y
GRUNDY COUNTY
STA. 385+20

FILE NAME = sheets03.dgn	USER NAME = @USER@	DESIGNED -	REVISED -	STATE OF ILLINOIS DEPARTMENT OF TRANSPORTATION	EXISTING BRIDGE PLAN FOR INFORMATION ONLY	F.A.P. RTE. 326	SECTION 119 BR	COUNTY GRUNDY	TOTAL SHEETS 68	SHEET NO. 48
PLOT SCALE = 20,000' / IN.	DRAWN -	REVISED -	SCALE: SHEET NO. OF SHEETS STA. TO STA.			CONTRACT NO. 66687				
PLOT DATE = 8/13/2008	CHECKED -	REVISED -				FED. ROAD DIST. NO. ILLINOIS FED. AID PROJECT				
	DATE -	REVISED -								