

F.A. RTE.	SECTION	COUNTY	TOTAL SHEETS	SHEET NO.
326	119 BR-2	GRUNDY	52	1
FED. ROAD DIST. NO.	ILLINOIS	CONTRACT NO. 66688		

STATE OF ILLINOIS
DEPARTMENT OF TRANSPORTATION
DIVISION OF HIGHWAYS

**PROPOSED
HIGHWAY PLANS**

FAP ROUTE 326 (IL ROUTE 47)
SECTION 119 BR-2
PROJECT ACF-0326 (073)
GRUNDY COUNTY

C - 93 - 009 - 07

IL ROUTE 47 OVER THE WEST FORK OF THE MAZON RIVER
REPLACEMENT OF EXISTING BRIDGE.

INDEX OF SHEETS

SHEET NO.	ITEM
1	COVER SHEET
2	GENERAL NOTES, COMMITMENTS & HIGHWAY STANDARDS
3	SUMMARY OF QUANTITIES
4	TYPICAL SECTIONS
5	SCHEDULE OF QUANTITIES
6-7	PLAN & PROFILE SHEETS
8-13	STAGE CONSTRUCTION & TRAFFIC CONTROL
14	EROSION CONTROL & PAVEMENT MARKING PLANS
15-16	EXISTING R.O.W. PLANS
17-40	STRUCTURE PLANS & STRUCTURE BORINGS
41-45	EXISTING STRUCTURE PLANS
46-48	MISCELLANEOUS DETAILS
49-52	CROSS SECTIONS

MICROFILMED _____
REEL NUMBER _____
AWARDED _____
RESIDENT ENGINEER _____
AS BUILT CHANGES WERE MADE
ON THE FOLLOWING SHEETS _____

PROJECT INCLUDES A 2-SPAN CONTINUOUS
WIDE FLANGE STRUCTURE WITH A COMPOSITE
DECK, INTEGRAL ABUTMENTS AND PILE
BENT PIERS - S.N. 032-0116. BEGIN BRIDGE
STA. 465+37.00 AND END BRIDGE STA.
466+77.00. SOUTH SPAN 70'-0" AND NORTH
SPAN 70'-0".

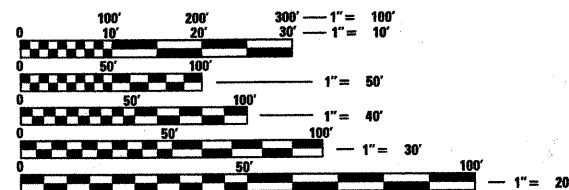

FULL SIZE PLANS HAVE BEEN PREPARED USING STANDARD
ENGINEERING SCALES. REDUCED SIZED PLANS WILL NOT
CONFORM TO STANDARD SCALES. IN MAKING MEASUREMENTS
ON REDUCED PLANS, THE ABOVE SCALES MAY BE USED.

J.U.L.I.E.
JOINT UTILITY LOCATION INFORMATION FOR EXCAVATION
1-800-892-0123
OR 811

DISTRICT 3 NO. (815) 434-6131
PROJECT ENGINEER: DAVE BROVIAK
PROJECT MANAGER: SCOTT FERGUSON
CONTRACT NO. 66688

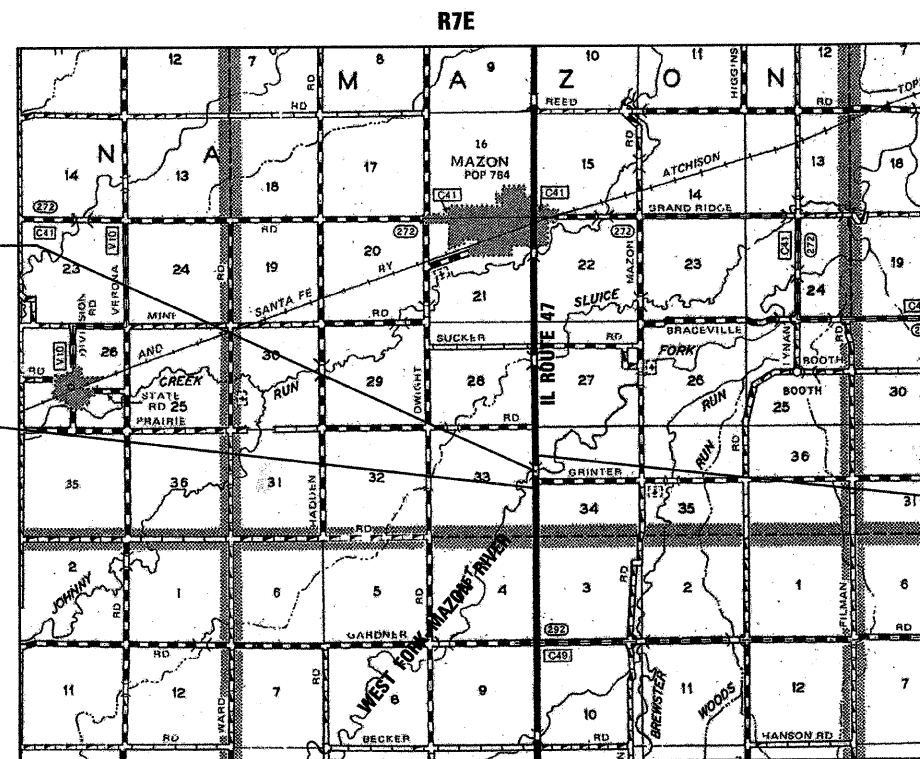

LOCATION MAP



GROSS LENGTH = 790.00 FT. = 0.15 MI.
NET LENGTH = 790.00 FT. = 0.15 MI.

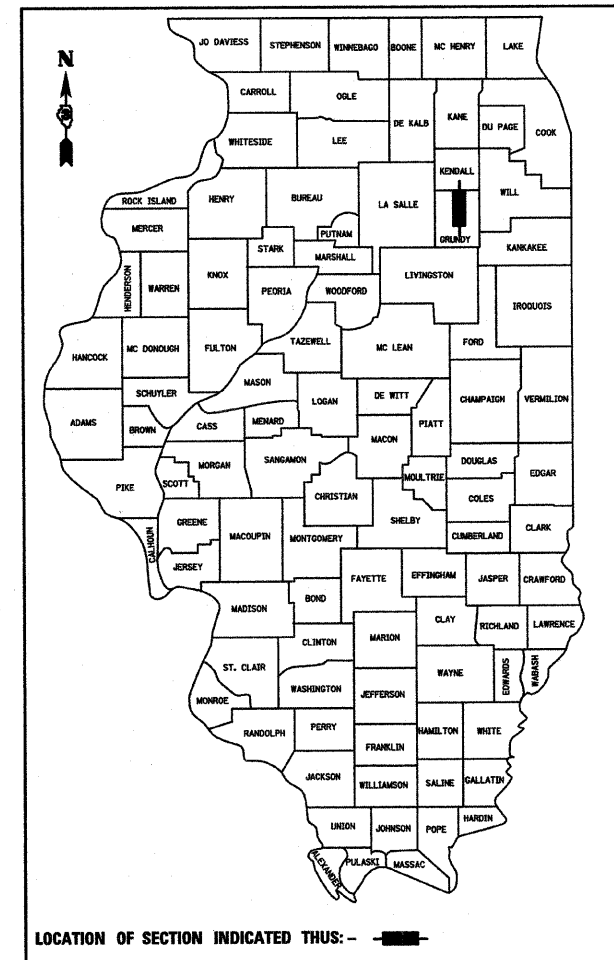

LOCATION OF SECTION INDICATED THUS: -

FUNCTIONAL CLASSIFICATION
OTHER PRINCIPAL ARTERIAL - F.A.P. 326 (IL RTE. 47)
ADT 4950 (2009)
PV = 79.3%
SU = 4.6%
MU = 16.1%

END PROJECT
STA. 470+06.00



Jeffrey R. Rensing
DATE 8/8/2008

STATE OF ILLINOIS
DEPARTMENT OF TRANSPORTATION
DIVISION OF HIGHWAYS
SUBMITTED 08/14 20 08
Deputy Director of Highways, Region Engineer
October 3, 20 08
Eric E. Harrel
Interim ENGINEER OF DESIGN AND ENVIRONMENT
October 3, 20 08
Christine M. Reed
DIRECTOR OF HIGHWAYS, CHIEF ENGINEER

**PRINTED BY THE AUTHORITY
OF THE STATE OF ILLINOIS**