

STATE OF ILLINOIS  
DEPARTMENT OF TRANSPORTATION

ROUTE NO.	SECTION	COUNTY	TOTAL SHEETS	SHEET NO.	SHEET NO. 11 32 SHEETS
F.A.I. 80	14BR & 14BR-1	BUREAU	219	83	
FED. ROAD DIST. NO. 7		ILLINOIS	FED. AID PROJECT-		

Contract No. 66731

NORTH CURB LINE

Location	Station	Offset	Theoretical Grade Elevations
W. End of W. Appr.	39907.07	-22.00	602.71
A	39917.07	-22.00	602.86
B	39927.07	-22.00	603.02
Back of W. Abut.	39937.07	-22.00	603.18

NORTH EDGE OF PAVEMENT

Location	Station	Offset	Theoretical Grade Elevations
W. End of W. Appr.	39907.07	-12.00	602.92
A	39917.07	-12.00	603.07
B	39927.07	-12.00	603.23
Back of W. Abut.	39937.07	-12.00	603.39

☉ ROADWAY & PROFILE GRADE

Location	Station	Offset	Theoretical Grade Elevations
W. End of W. Appr.	39907.07	0.00	603.10
A	39917.07	0.00	603.26
B	39927.07	0.00	603.41
Back of W. Abut.	39937.07	0.00	603.58

SOUTH EDGE OF PAVEMENT

Location	Station	Offset	Theoretical Grade Elevations
W. End of W. Appr.	39907.07	12.00	602.92
A	39917.07	12.00	603.07
B	39927.07	12.00	603.23
Back of W. Abut.	39937.07	12.00	603.39

SOUTH CURB LINE

Location	Station	Offset	Theoretical Grade Elevations
W. End of W. Appr.	39907.07	18.00	602.79
A	39917.07	18.00	602.94
B	39927.07	18.00	603.10
Back of W. Abut.	39937.07	18.00	603.27

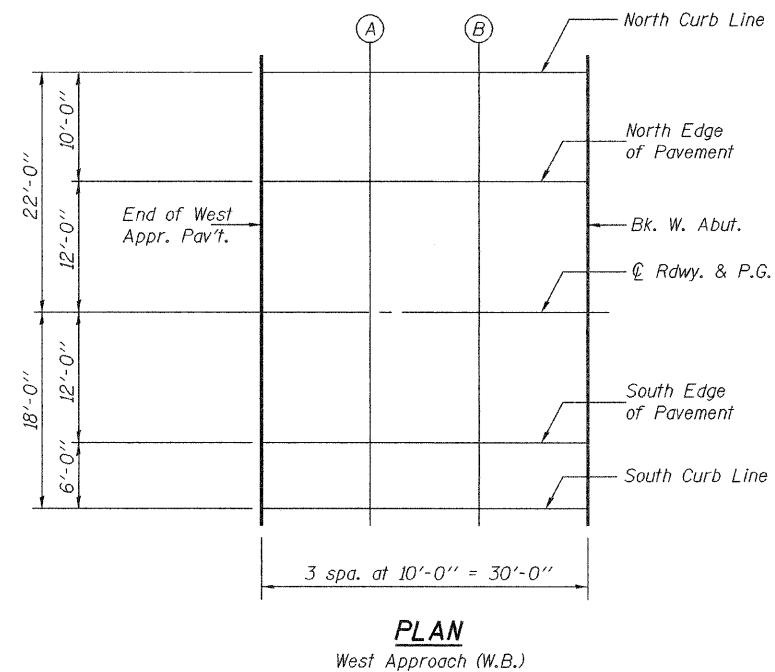

DESIGNED	Nicholas R. Barnett
CHECKED	Ray Ahanchi
DRAWN	h.t. duong
CHECKED	NRB/GRA

EXAMINED	Thomas J. Romagallo ENGINEER OF BRIDGE DESIGN
PASSED	Ralph E. Anderson ENGINEER OF BRIDGES AND STRUCTURES

TOP OF WEST APPROACH  
PAVEMENT ELEVATIONS (W.B.)  
F.A.I. RTE. 80 - SEC. 14BR & 14BR-1  
BUREAU COUNTY  
STATION 400+22.07  
STRUCTURE NO. 006-0165 (E.B.)  
STRUCTURE NO. 006-0166 (W.B.)