

Bench Mark: Top of SE wingwall of S.N. 006-0036, Sta. 414+27.50, 53' right. Elevation 637.63.

Existing Structures: S.N. 006-0036 (E.B.) built in 1957 as F.A.P. Route 154, Section 14-VB-1.
S.N. 006-0037 (W.B.) built in 1958 as F.A.I. Route 6, Section 6-14-VB-3. Each structure consists of a three span reinforced concrete deck on continuous wide flange steel beams supported by pile bent spill thru abutments and multi-column piers. 167'-2" back-to-back abutments. 35'-8" out-to-out deck. Existing structures to be removed and replaced using cross overs.

No Salvage.

STATE OF ILLINOIS
DEPARTMENT OF TRANSPORTATION

ROUTE NO.	SECTION	COUNTY	TOTAL SHEETS	SHEET NO.	SHEET NO. 1
F.A.I. 80	14VBR-2 & 14VBR-3	BUREAU	219	105	35 SHEETS
FED. ROAD DIST. NO. 7		ILLINOIS	FED. AID PROJECT-		

Contract No. 66731

INDEX OF SHEETS

- 1 General Plan & Elevation
- 2 General Data
- 3 Footing Layout
- 4-8 Top of Slab Elevations
- 9 Top of West Approach Pavement Elevation (E.B.)
- 10 Top of East Approach Pavement Elevation (E.B.)
- 11 Top of West Approach Pavement Elevation (W.B.)
- 12 Top of East Approach Pavement Elevation (W.B.)
- 13 Superstructure (E.B.)
- 14 Superstructure (W.B.)
- 15 Superstructure Details
- 16 Diaphragm Details
- 17 Structural Steel
- 18 Structural Steel Details
- 19 Bearing Details
- 20 West Abutment (E.B.)
- 21 East Abutment (E.B.)
- 22 West Abutment (W.B.)
- 23 East Abutment (W.B.)
- 24 Pier 1 (E.B.)
- 25 Pier 2 (E.B.)
- 26 Pier 1 (W.B.)
- 27 Pier 2 (W.B.)
- 28 Bar Splicer Assembly Details
- 29 Steel H-Pile Details
- 30 Concrete Parapet Slipforming Option
- 31 Cantilever Forming Brackets for Superstructures with W27 Beams and Smaller
- 32-35 Boring Logs

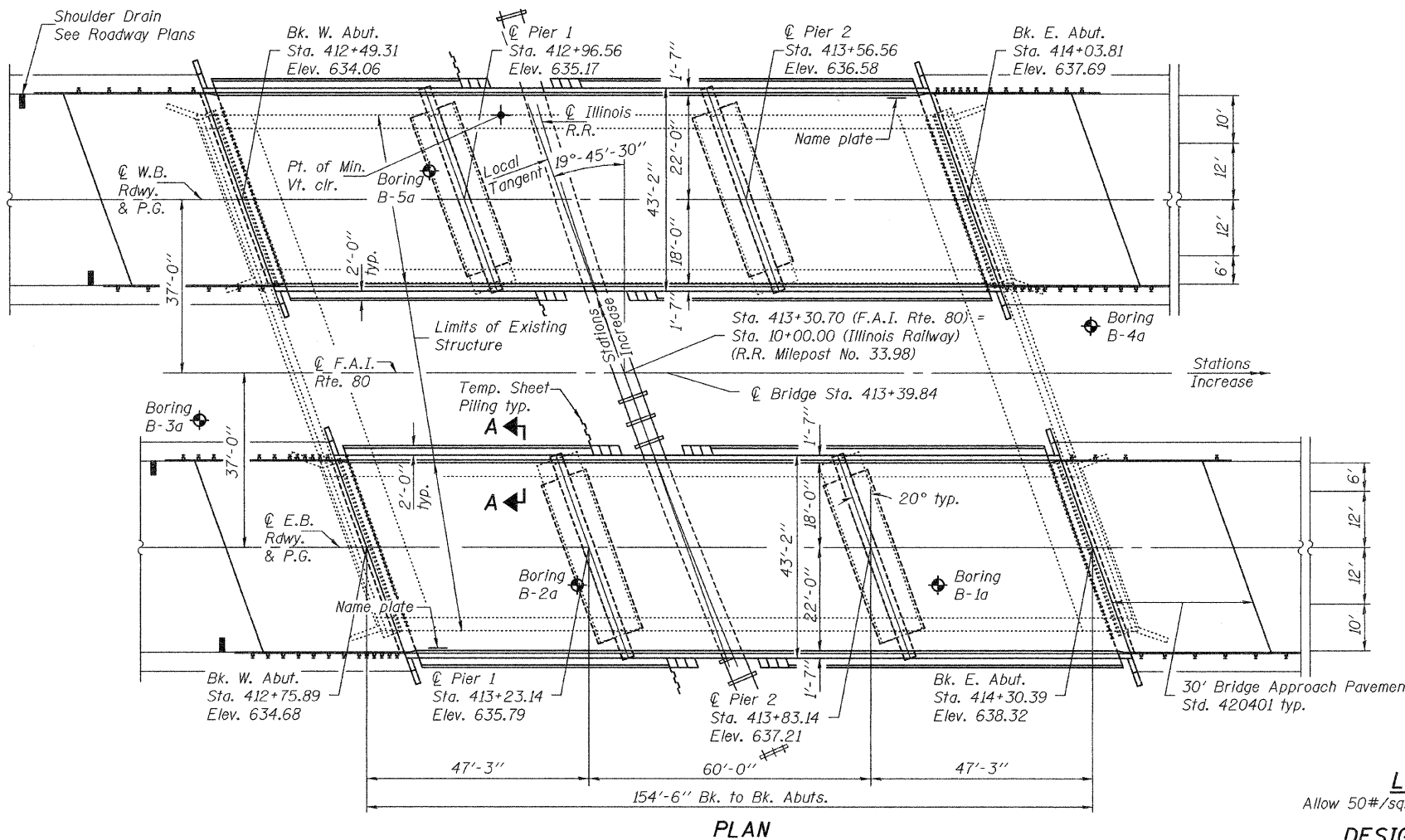
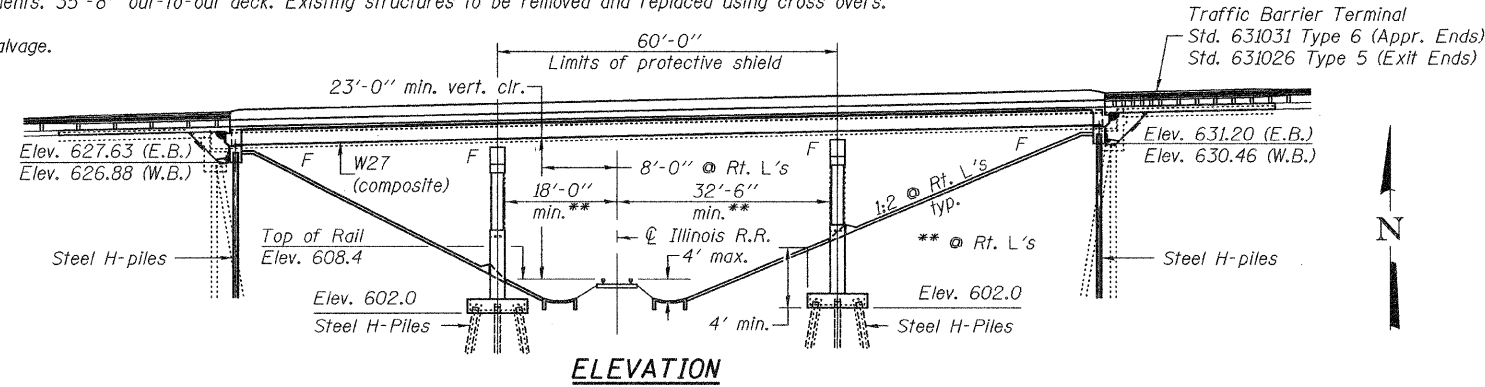

STATION 413+39.84
BUILT 20 BY
STATE OF ILLINOIS
F.A.I. RTE. 80 SEC. 14VBR-2 & 14VBR-3
LOADING HL-93
STRUCTURE NO. 006-0167 (E.B.)

STATION 413+39.84
BUILT 20 BY
STATE OF ILLINOIS
F.A.I. RTE. 80 SEC. 14VBR-2 & 14VBR-3
LOADING HL-93
STRUCTURE NO. 006-0168 (W.B.)

NAME PLATE
See Std. 515001

CURVE DATA

(@ Illinois R.R.)
PI Sta. = 10+00.00
 $\Delta = 26^\circ-57'-11''$
 $D = 4^\circ-58'-32''$
 $R = 1151.56'$
 $T = 275.97'$
 $L = 541.72'$
 $E = 32.61'$
P.C. Sta. = 7+24.03
P.T. Sta. = 12+65.75

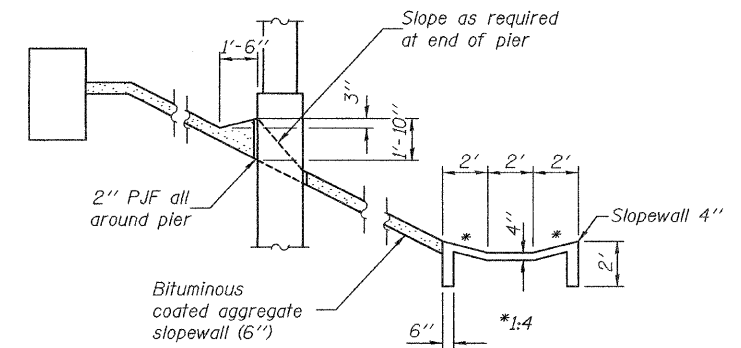
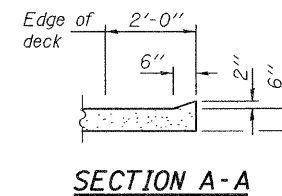

SECTION THRU SLOPEWALL
(Horiz. dim. @ Rt. L's)

LOADING HL-93

Allow 50#/sq. ft. for future wearing surface.

DESIGN SPECIFICATIONS
2007 AASHTO LRFD

DESIGN STRESSES

FIELD UNITS

$f'_c = 3,500$ psi
 $f_y = 60,000$ psi (reinforcement)
 $f_y = 50,000$ psi (AASHTO M270 Grade 50W)

SEISMIC DATA

Seismic Performance Zone (SPZ) = 1
Bedrock Acceleration Coefficient (A) = 3.8%g
Site Coefficient (S) = 1.0

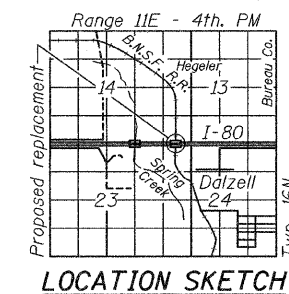

GENERAL PLAN & ELEVATION
I-80 OVER ILLINOIS RAILWAY
F.A.I. RTE. 80 - SEC. 14VBR-2 & 14VBR-3
DOT/ARR NO. 0652734
BUREAU COUNTY
STATION 413+39.84
STRUCTURE NO. 006-0167 (E.B.)
STRUCTURE NO. 006-0168 (W.B.)

DESIGNED	<i>Nicholas R. B...</i>
CHECKED	<i>...</i>
DRAWN	h.t. duong
CHECKED	NRB/GAA

EXAMINED *...*
PASSED *...*
ENGINEER OF BRIDGE DESIGN
ENGINEER OF BRIDGES AND STRUCTURES



EXPIRES 11-30-2008

