

F.A.P. RTE.	SECTION	COUNTY	TOTAL SHEETS	SHEET NO.
22	135W-2; RS-5	FULTON	282	40
STA.		TO STA.		
FED. ROAD DIST. NO.		ILLINOIS FED. AID PROJECT		

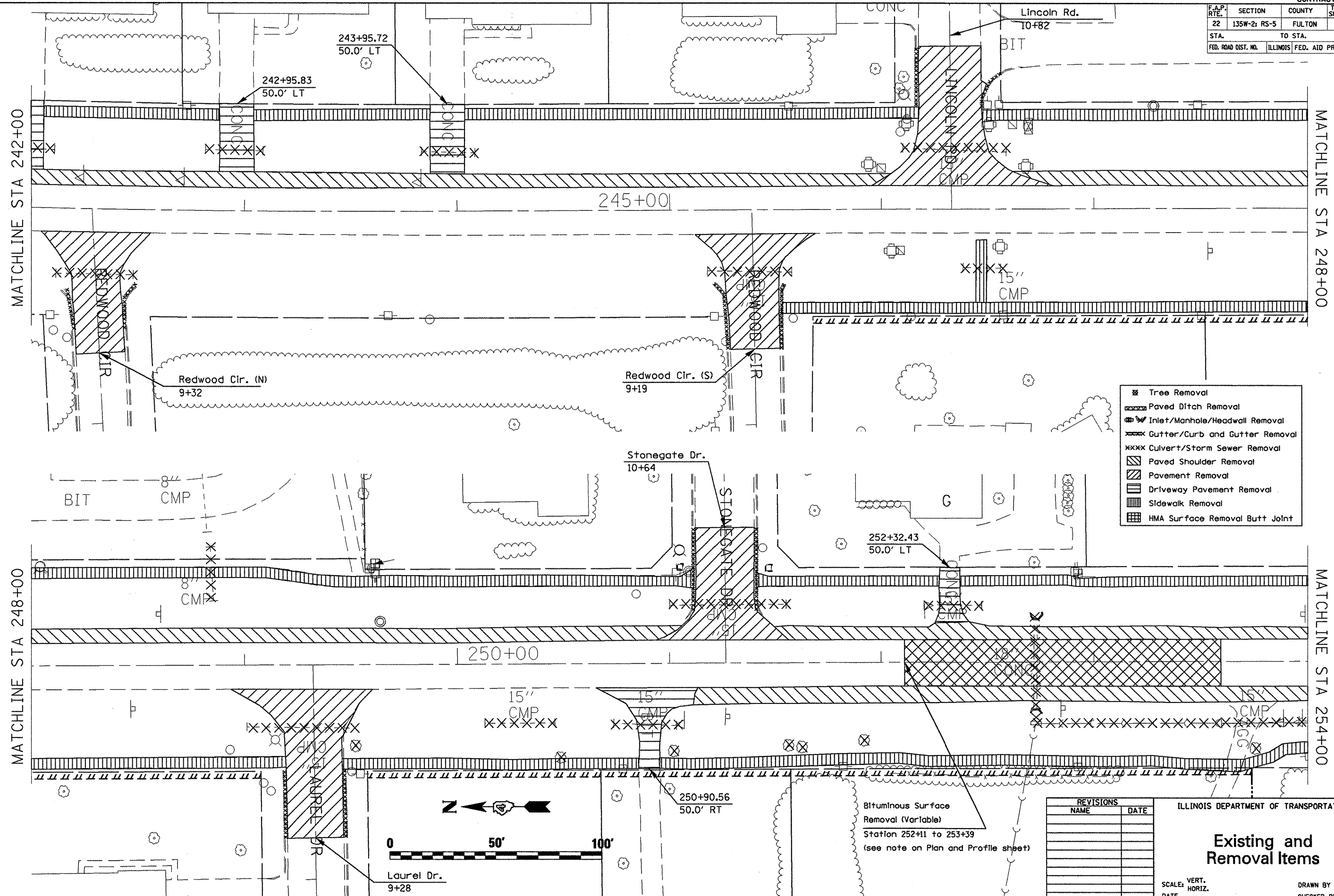

- Tree Removal
- Paved Ditch Removal
- Inlet/Manhole/Headwall Removal
- Gutter/Curb and Gutter Removal
- Culvert/Storm Sewer Removal
- Paved Shoulder Removal
- Pavement Removal
- Driveway Pavement Removal
- Sidewalk Removal
- HMA Surface Removal Butt Joint

REVISIONS	
NAME	DATE

ILLINOIS DEPARTMENT OF TRANSPORTATION

### Existing and Removal Items

SCALE: VERT. \_\_\_\_\_  
HORIZ. \_\_\_\_\_

DATE \_\_\_\_\_

DRAWN BY \_\_\_\_\_  
CHECKED BY \_\_\_\_\_

Bituminous Surface Removal (Variable)  
Station 252+11 to 253+39  
(see note on Plan and Profile sheet)

PLOT DATE = 8/16/2008  
FILE NAME = o:\p\ros\mca\17\Bourton\general2.dgn  
PLOT SCALE = 42.4874' / IN.  
REFERENCE = #REF#