

ROUTE NO.	SECTION	COUNTY	TOTAL SHEETS	SHEET NO.	SHEET NO. 4
F.A.S. 2370 (IL. 26)	1-BR	PUTNAM	65	21	31 SHEETS
FED. ROAD DIST. NO. 7	ILLINOIS	FED. AID PROJECT			

Contract # 68577

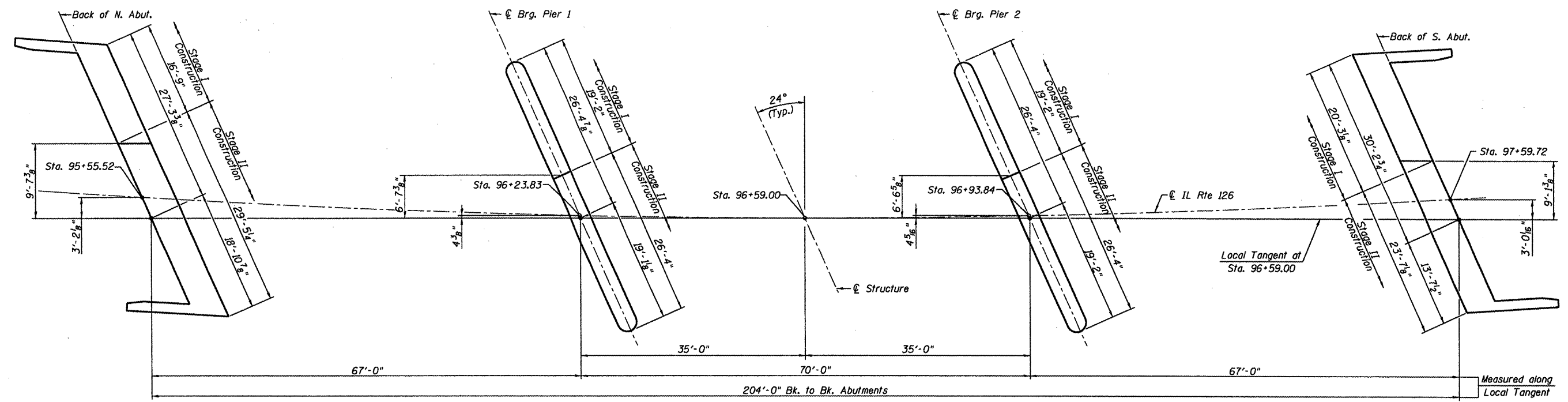

PROPOSED STRUCTURE FOOTING PLAN

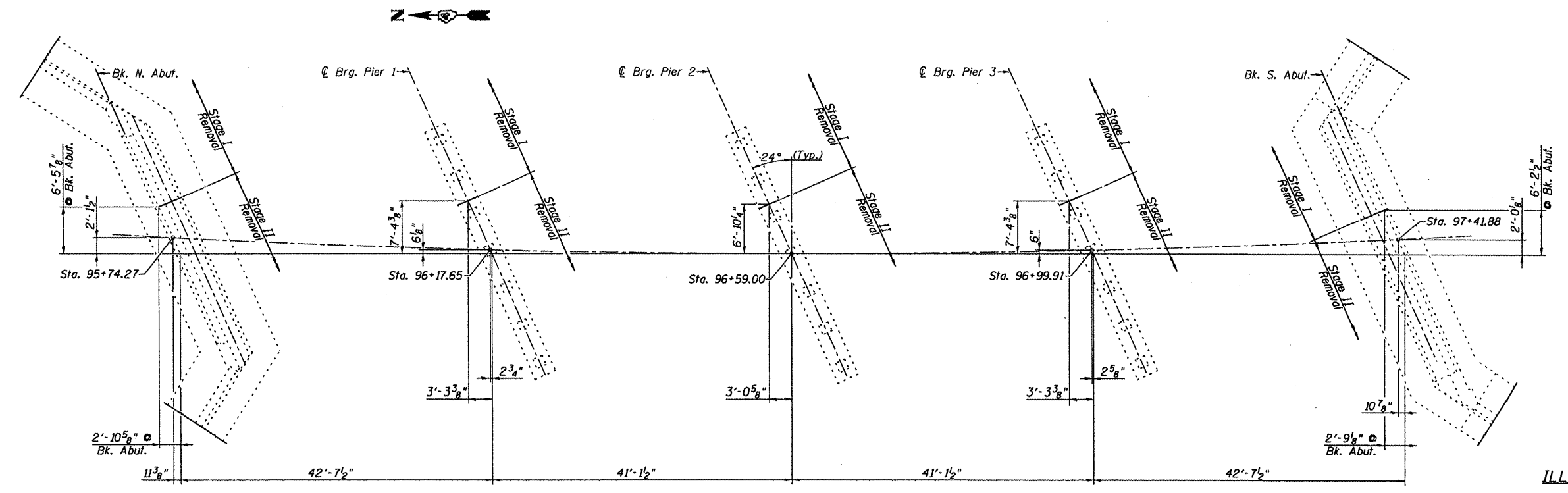

EXISTING STRUCTURE FOOTING PLAN

FOOTING LAYOUT
ILLINOIS ROUTE 26 OVER
COFFEE CREEK
F.A.S. ROUTE 2370
SECTION 1-BR
PUTNAM COUNTY
STA. 96+59.00
STRUCTURE NO. 078-0046

Note: For Offset Sketch of Proposed Structure see Sheet 2 of 31.