

SEC. 35, T. 16 N., R. 8 E., 3RD P.M.

CONTRACT NO. 70465

F.A.I. RTE.	SECTION	COUNTY	TOTAL SHEETS	SHEET NO.
57	*	DOUGLAS	76	46
STA. 527+00		TO STA. 559+00		
FED. ROAD DIST. NO.		ILLINOIS FED. AID PROJECT		
* (15,21-25,21-26,27)RS-1				



LEGEND	
	HMA SURFACE REMOVAL - 3/4"
	HMA SURFACE REMOVAL - BUTT JOINT FOR DETAIL, SEE SHEET(S) 63&64

SECTION (15,21-25,21-26,27)RS-1
ENDS STATION 547+00.00

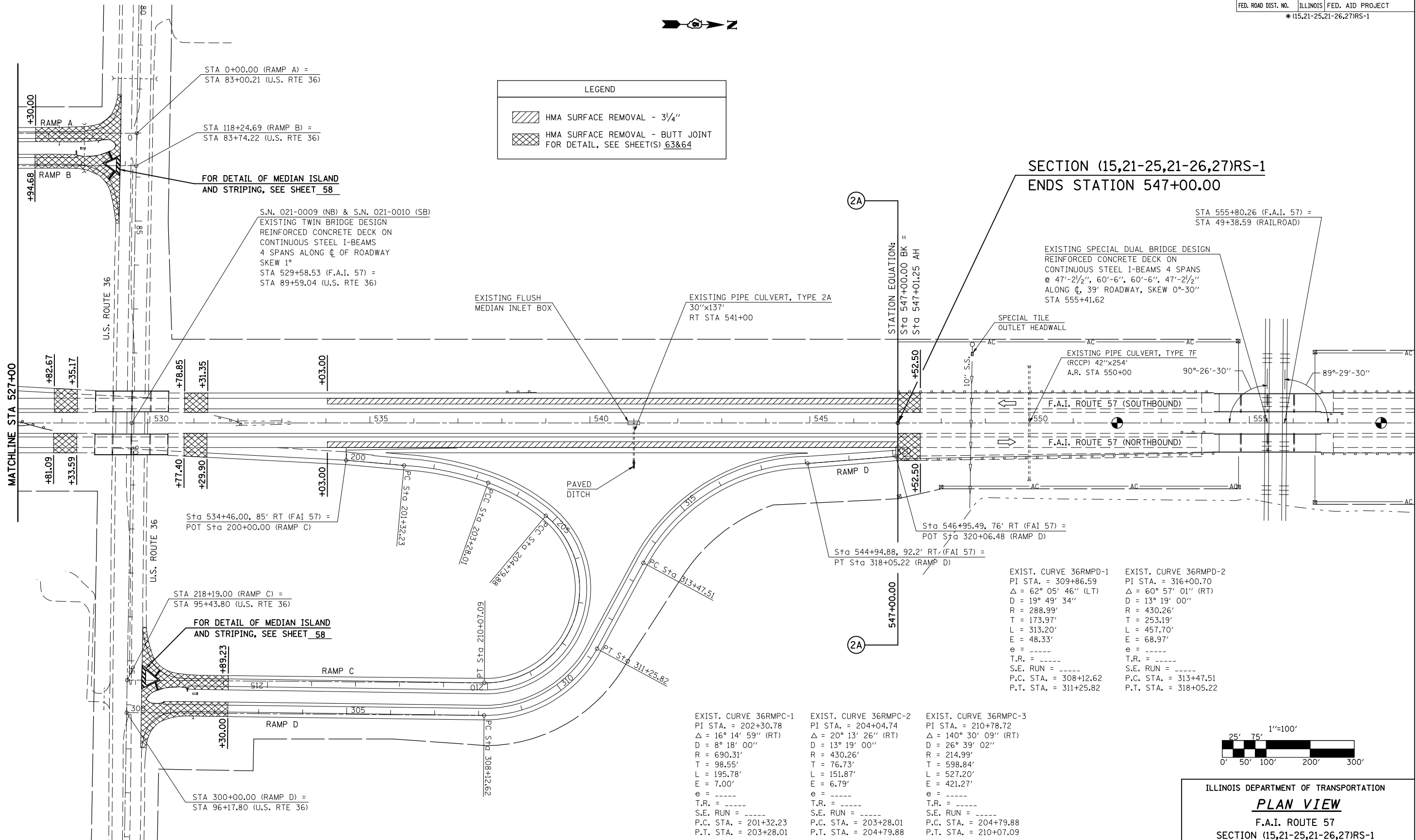

EXIST. CURVE 36RMPD-1 PI STA. = 309+86.59 $\Delta = 62^\circ 05' 46''$ (LT) D = 19° 49' 34" R = 288.99' T = 173.97' L = 313.20' E = 48.33' e = ---- T.R. = ---- S.E. RUN = ---- P.C. STA. = 308+12.62 P.T. STA. = 311+25.82	EXIST. CURVE 36RMPD-2 PI STA. = 316+00.70 $\Delta = 60^\circ 57' 01''$ (RT) D = 13° 19' 00" R = 430.26' T = 253.19' L = 457.70' E = 68.97' e = ---- T.R. = ---- S.E. RUN = ---- P.C. STA. = 313+47.51 P.T. STA. = 318+05.22
---	---

EXIST. CURVE 36RMPD-1 PI STA. = 202+30.78 $\Delta = 16^\circ 14' 59''$ (RT) D = 8° 18' 00" R = 690.31' T = 98.55' L = 195.78' E = 7.00' e = ---- T.R. = ---- S.E. RUN = ---- P.C. STA. = 201+32.23 P.T. STA. = 203+28.01	EXIST. CURVE 36RMPD-2 PI STA. = 204+04.74 $\Delta = 20^\circ 13' 26''$ (RT) D = 13° 19' 00" R = 430.26' T = 76.73' L = 151.87' E = 6.79' e = ---- T.R. = ---- S.E. RUN = ---- P.C. STA. = 203+28.01 P.T. STA. = 204+79.88	EXIST. CURVE 36RMPD-3 PI STA. = 210+78.72 $\Delta = 140^\circ 30' 09''$ (RT) D = 26° 39' 02" R = 214.99' T = 598.84' L = 527.20' E = 421.27' e = ---- T.R. = ---- S.E. RUN = ---- P.C. STA. = 204+79.88 P.T. STA. = 210+07.09
--	---	---

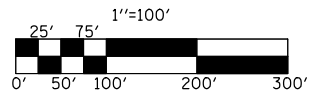

ILLINOIS DEPARTMENT OF TRANSPORTATION
PLAN VIEW
 F.A.I. ROUTE 57
 SECTION (15,21-25,21-26,27)RS-1
 DOUGLAS COUNTY

SCALE: 1" = 100'
 DATE: 01/19/06
 DRAWN BY: J.P.
 CHECKED BY: K.D.

SEC. 35, T. 16 N., R. 8 E., 3RD P.M.

PLOT DATE = 8/21/2008
 FILE NAME = c:\p\projects\0801305 (v8)\100plan\shs.dgn
 PLOT SCALE = 211.7647 / IN.
 USER NAME = sheehyjm