

F.A.I. RTE.	SECTION	COUNTY	TOTAL SHEETS	SHEET NO.
57	*	DOUGLAS	76	56

\*(15,21-25,21-26,27)RS-1

# SLOPE WALL REPAIR

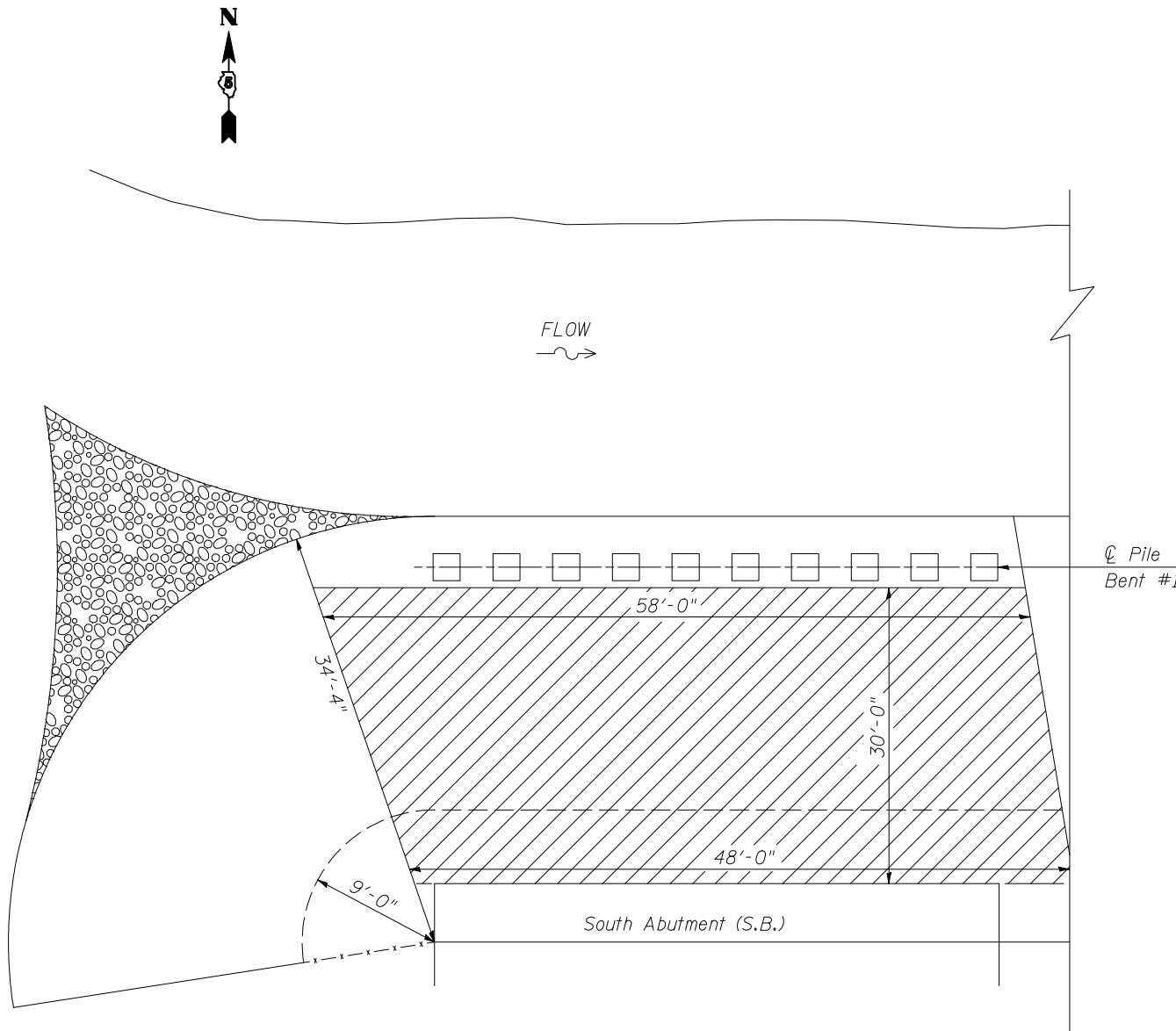

**SLOPE WALL REPAIR LOCATION**  
**S.N. 021-0008 SOUTH ABUTMENT**

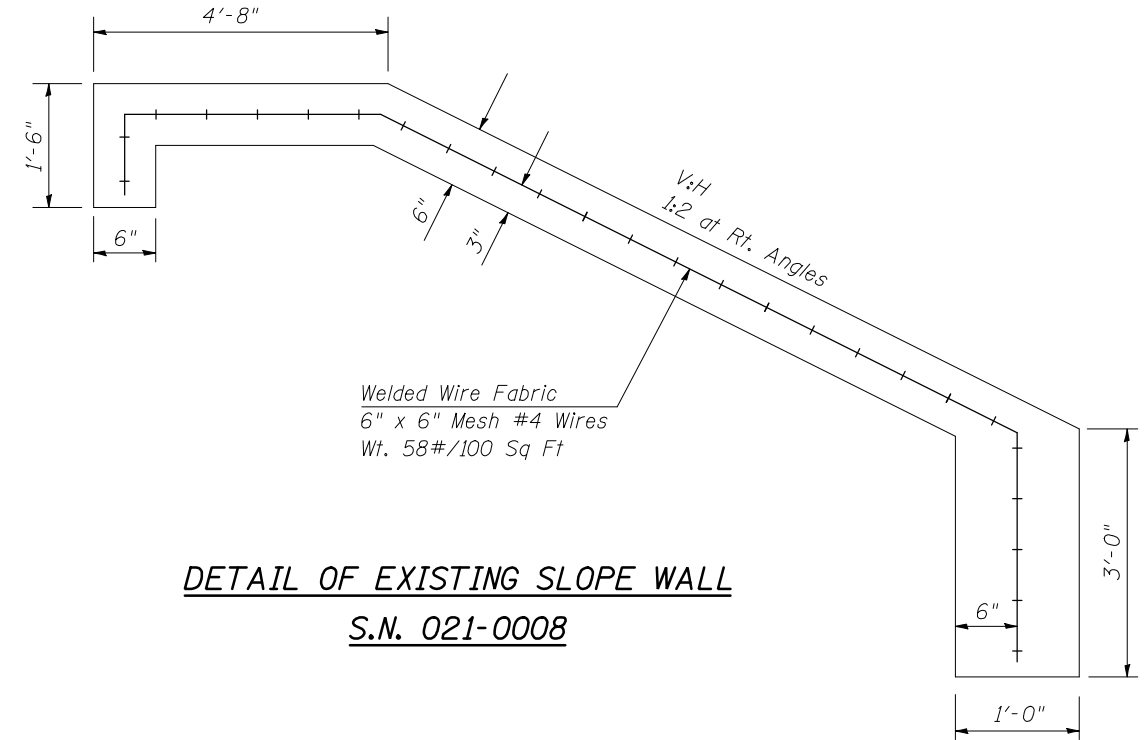

**DETAIL OF EXISTING SLOPE WALL**  
**S.N. 021-0008**

 Area of Slope Wall Breaking and Placement of Stone Riprap, Class A4

F.A.I. 57 OVER SCATTERING FORK  
SECTION 21-27B-2  
DOUGLAS COUNTY  
S.N. 021-0008 S.B.

SHEET 2 OF 2

ILLINOIS DEPARTMENT OF TRANSPORTATION

**SLOPE WALL REPAIR**

F.A.I. ROUTE 57  
SECTION (15,21-25,21-26,27)RS-1  
DOUGLAS COUNTY

SCALE: NOT TO SCALE  
DATE: 03/12/08

DRAWN BY: J.P.  
CHECKED BY: K.D.