

**STAGE II TRAFFIC**

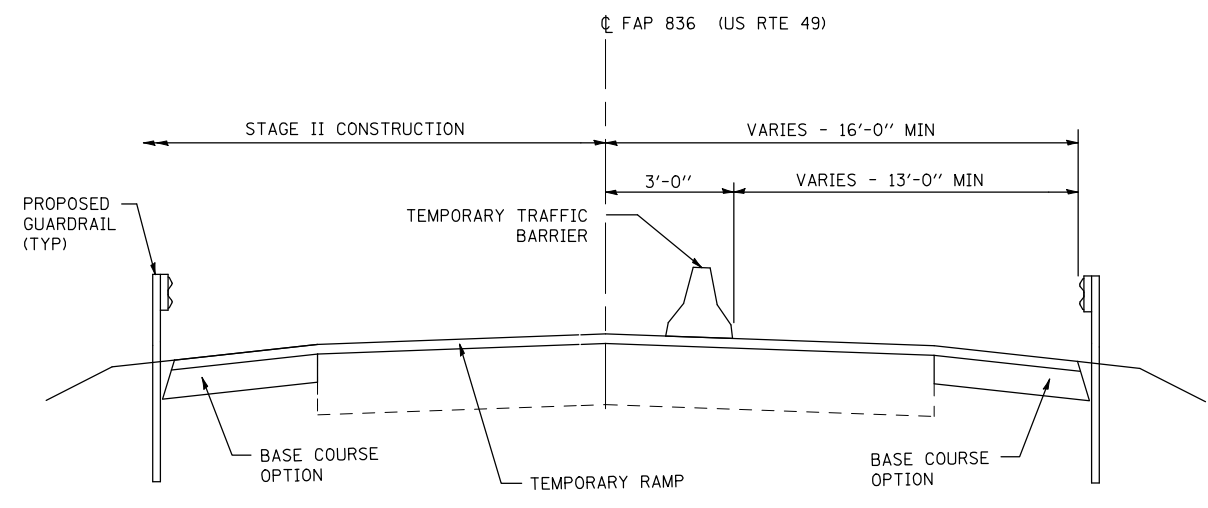

**SECTION B-B**

WORK THIS SHEET WITH SHEET 10 OF 45



|   |                                  |                      |           |   |  |           |           |             |                |   |              |           |
|---|----------------------------------|----------------------|-----------|---|--|-----------|-----------|-------------|----------------|---|--------------|-----------|
| FILE NAME =<br>...roadway\lvr_toplan_stg2.2.dgn | USER NAME = #USER#               | DESIGNED -           | REVISED - | <b>STATE OF ILLINOIS<br/>DEPARTMENT OF TRANSPORTATION</b> | <b>TRAFFIC CONTROL PLAN - STAGE II<br/>ILLINOIS ROUTE 49 OVER LITTLE VERMILION RIVER</b> |           |           | F.A.P. RTE. | SECTION        | COUNTY  | TOTAL SHEETS | SHEET NO. |
|   | THE UPCHURCH GROUP, INC.         | PLOT SCALE = #SCALE# | DRAWN -   |   |  |           |           | REVISED -   | 836            | 118BR-2   | CHAMPAIGN    | 45        |
|   | PLOT DATE = 8/19/2008 3:09:37 PM | CHECKED -            | REVISED - |   | SCALE: 1"=20'  | SHEET NO. | OF SHEETS | STA. 689+00 | TO STA. 694+00 | FED. ROAD DIST. NO. 5 ILLINOIS FED. AID PROJECT |              |           |
|   |                                  | DATE -               | REVISED - |   |  |           |           |             |                | CONTRACT NO. 70600                              |              |           |