

# TRAFFIC SIGNAL MODERNIZATION

F.A.P. 730 U.S. 51 (MAIN ST.)

&  
EMERSON STREET

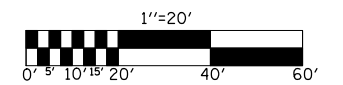

## SIGNAL LAYOUT

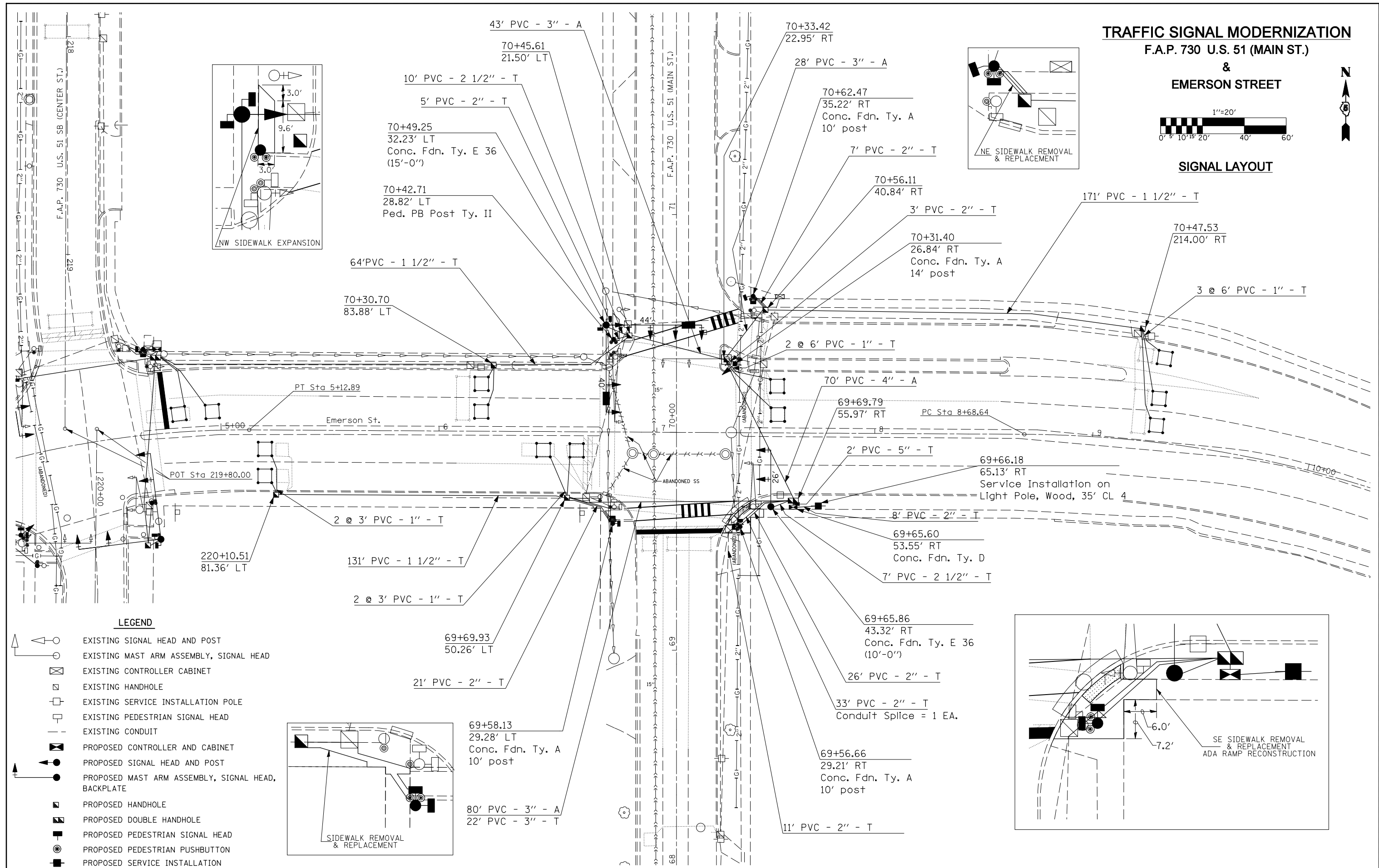

### LEGEND

- EXISTING SIGNAL HEAD AND POST
- EXISTING MAST ARM ASSEMBLY, SIGNAL HEAD
- EXISTING CONTROLLER CABINET
- EXISTING HANDHOLE
- EXISTING SERVICE INSTALLATION POLE
- EXISTING PEDESTRIAN SIGNAL HEAD
- EXISTING CONDUIT
- PROPOSED CONTROLLER AND CABINET
- PROPOSED SIGNAL HEAD AND POST
- PROPOSED MAST ARM ASSEMBLY, SIGNAL HEAD, BACKPLATE
- PROPOSED HANDHOLE
- PROPOSED DOUBLE HANDHOLE
- PROPOSED PEDESTRIAN SIGNAL HEAD
- PROPOSED PEDESTRIAN PUSHBUTTON
- PROPOSED SERVICE INSTALLATION

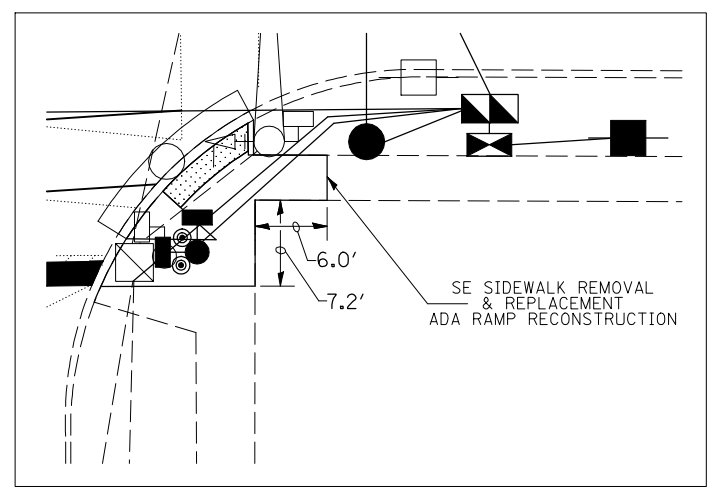
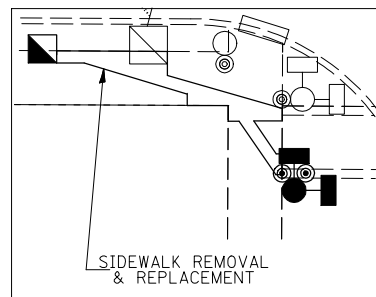

FILE NAME =	USER NAME = biggersd	DESIGNED - RDB	REVISED -
ct:\projects\0570730\emerson_street.dgn		DRAWN - RDB	REVISED -
		CHECKED -	REVISED -
		DATE -	REVISED -

STATE OF ILLINOIS  
DEPARTMENT OF TRANSPORTATION

SCALE: SHEET NO. OF SHEETS STA. TO STA.

F.A. RTE.	SECTION	COUNTY	TOTAL SHEETS	SHEET NO.
730	(8CS15)(62Z)TS(62Z-2)TS	MCLEAN	14	8
FED. ROAD DIST. NO. ILLINOIS FED. AID PROJECT			CONTRACT NO. 70730	