

F.A.P. RTE.	SECTION	COUNTY	TOTAL SHEETS	SHEET NO.
609	***	ST. CLAIR	350	37
STA. 10+00		TO STA. 14+00		
FED. ROAD DIST. NO. ILLINOIS FED. AID PROJECT				
*** 76RS-3, 76-2BR-21				

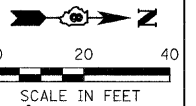

DESIGN	INT.	DATE	REASON

PLAN	NO.	DATE	REASON

CHECKS	INT.	DATE	REASON

PROFILE	NO.	DATE	REASON

CHECKS	INT.	DATE	REASON

**NOTES**  
 1. ALL ENTRANCE WIDTHS ARE 12'-0" UNLESS OTHERWISE NOTED.

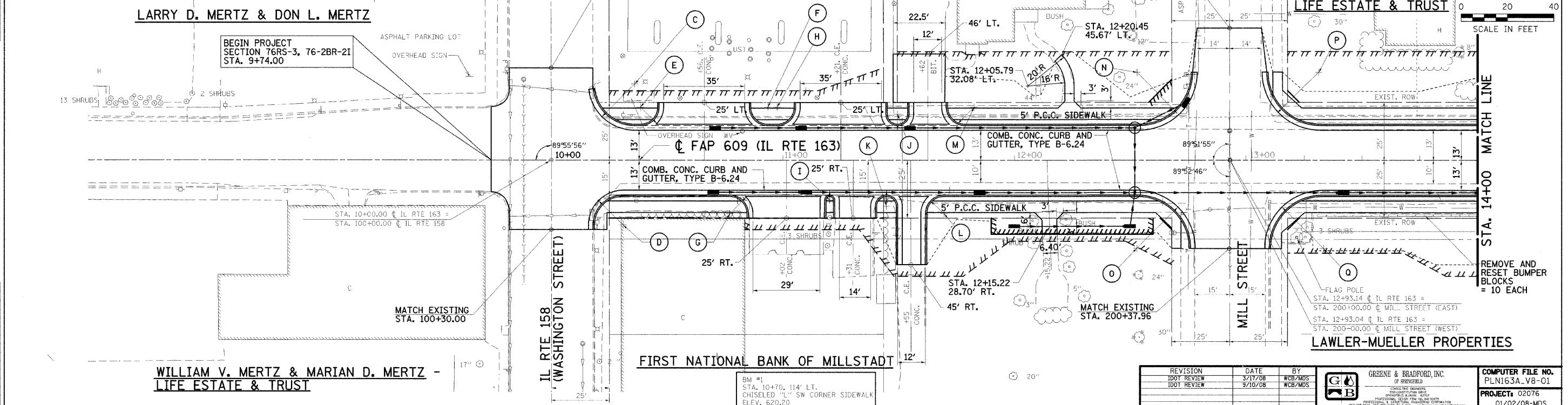

REVISION	DATE	BY	COMPUTER FILE NO.
100% REVIEW	3/17/08	WCB/MDS	PLN163A_V8-01
100% REVIEW	9/10/08	WCB/MDS	PROJECT: 02076
			01/02/08-MDS

STATION	EXISTING GROUND	PROP. PROFILE GRADE	STATION
630			630
625			625
620			620
615			615
610	(F) STA. 10+93.50, 23.00' LT, R=10'	(K) STA. 11+44.76, 19.85' RT, R=7'	(P) STA. 13+31.32, 38.00' LT, R=25'
605	(G) STA. 10+77.07, 23.00' RT, R=10'	(L) STA. 11+69.61, 23.00' RT, R=8'	(Q) STA. 13+33.42, 37.99' RT, R=25'
600	(C) STA. 10+36.00, 32.99' LT, R=20'	(H) STA. 10+93.50, 23.00' LT, R=10'	(M) STA. 11+82.60, 23.00' LT, R=10'
595	(D) STA. 10+31.04, 28.00' RT, R=15'	(I) STA. 11+20.23, 17.15' RT, R=4.15'	(N) STA. 12+52.99, 37.99' LT, R=25'
590	(E) STA. 10+38.50, 23.00' LT, R=10'	(J) STA. 11+49.50, 20.00' LT, R=7'	(O) STA. 12+52.88, 37.99' RT, R=25'