

F.A.P. RTE.	SECTION	COUNTY	TOTAL SHEETS	SHEET NO.
609	...	ST. CLAIR	350	120
STA.		TO STA.		
FED. ROAD DIST. NO.		ILLINOIS FED. AID PROJECT		
...76RS-3, 76-2BR-21				

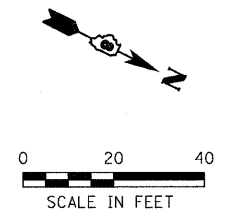

DESIGN		
INT.	DATE	REASON

PLOTS & CHECKS			
INT.	DATE	NO.	REASON

CHECKS		
INT.	DATE	REASON

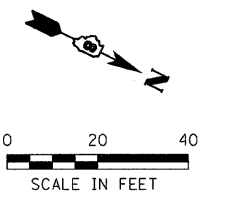
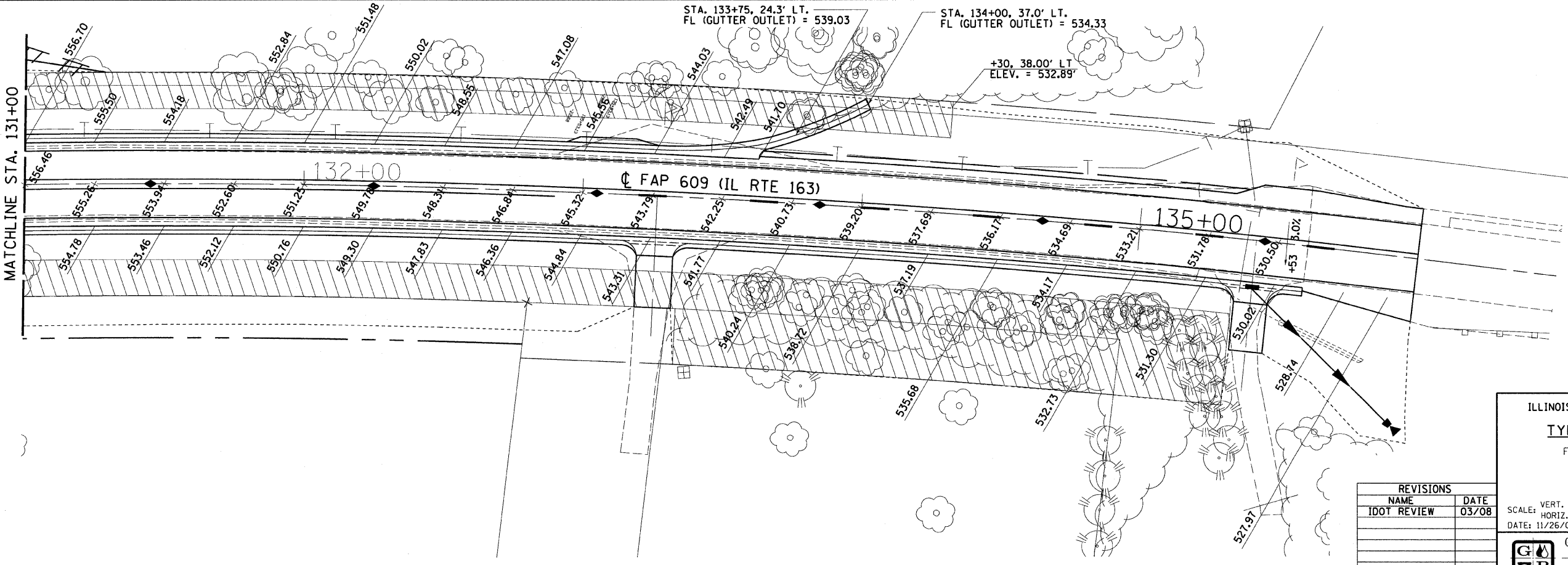
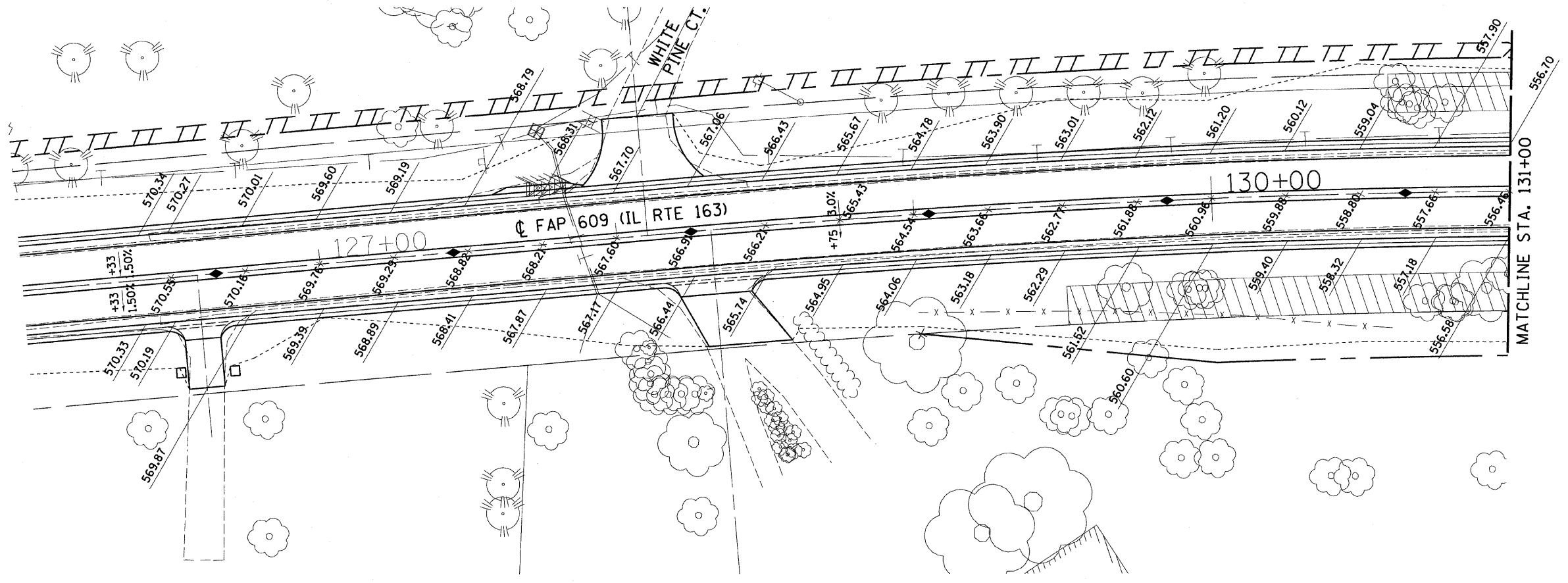

ILLINOIS DEPARTMENT OF TRANSPORTATION
TYPE A GUTTER DETAILS
 FAP 609 (ILLINOIS ROUTE 163)
 SECTION 76RS-3, 76-2BR-21
 ST. CLAIR COUNTY

REVISIONS		
NAME	DATE	
IDOT REVIEW	03/08	

SCALE: VERT. _____
 SCALE: HORIZ. _____
 DATE: 11/26/02

DRAWN BY: SUTHEARD
 DESIGNED BY: BOTT
 CHECKED BY: EMRICK

GREENE & BRADFORD, INC.
OF SPRINGFIELD
 CONSULTING ENGINEERS
300 WEST MAIN STREET
 SPRINGFIELD, ILLINOIS 62702
 217-790-8884

COMPUTER FILE NO.
 GUTTER02_V8
 PROJECT: 02076
 6/18/07-MDS