

F.A.P. RTE.	SECTION	COUNTY	TOTAL SHEETS	SHEET NO.
609	***	ST. CLAIR	350	171
STA. 44+34.00		TO STA. 45+00.00		
FED. ROAD DIST. NO.		ILLINOIS	FED. AID PROJECT	
*** T6RS-3, 76-2BR-21				

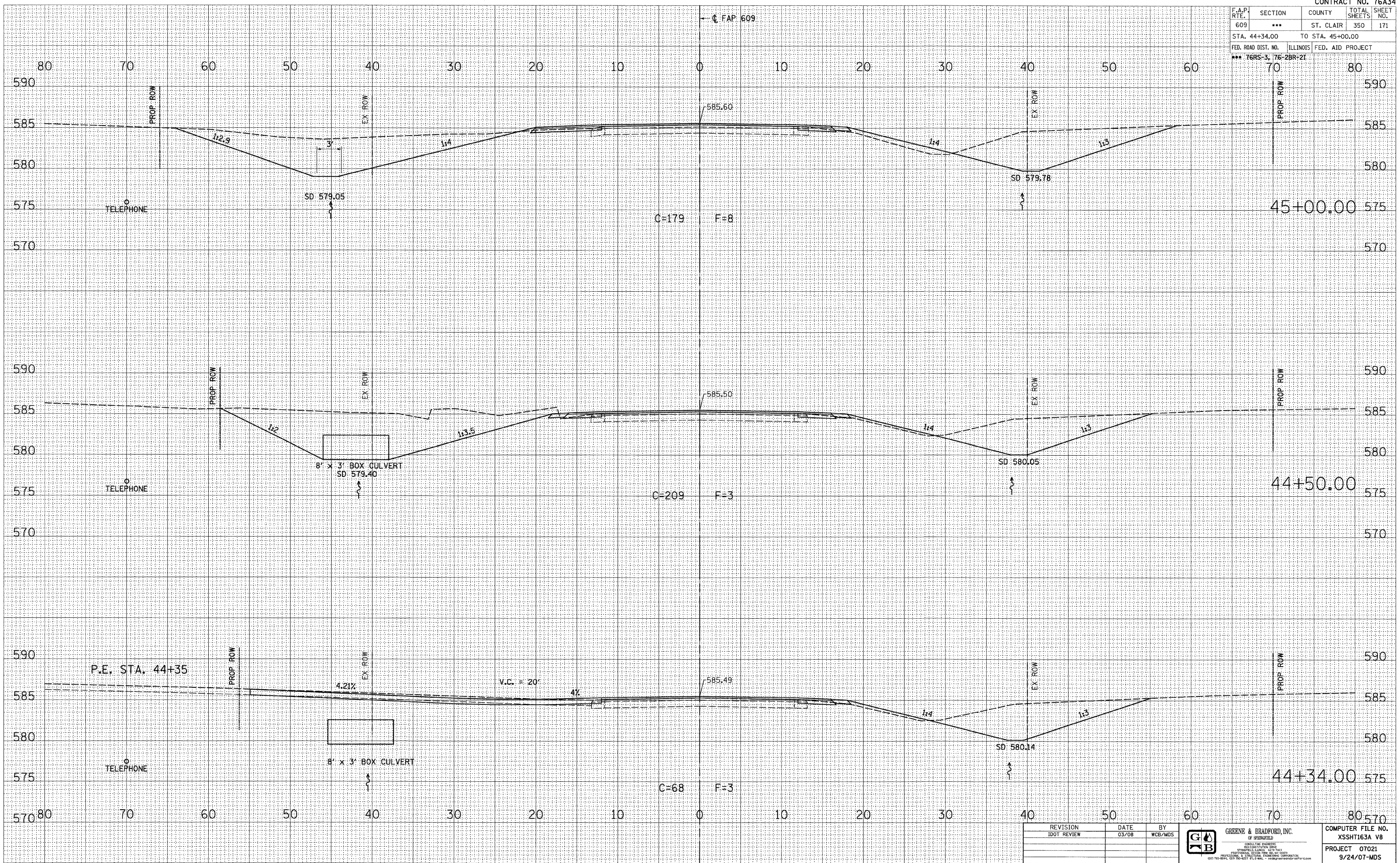

DATE	
BY	
SURVEYED	
PLOTTED	
TEMPLATE	
NOTE BOOK	
AREAS CHECKED	
NO.	

DATE	
BY	
SURVEYED	
PLOTTED	
TEMPLATE	
NOTE BOOK	
AREAS CHECKED	
NO.	

PLOT DATE = 8/1/2008 4:29:23 PM
 FILE NAME = J:\02376\GRAMMUS\XSSHT163A V8.dwg
 PLOT SCALE = 5/8" = 1' / IN.
 MODEL = Default
 OPERATOR = marks

REVISION	DATE	BY
IDOT REVIEW	03/08	WCB/MDS

GREENE & BRADFORD, INC.
 CONSULTING ENGINEERS
 2000 W. WASHINGTON ST.
 SPRINGFIELD, ILLINOIS 62761
 PHONE: 217-223-8800 FAX: 217-223-8801
 CELL: 781-884-1027 WWW: WWW.GREENEANDBRADFORD.COM

COMPUTER FILE NO.	XSSHT163A V8
PROJECT	07021
	9/24/07-MDS

MAINLINE CROSS SECTIONS - FAP 609 (IL RTE. 163) ST. CLAIR COUNTY
STA. 44+34.00 TO STA. 45+00.00