

F.A.P. RTE.	SECTION	COUNTY	TOTAL SHEETS	SHEET NO.
609	***	ST. CLAIR	350	172
STA. 45+50.00		TO STA. 46+00.00		
FED. ROAD DIST. NO.		ILLINOIS FED. AID PROJECT		
*** 76RS-3; 76-ZBR-21				

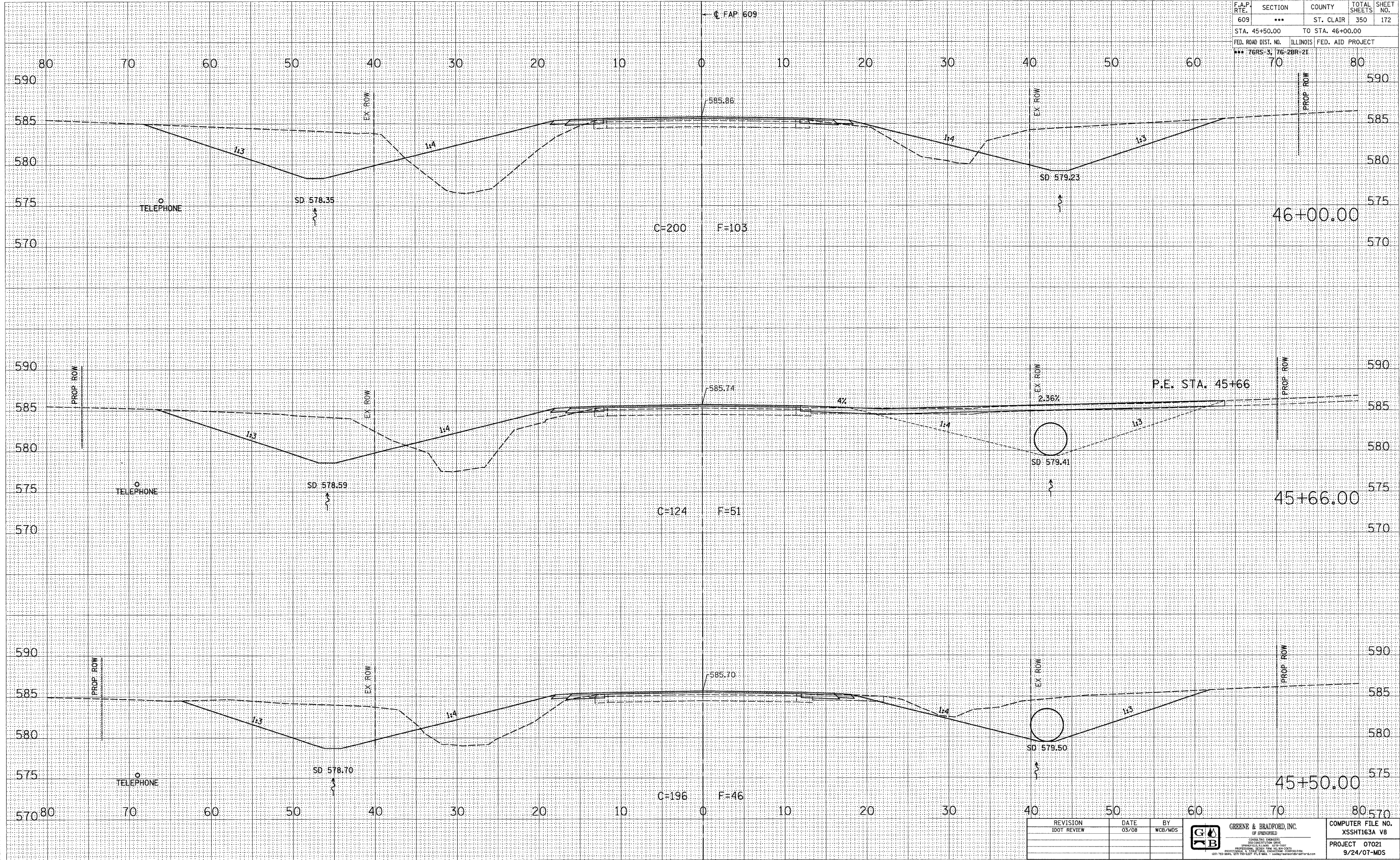

DATE	
BY	
SURVEYED	
PLOTTED	
NOTE BOOK	
AREAS CHECKED	
NO.	

DATE	
BY	
ORIGINAL SURVEY	
PLOTTED	
NOTE BOOK	
AREAS CHECKED	
NO.	

PLOT DATE = 8/1/2008 4:28:23 PM
 FILE NAME = J:\2007\DRAWINGS\XSSHT163A.VB
 PLOT SCALE = 5/8" = 1' IN.
 MODEL = Default
 OPERATOR =

REVISION	DATE	BY	 GREENE & BRADFORD, INC. OF SPRINGFIELD <small>CONSULTING ENGINEERS 200 CONSTITUTION DRIVE SPRINGFIELD, ILLINOIS 62761 PROFESSIONAL & TECHNICAL SERVICES (417) 793-8444, (417) 793-8227 FAX (417) 793-8444</small>	COMPUTER FILE NO.
1007 REVIEW	03/08	WCB/MDS		XSSHT163A V8
				PROJECT 07021
				9/24/07-MDS

**MAINLINE CROSS SECTIONS - FAP 609 (IL RTE. 163) ST. CLAIR COUNTY
STA. 45+50.00 TO STA. 46+00.00**