

F.A.P. RTE.	SECTION	COUNTY	TOTAL SHEETS	SHEET NO.
609	***	ST. CLAIR	350	173
STA. 46+50.00		TO STA. 47+35.39		
FED. ROAD DIST. NO.	ILLINOIS	FED. AID PROJECT		
*** 76RS-3, 76-ZBR-21				

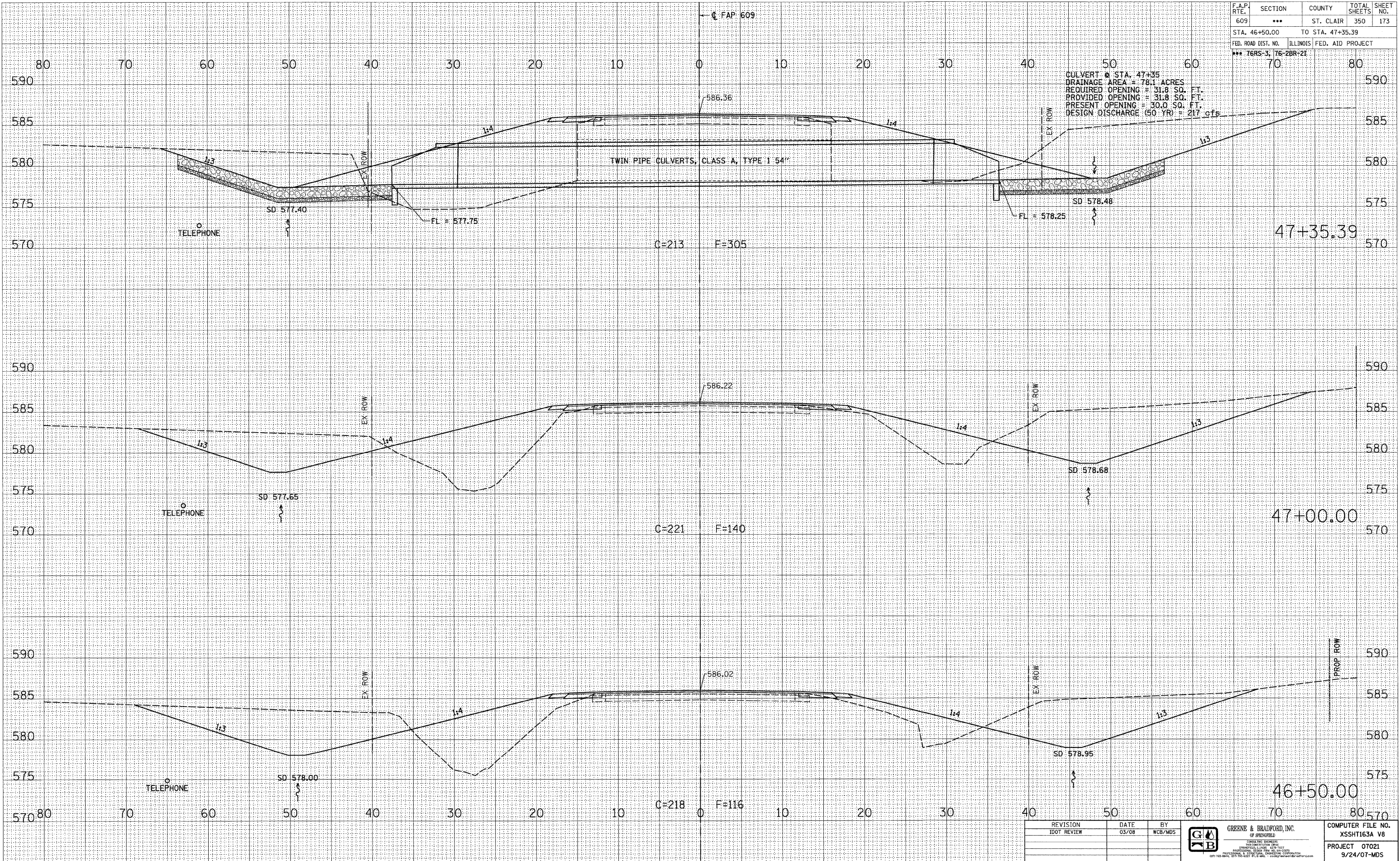

CULVERT @ STA. 47+35
 DRAINAGE AREA = 78.1 ACRES
 REQUIRED OPENING = 31.8 SQ. FT.
 PROVIDED OPENING = 31.8 SQ. FT.
 PRESENT OPENING = 30.0 SQ. FT.
 DESIGN DISCHARGE (50 YR) = 217 cfs

BY	DATE
SURVEYED	
PLOTTED	
NOTE BOOK	
AREAS CHECKED	

BY	DATE
SURVEYED	
PLOTTED	
NOTE BOOK	
AREAS CHECKED	

BY	DATE
SURVEYED	
PLOTTED	
NOTE BOOK	
AREAS CHECKED	

PLOT DATE = 8/7/2008 4:29:24 PM
 FILE NAME = J:\2007\DRAWINGS\XSSHT163A.V8
 PLOT SCALE = 5/8" = 1' IN.
 MODEL = Default
 OPERATOR = marks

REVISION	DATE	BY
IDOT REVIEW	03/08	WCB/MDS

GREENE & BRADFORD, INC.
 OF SPRINGFIELD
 CONSULTING ENGINEERS
 1015 S. BROADWAY, SUITE 200
 SPRINGFIELD, ILLINOIS 62767
 PHONE: 217.223.8800 FAX: 217.223.8801
 WWW.GREENEANDBRADFORD.COM

COMPUTER FILE NO.	XSSHT163A V8
PROJECT	07021
	9/24/07-MDS

MAINLINE CROSS SECTIONS - FAP 609 (IL RTE. 163) ST. CLAIR COUNTY
STA. 46+50.00 TO STA. 47+35.39