

F.A.P. RTE.	SECTION	COUNTY	TOTAL SHEETS	SHEET NO.
609	***	ST. CLAIR	350	205
STA. 83+50.00		TO STA. 84+50.00		
FED. ROAD DIST. NO.		ILLINOIS	FED. AID PROJECT	
*** 76RS-3; 76-2BR-21			80	

DATE	BY

DATE	BY

PLOT DATE	8/1/2008	4:26:35 PM
FILE NAME	J:\02076\DRAWINGS\XSSHT163A.V8	
PLOT SCALE	5.0000' / IN.	
MODEL	Default	
OPERATOR	marks	

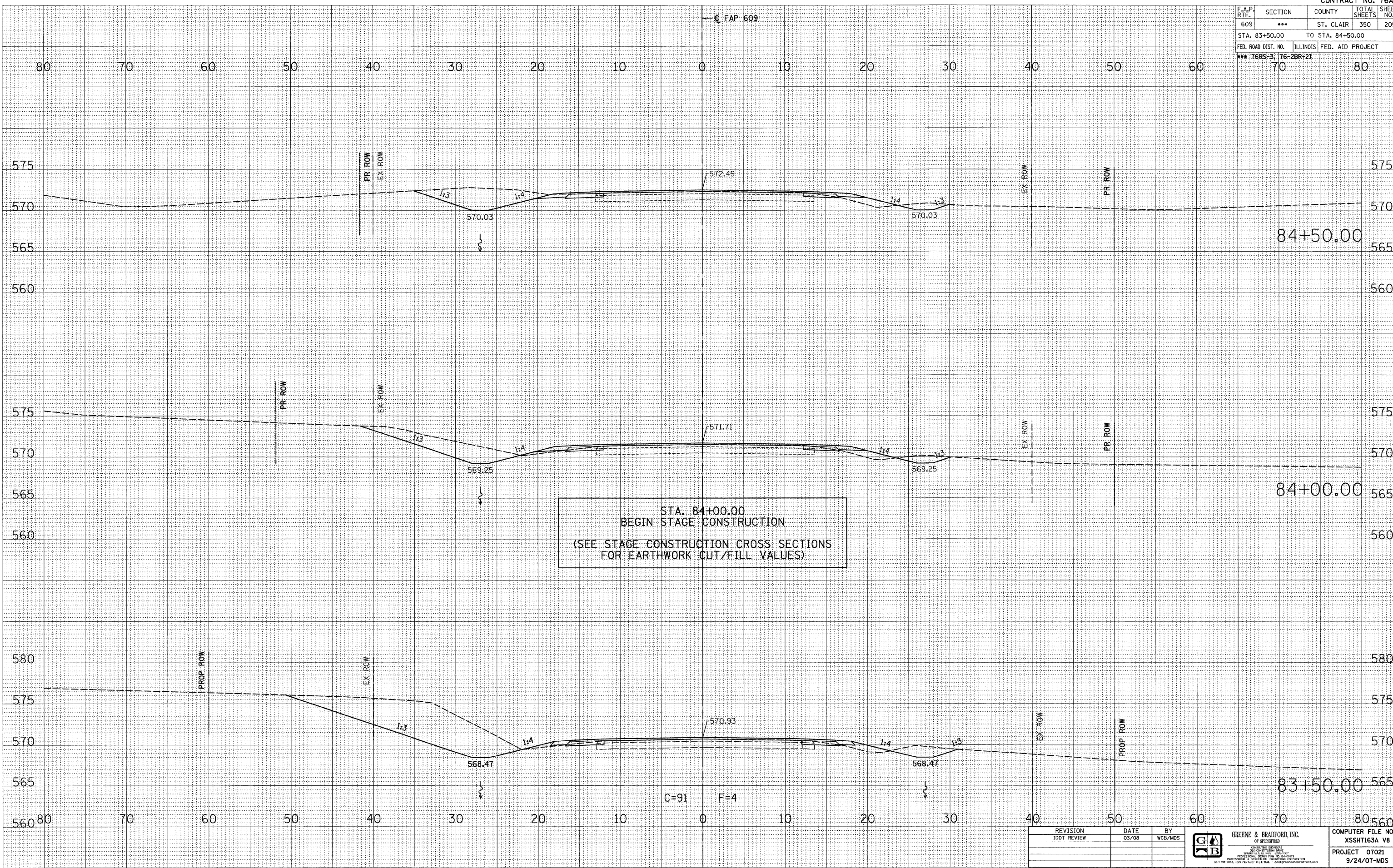

STA. 84+00.00
 BEGIN STAGE CONSTRUCTION
 (SEE STAGE CONSTRUCTION CROSS SECTIONS
 FOR EARTHWORK CUT/FILL VALUES)

REVISION	DATE	BY

GREENE & BRADFORD, INC.
 OF SPRINGFIELD
 CONSULTING ENGINEERS
 205 CONSTITUTION DRIVE
 SPRINGFIELD, ILLINOIS 62702
 PROFESSIONAL ENGINEERS LICENSE NO. 044-00017
 PROFESSIONAL SURVEYORS LICENSE NO. 010-02108
 (202) 753-8844, (202) 753-8227, FAX: (202) 753-8844
 www.greenebradford.com

COMPUTER FILE NO.	XSSHT163A V8
PROJECT	07021
	9/24/07-MDS

**MAINLINE CROSS SECTIONS - FAP 609 (IL RTE. 163) ST. CLAIR COUNTY
 STA. 83+50.00 TO STA. 84+50.00**