

F.A.P. RTE.	SECTION	COUNTY	TOTAL SHEETS	SHEET NO.
609	***	ST. CLAIR	350	228
STA. 112+50.00		TO STA. 113+00.00		
FED. ROAD DIST. NO.		ILLINOIS	FED. AID PROJECT	
*** 76RS-3, 76-2BR-21				

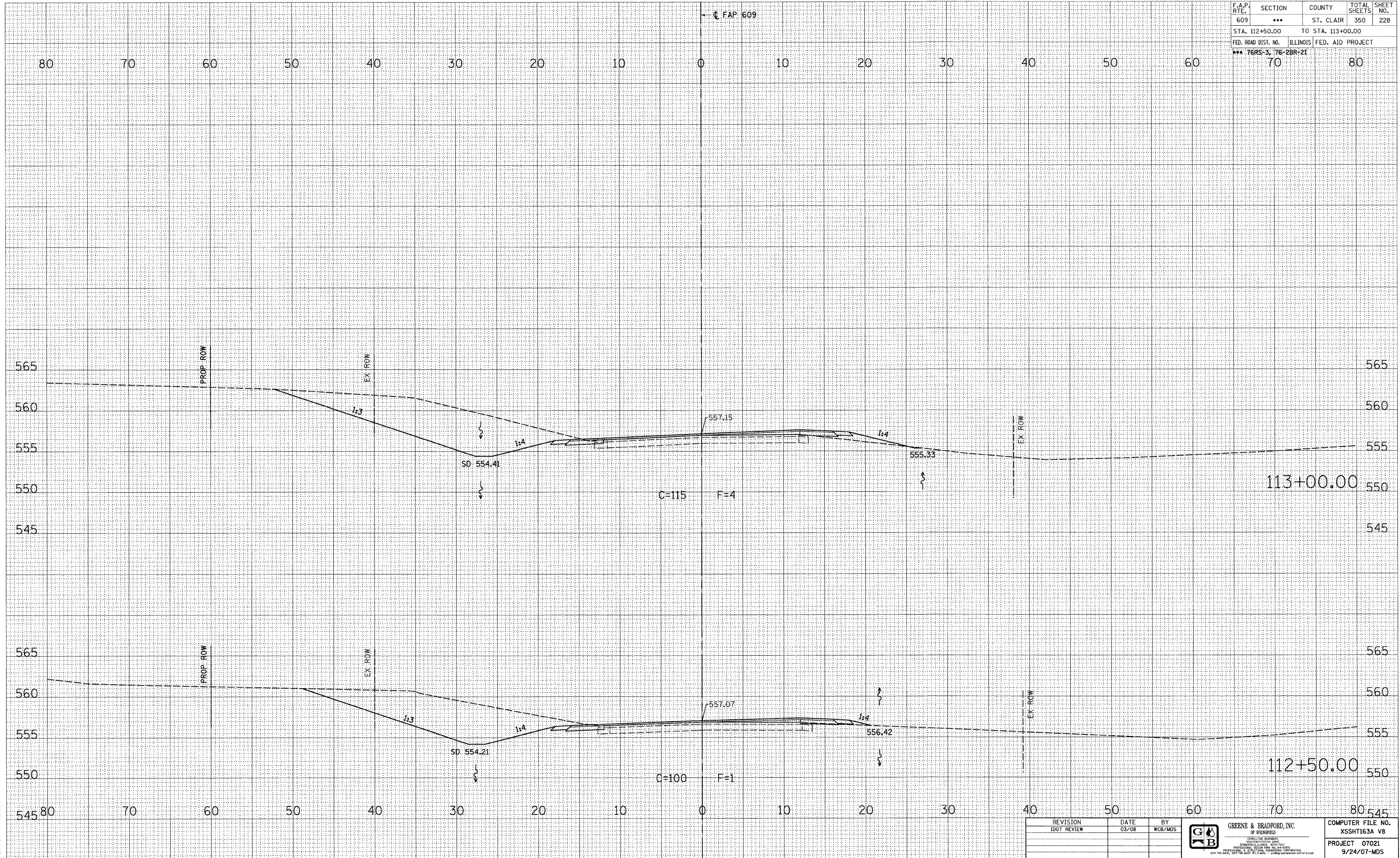

BY	DATE

BY	DATE

PLOT DATE = 8/1/2008 4:29:43 PM  
 FILE NAME = J:\22876\DRAWINGS\SSHT163A.VB8  
 PLOT SCALE = 5/8" = 1' / IN.  
 MODEL = Default  
 OPERATOR = marks

REVISION	DATE	BY	 GREENE & BRADFORD, INC. OF SPRINGFIELD <small>CORPORATE ENGINEERS        SPRINGFIELD, ILLINOIS 62760        PROFESSIONAL ENGINEERS LICENSE NO. 0012        620 783-8444, 620 783-8227, 9/11/08</small>	COMPUTER FILE NO.
IDOT REVIEW	03/08	WCB/MDS		XSSHT163A V8
				PROJECT 07021
				9/24/07-MDS

**MAINLINE CROSS SECTIONS – FAP 609 (IL RTE. 163) ST. CLAIR COUNTY**  
**STA. 112+50.00 TO STA. 113+00.00**