

F.A.P. RTE.	SECTION	COUNTY	TOTAL SHEETS	SHEET NO.
609	***	ST. CLAIR	350	237
STA. 124+50.00		TO STA. 126+00.00		
FED. ROAD DIST. NO.		ILLINOIS	FED. AID PROJECT	
*** 76RS-3, 76-ZBR-21				

FINAL SURVEY	SURVEYED	BY	DATE
NOTE BOOK	PLOTTED		
AREAS CHECKED			
NO.			

ORIGINAL SURVEY	SURVEYED	BY	DATE
NOTE BOOK	PLOTTED		
AREAS CHECKED			
NO.			

PLOT DATE = 8/1/2008 4:28:47 PM
 FILE NAME = J:\02876\DRAWINGS\XSSHT163A.VB
 PLOT SCALE = 5.0000 / IN.
 MODEL = Default
 OPERATOR = mbrk

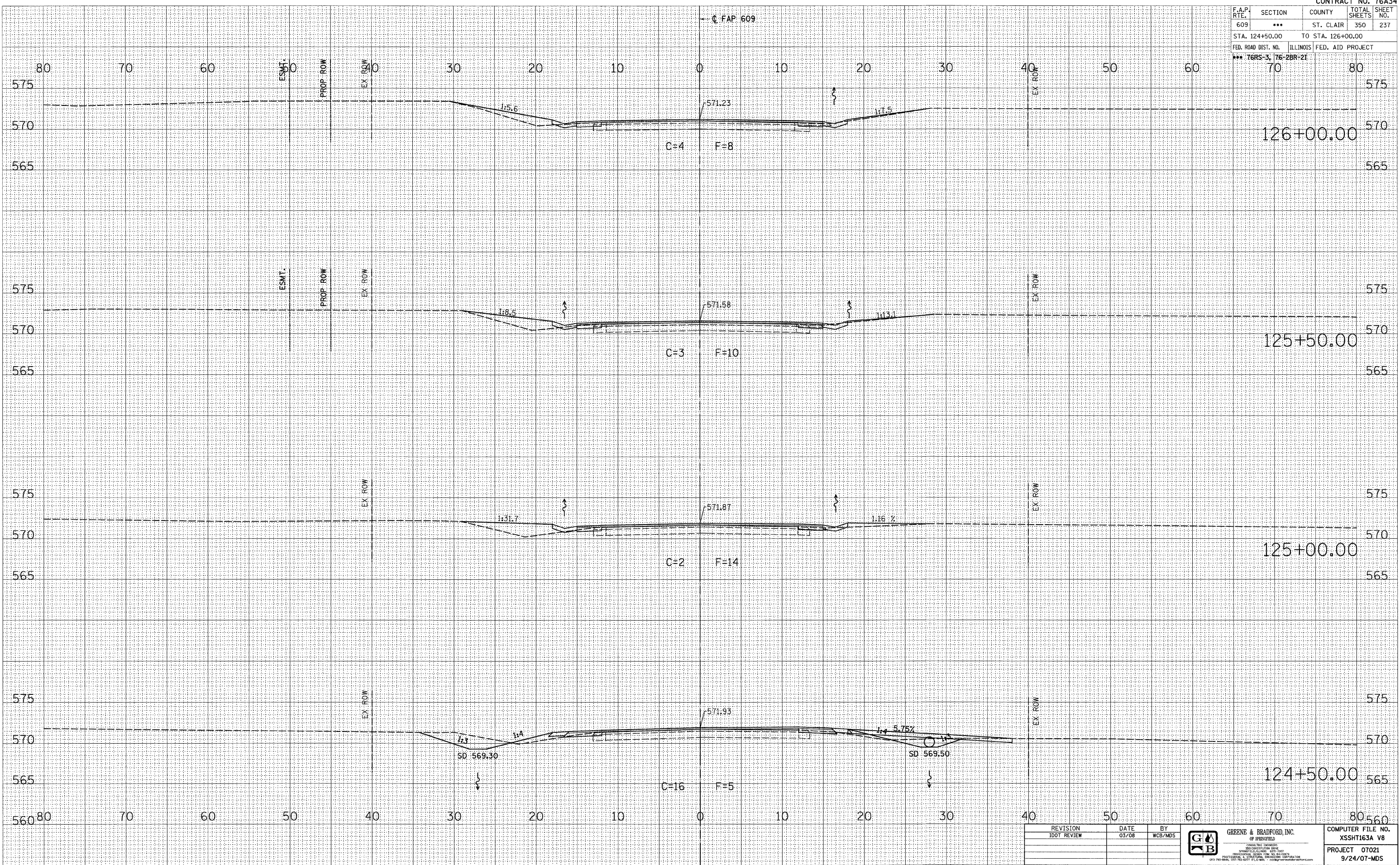

REVISION	DATE	BY
IDOT REVIEW	03/08	WCB/MDS

GB GREENE & BRADFORD, INC.
 OF SPRINGFIELD

 CIVIL ENGINEERS
 200 CONVENT ROAD
 SPRINGFIELD, ILLINOIS 62761
 PHONE: 217.223.8200 FAX: 217.223.8201
 PROJECTS: 1995-2008 100% COMPLETE

COMPUTER FILE NO.	XSSHT163A.VB
PROJECT	07021
	9/24/07-MDS

MAINLINE CROSS SECTIONS - FAP 609 (IL RTE. 163) ST. CLAIR COUNTY
STA. 124+50.00 TO STA. 126+00.00