

FRAMING PLAN

Note: N.T.R. Indicates that Notch Toughness Requirements are applicable.

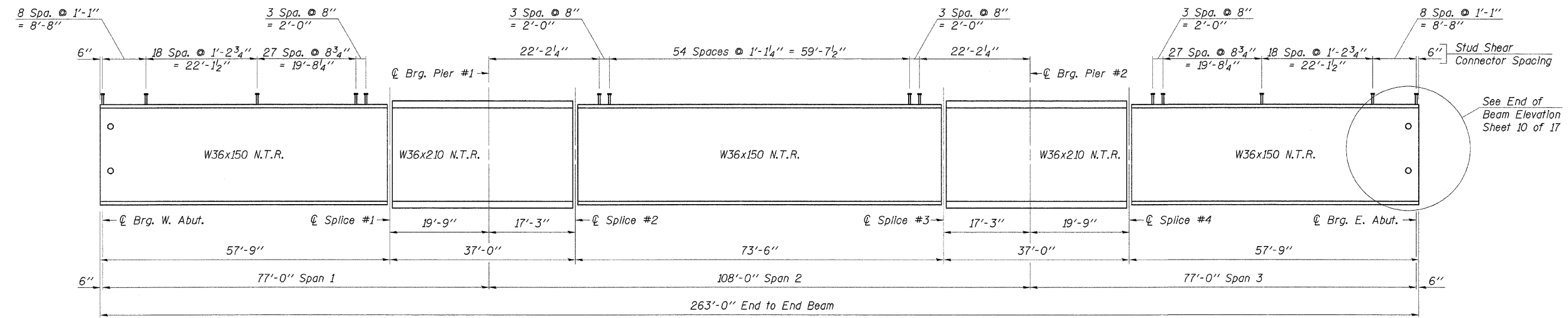

ELEVATION

Note: See Sheet 10 of 17 for Splice Details.

Load carrying components designated "N.T.R." shall conform to the Supplemental Requirements for Notch Toughness, Zone 2.

All diaphragms shall be installed as steel is erected and secured with erection pins and bolts except as otherwise noted. Individual diaphragms at supports may be temporarily disconnected to install bearing anchor rods.

Work this Sheet with Sheets 10 & 11 of 17.

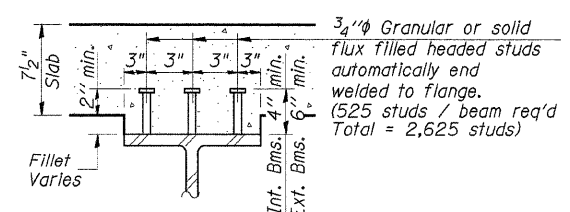

SECTION A-A
Typical Shear Connector Detail

TOP OF BEAM ELEVATIONS
(For fabrication only)

	Beam 1 or 5	Beam 2 or 4	Beam 3
☉ Brg. W. Abut.	643.93	644.15	644.25
☉ Splice 1	643.93	644.15	644.25
☉ Brg. Pier 1	643.95	644.17	644.27
☉ Splice 2	643.96	644.18	644.28
☉ Splice 3	643.96	644.18	644.28
☉ Brg. Pier 2	643.95	644.17	644.27
☉ Splice 4	643.93	644.15	644.25
☉ Brg. E. Abut.	643.93	644.15	644.25

DESIGNED	A.R.K.
CHECKED	F.J.S. & S.F.M.
DRAWN	S.A.P.
CHECKED	A.R.K. & F.J.S.

STRUCTURAL STEEL

SECTION 03-00147-01-BR
COUNTY HIGHWAY 7
STARK COUNTY
STATION 155+75

4440 ASH GROVE SPRINGFIELD, IL, 62711 (217) 793-8600 oasinc@insightbb.com	FEHR-GRAHAM & ASSOCIATES, LLC ENGINEERING AND SCIENCE CONSULTANTS PREPONT, IL, ROCKFORD, IL, ROCKFORD, IL, SPRINGFIELD, IL	JOB NO.: 46808 FILE:46808STEEL.DGN DATE: 10/08/07
--	---	---