

SECTION 16: T.2S.-R.7W. OF THE 4TH P.M.

DARRELL VAHLE, JR.  
PART OF THE W5/8; S1/2; SW1/4

THOMAS H. ELLIOT, II & DIANN M. ELLIOT  
PART OF THE E30A; SE1/4; SW1/4

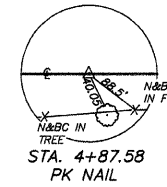
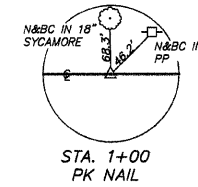
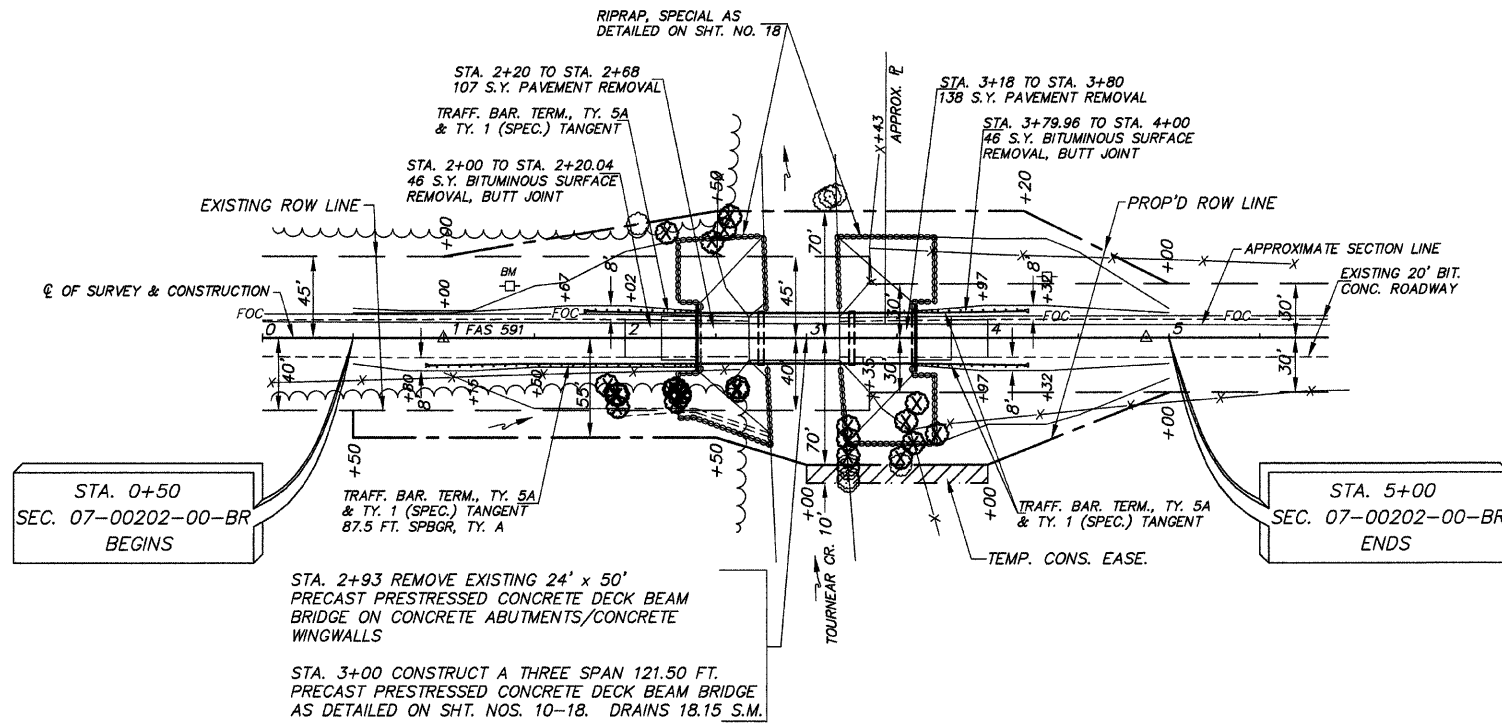

COUNTY	ROUTE	SECTION	SHT. NO.
ADAMS	FAS 591	07-00202-00-BR	5

STA. 0+00 - STA. 5+87.58

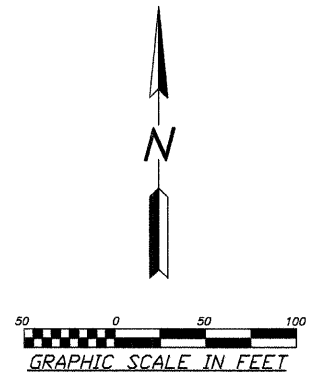

STA. 0+50  
SEC. 07-00202-00-BR  
BEGINS

STA. 5+00  
SEC. 07-00202-00-BR  
ENDS

STA. 2+93 REMOVE EXISTING 24' x 50' PRECAST PRESTRESSED CONCRETE DECK BEAM BRIDGE ON CONCRETE ABUTMENTS/CONCRETE WINGWALLS

STA. 3+00 CONSTRUCT A THREE SPAN 121.50 FT. PRECAST PRESTRESSED CONCRETE DECK BEAM BRIDGE AS DETAILED ON SHT. NOS. 10-18. DRAINS 18.15 S.M.

THOMAS H. ELLIOT, II & DIANN M. ELLIOT  
PART OF THE N45A; NW1/4

GUARD RAIL SCHEDULE

STA. - STA.	TRAF. BAR. TERM., TY 5A	TRAF. BAR. TERM., TY. 1 (SPEC.) TANGENT	SPBGR. TYPE A
RT. 0+92 - 2+40	1	1	87.5
LT. 1+77.50 - 2+40	1	1	
RT. 3+60 - 4+22.50	1	1	
LT. 3+60 - 4+22.50	1	1	

SECTION 21: T.2S.-R.7W. OF THE 4TH P.M.

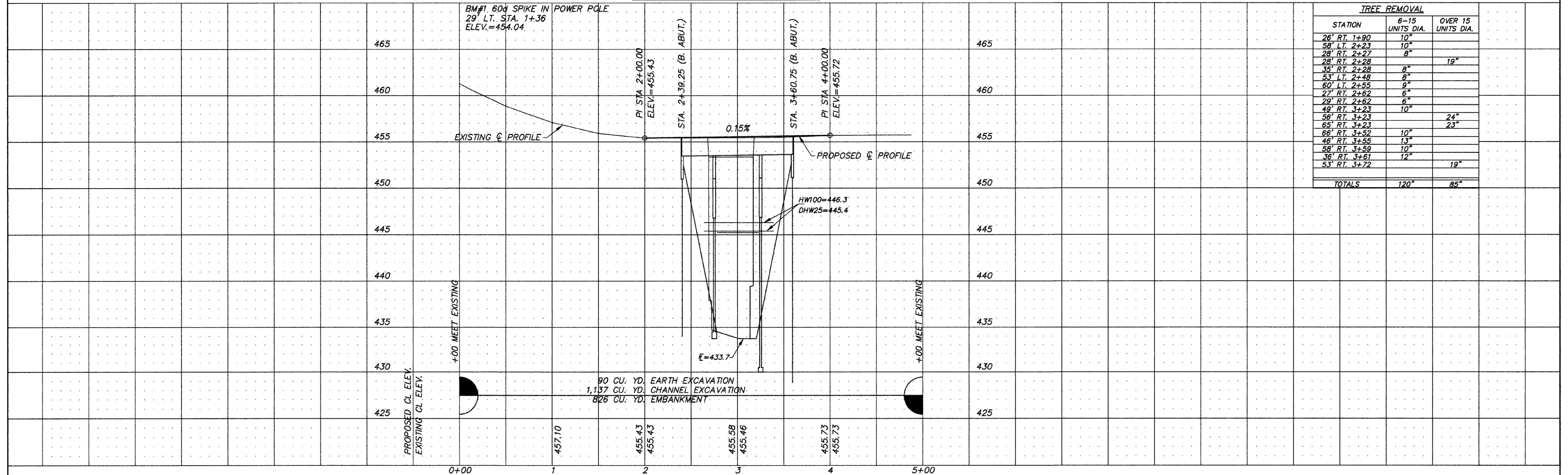

STATION	TREE REMOVAL	
	6-15 UNITS DIA.	OVER 15 UNITS DIA.
26' RT. 1+90	10"	
58' LT. 2+23	10"	
28' RT. 2+27	8"	
28' RT. 2+28	8"	19"
35' RT. 2+28	8"	
53' LT. 2+48	8"	
60' LT. 2+55	9"	
27' RT. 2+62	6"	
29' RT. 2+62	6"	
49' RT. 3+23	10"	
56' RT. 3+23		24"
65' RT. 3+23		23"
66' RT. 3+52	10"	
46' RT. 3+55	13"	
58' RT. 3+59	10"	
36' RT. 3+61	12"	
53' RT. 3+72		19"
TOTALS	120"	85"

90 CU. YD. EARTH EXCAVATION  
1,137 CU. YD. CHANNEL EXCAVATION  
826 CU. YD. EMBANKMENT