

STATE OF ILLINOIS
 DEPARTMENT OF TRANSPORTATION
 DIVISION OF HIGHWAYS
 PLANS FOR PROPOSED
 FEDERAL-AID HIGHWAY BRIDGE PROGRAM

LAWRENCE COUNTY
 SECTION 07-05123-00-BR
 DENISON ROAD DISTRICT
 STRUCTURE NO. 051- 3282
 PROJECT NO. BROS-101(28)
 JOB NO. C-97-107-08
 TR 249

INDEX OF SHEETS

- 1 COVER SHEET
- 2 PLAN & PROFILE
- 3 CROSS SECTIONS
- 4-11 BRIDGE PLANS

- STANDARDS: 280001-04 - EROSION CONTROL
 701901 - TRAFFIC
 BLR 21-7 - TRAFFIC
 BLR 22-5 - TRAFFIC
 515001-02 - NAME PLATE

SUMMARY OF QUANTITIES

QTY	UNIT	ITEM	CODE NO.
236	CU YD	EARTH EXCAVATION	20200100
187	CU YD	CHANNEL EXCAVATION	20300100
1311	CU YD	FURNISHED EXCAVATION	20400800
0.90	ACRE	SEEDING, CLASS 2 (SPECIAL)	25001000
6	EACH	AGGREGATE DITCH CHECKS	28000310
60	FOOT	PERIMETER EROSION BARRIER	28000400
140	TON	STONE DUMPED RIPRAP, CLASS A4	28100807
42	TON	STONE RIPRAP DITCH	28102600
1	EACH	REMOVAL OF EXISTING STRUCTURES	50100100
21.0	CU YD	CONCRETE STRUCTURES	50300225
2.8	CU YD	CONCRETE ENCASEMENT	50300280
1680	SQ FT	PRECAST PRESTRESSED CONCRETE DECK BEAMS (27" DEPTH)	50400505
3490	POUND	REINFORCEMENT BARS	50800105
116	FOOT	STEEL RAILING, TYPE S1	50900205 *
234	FOOT	FURNISHING STEEL PILES HP 12x53	51201600
234	FOOT	DRIVING PILES	51202305
1	EACH	TEST PILE STEEL HP 12x53	51203600
1	EACH	NAME PLATES	51500100
36	FOOT	PIPE CULVERTS, CLASS D, TYPE 1 18"	542D0223
1	L SUM	MOBILIZATION	67100100
1	L SUM	TRAFFIC CONTROL AND PROTECTION	70101700
286	TON	AGGREGATE SURFACE COURSE, TYPE B (CA-6)	XX003658
138	TON	AGGREGATE SURFACE COURSE, TYPE B (CA-9)	XX003659

* SPECIALTY ITEMS

FUNCTIONAL CLASS: RURAL LOCAL ROAD
 ADT = 75
 DESIGN SPEED = 30 MPH

CONTRACT NO. 95560

TOLL FREE JOINT UTILITY LOCATING
 INFORMATION FOR EXCAVATORS (J.U.L.I.E.)
 TELEPHONE NO. 1-800-892-0123

SCALES

- PLAN 1 INCH = 50 FEET
- PROFILE HORZ. 1 INCH = 50 FEET
- PROFILE VERT. 1 INCH = 10 FEET
- CROSS SECTION 1 INCH = 5 FEET

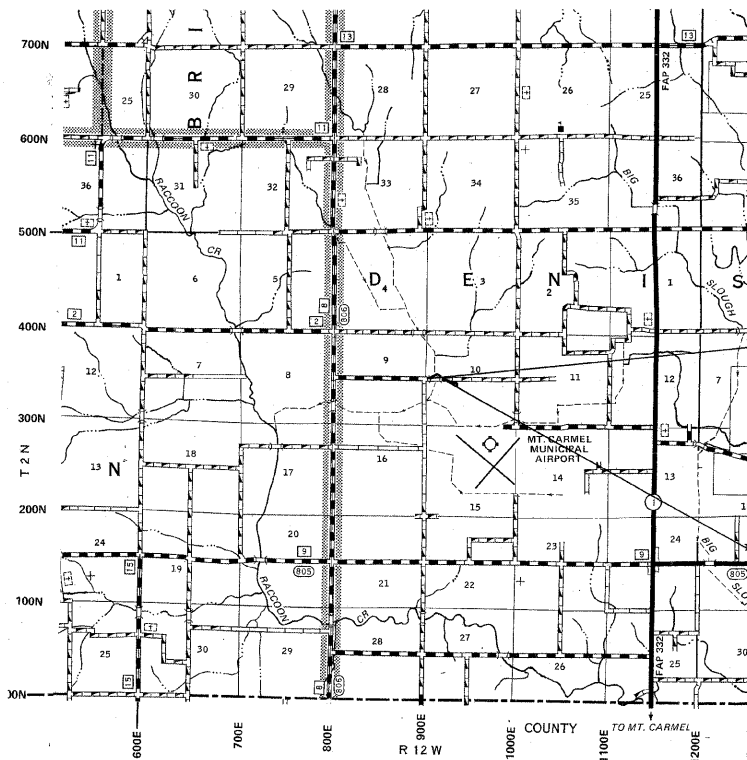

SECTION 07-05123-00-BR
 BEGINS STA. 1+00

STA. 4+35 - SPECIAL BRIDGE DESIGN
 PROPOSED PRECAST PRESTRESSED CONCRETE DECK
 BEAM BRIDGE. 1 SPAN @ 60', 28' RDWY., SKEW = 10' L.F.
 EXISTING STR. NO. 051-3109
 PROPOSED STR. NO. 051-3282

SECTION 07-05123-00-BR
 ENDS STA. 7+50

LOCATION MAP

APPROXIMATE SCALE: 1 INCH = 1 MILE
 NET LENGTH = 650 L.F. = 0.123 MILES

PROFESSIONAL DESIGN FIRM #184-000832

John A. Stone
 JOHN A. STONE
 002-086012
 REGISTERED
 PROFESSIONAL
 ENGINEER
 JULY 9, 2008
 ILLINOIS REGISTERED PROFESSIONAL ENGINEER # 55012
 LICENSE EXPIRES NOVEMBER 30, 2009

APPROVED JULY 9, 2008

LOCAL AGENCY REPRESENTATIVE

PASSED JULY 15, 2008

DISTRICT SEVEN ENGINEER
 OF LOCAL ROADS & STREETS

RELEASING FOR BID BASED ON LIMITED REVIEW

JULY 15, 2008

DEPUTY DIRECTOR OF HIGHWAYS
 REGION FOUR ENGINEER
 STATE OF ILLINOIS
 DEPARTMENT OF TRANSPORTATION