

**DAI**  
 DESIGN ARCHITECTS, INC.  
 PROFESSIONAL DESIGN NO: 184-000449

#5 BANK SQUARE  
 EAST ST. LOUIS, IL 62203  
 PH: 618.398.0890  
 F: 618.398.1339

HILLSBORO, IL  
 SPRINGFIELD, IL  
 MARION, IL

**HR**  
 HURST-ROSCHE  
 ENGINEERS INC.  
 PROFESSIONAL DESIGN NUMBER: 184-000290

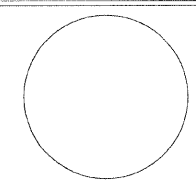

SIGNATURE  
 DATE  
 LICENSE EXPIRES

FEDERALLY FUNDED STREET RESURFACING  
 CITY OF CENTREVILLE  
 ST. CLAIR COUNTY, ILLINOIS  
 SEC. 05-00015-00-RS

MARK	DATE	DESCRIPTION

PROJECT NO: 210-1916  
 DESIGN: CKA    DRAWN: SDD    CHECK: MRA

PLAN SHEET  
 71ST STREET  
 EDNA ST. TO.  
 AMES DRIVE

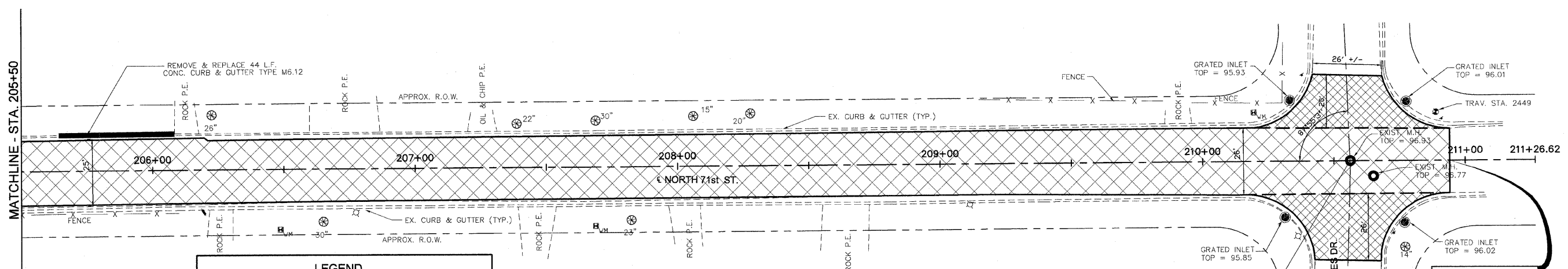

**LEGEND**

- LIMITS OF HOT-MIX ASPHALT SURFACE COURSE, MIX "C", N50, 2" ON 1" LEVELING BINDER
- LIMITS OF SIDE STREET TRANSITION (SEE BUTT JOINT DETAIL ON SHEET 2)
- LIMITS OF 2" AGGREGATE SHOULDER OR AGGREGATE DRIVEWAY TRANSITION
- LIMITS OF 2" HOT-MIX ASPHALT DRIVEWAY TRANSITION
- MANHOLE TO BE ADJUSTED
- GRATED INLET TO REMAIN

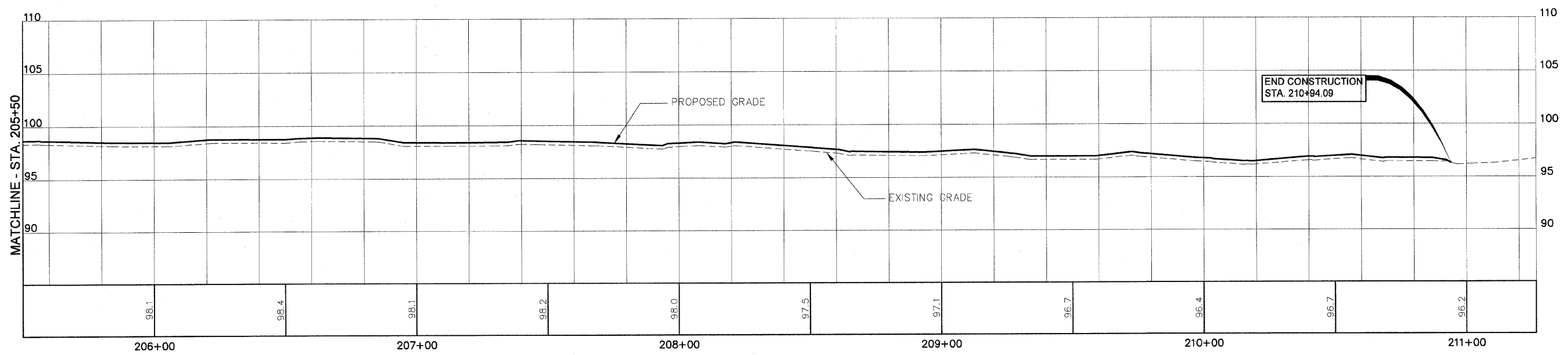

SCALE:  
 1" = 20' HORIZ.  
 1" = 5' VERT.