

F.A. RTE.	SECTION	COUNTY	TOTAL SHEETS	SHEET NO.
932	(8,9,11)W,RS-1	*	401	69
STA.	TO STA.			
FED. ROAD DIST. NO.	ILLINOIS	FED. AID PROJECT	* JOHNSON & POPE	

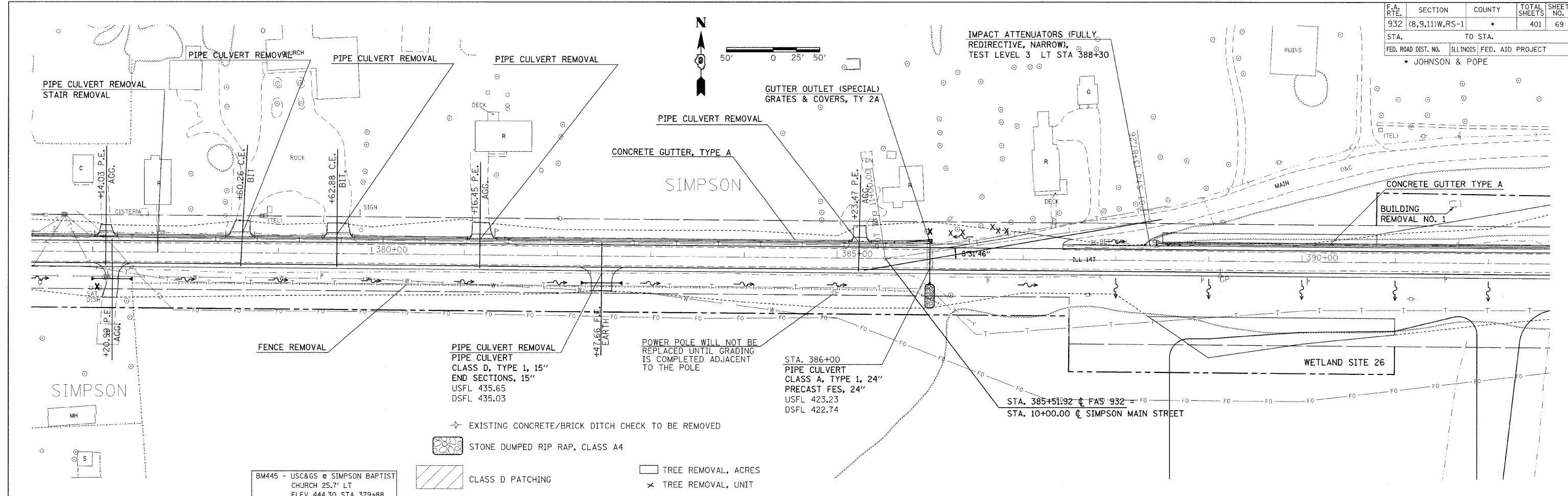

- BM445 - USC&GS @ SIMPSON BAPTIST CHURCH 25.7' LT ELEV 444.30 STA 379+88
- BM32 - R.R. SPIKE IN P.P. 39.7' LT ELEV 445.99 STA 378+63.60
- BM33 - "X" CUT IN BOLT ON TOP OF CONC RETAINING WALL 15.8' LT ELEV 418.09 STA 387+54.50
- ◇ EXISTING CONCRETE/BRICK DITCH CHECK TO BE REMOVED
- STONE DUMPED RIP RAP, CLASS A4
- CLASS D PATCHING
- TREE REMOVAL, ACRES
- × TREE REMOVAL, UNIT

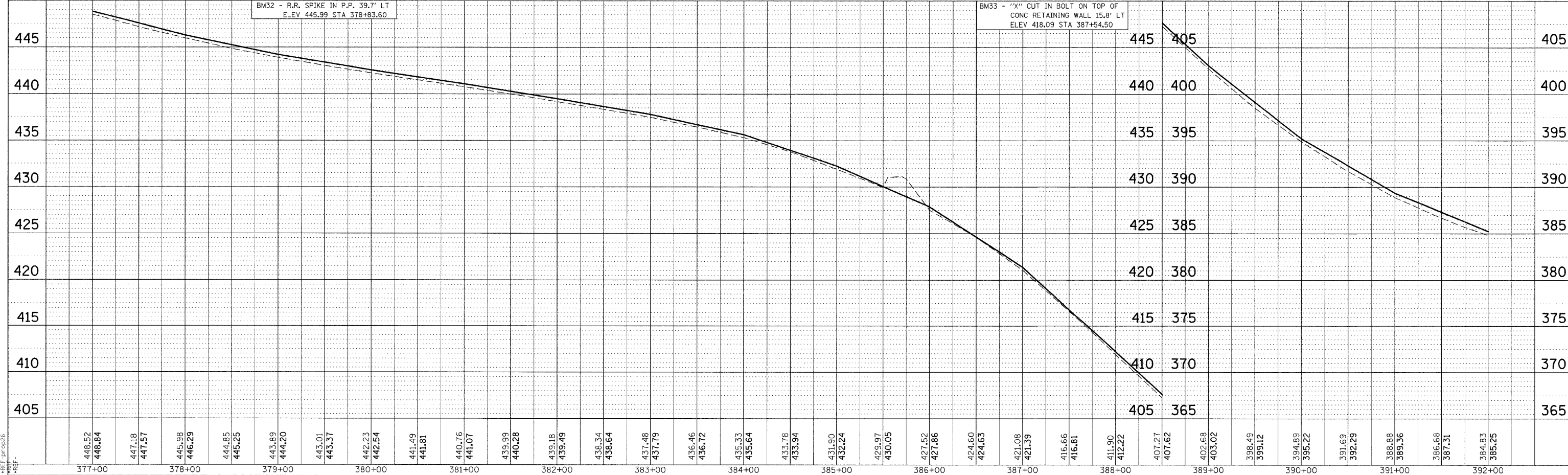

PLAN PROFILE SHEET STA 377+00 TO 392+00

PLAN	DATE
REVISIONS	BY
NO.	

PROFILE	DATE
REVISIONS	BY
NO.	

DATE-TIME
 DGN-SPEC
 REF-PC026
 REF-PC026