

F.A.S. RTE.	SECTION	COUNTY	TOTAL SHEETS	SHEET NO.
932	(8,9,11)W,RS-1		401	83
STA.	TO STA.			
FED. ROAD DIST. NO.	ILLINOIS	FED. AID PROJECT	JOHNSON & POPE	

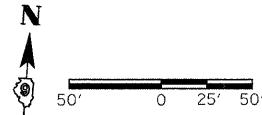

DATE	BY
DATE	BY

DATE	BY
DATE	BY

DATE TIME:
 DRAWN SPEC:
 REF: T-109C-40
 REF: D-107-40

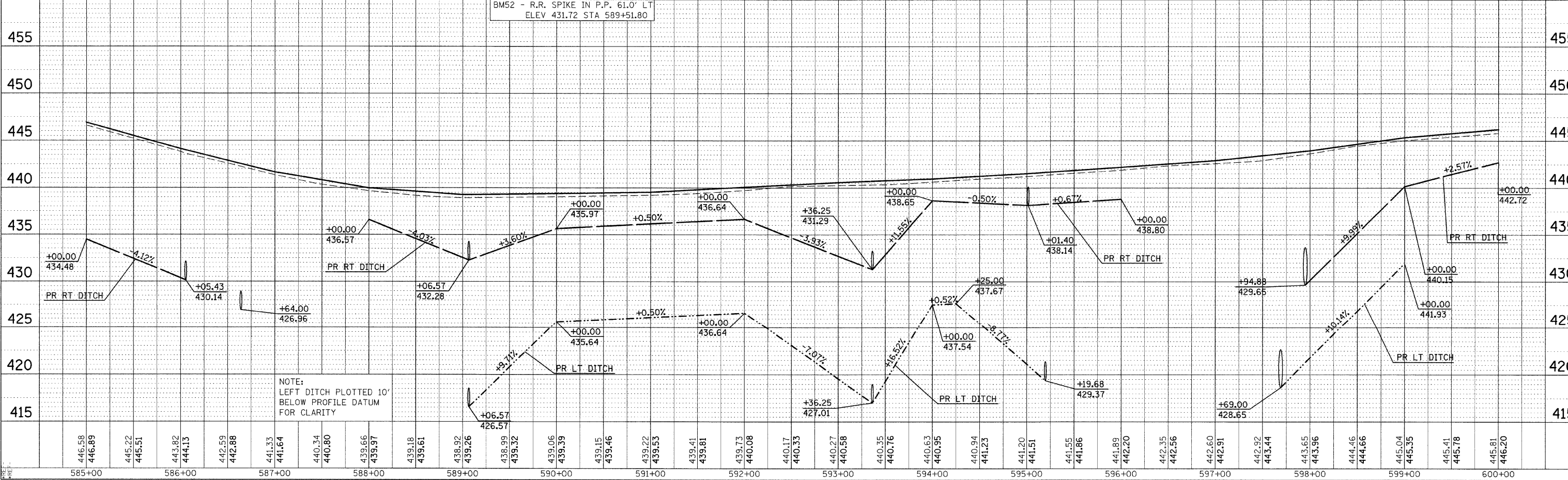
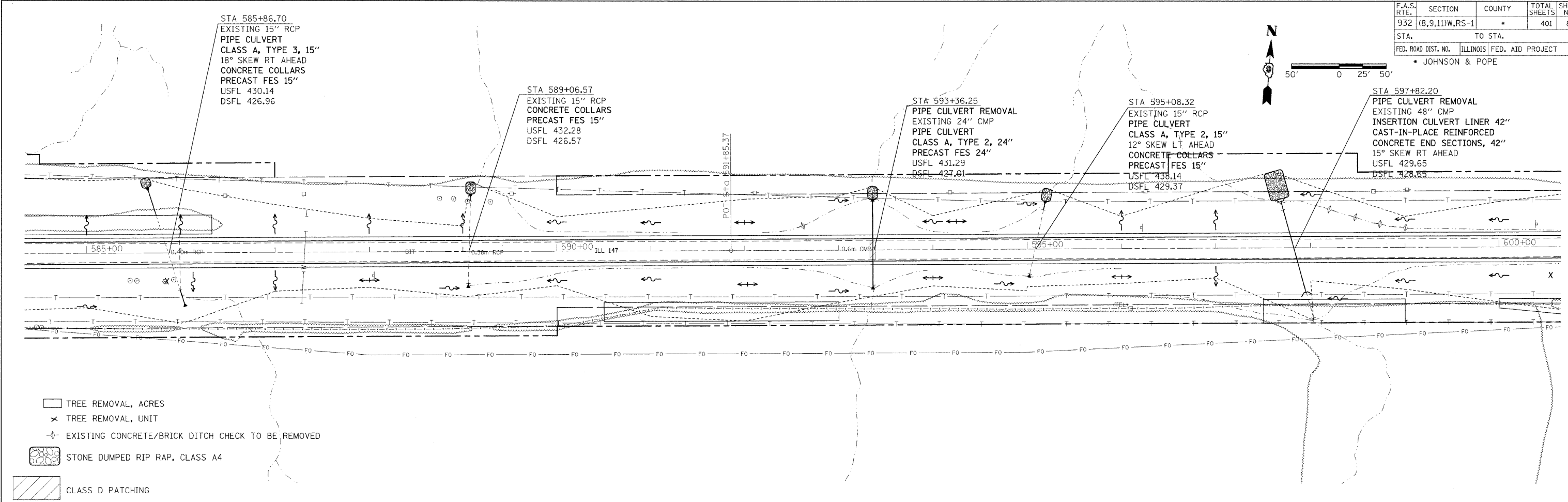

PLAN PROFILE SHEET STA 585+00 TO 600+00