

F.A.S. R.T.E.	SECTION	COUNTY	TOTAL SHEETS	SHEET NO.
932	(6,9,11)W,RS-1	•	401	286
STA. 274+50.81		TO STA. 276+00.00		
FED. ROAD DIST. NO.		ILLINOIS FED. AID PROJECT		
• JOHNSON & POPE				

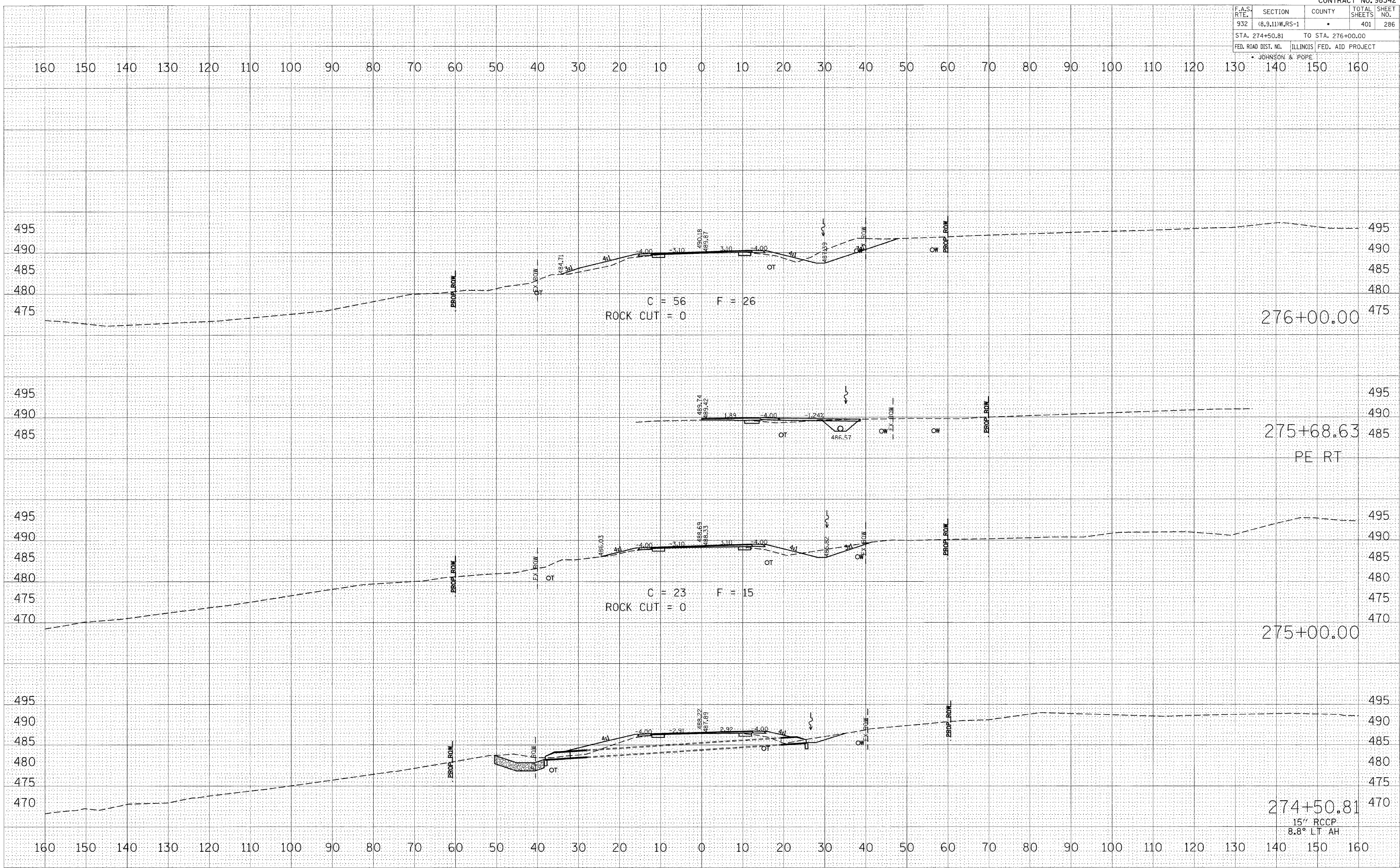

BY: _____ DATE: _____

FINAL SURVEYED SURVEYED SURVEYED SURVEYED
 SURVEY PLOTTED PLOTTED PLOTTED PLOTTED
 NOTE BOOK TEMPLATE TEMPLATE TEMPLATE TEMPLATE
 NO. _____

BY: _____ DATE: _____

ORIGINAL SURVEYED SURVEYED SURVEYED SURVEYED
 SURVEY PLOTTED PLOTTED PLOTTED PLOTTED
 NOTE BOOK TEMPLATE TEMPLATE TEMPLATE TEMPLATE
 NO. _____

PLOT DATE: #DATE#
 PLOT SCALE: #SCALE#
 USER NAME: #USER#

15" RCCP
 8.8° LT. AH