

F.A.S. RTE.	SECTION	COUNTY	TOTAL SHEETS	SHEET NO.
932	(6,9,11)W,RS-1	*	401	395
STA. 653+00.00 TO STA. 656+00.00				
FED. ROAD DIST. NO.		ILLINOIS	FED. AID PROJECT	
* JOHNSON & POPE				

BY	DATE
FINAL SURVEY	
PLOTTED	
TEMPLATE	
NOTE BOOK	
NO.	

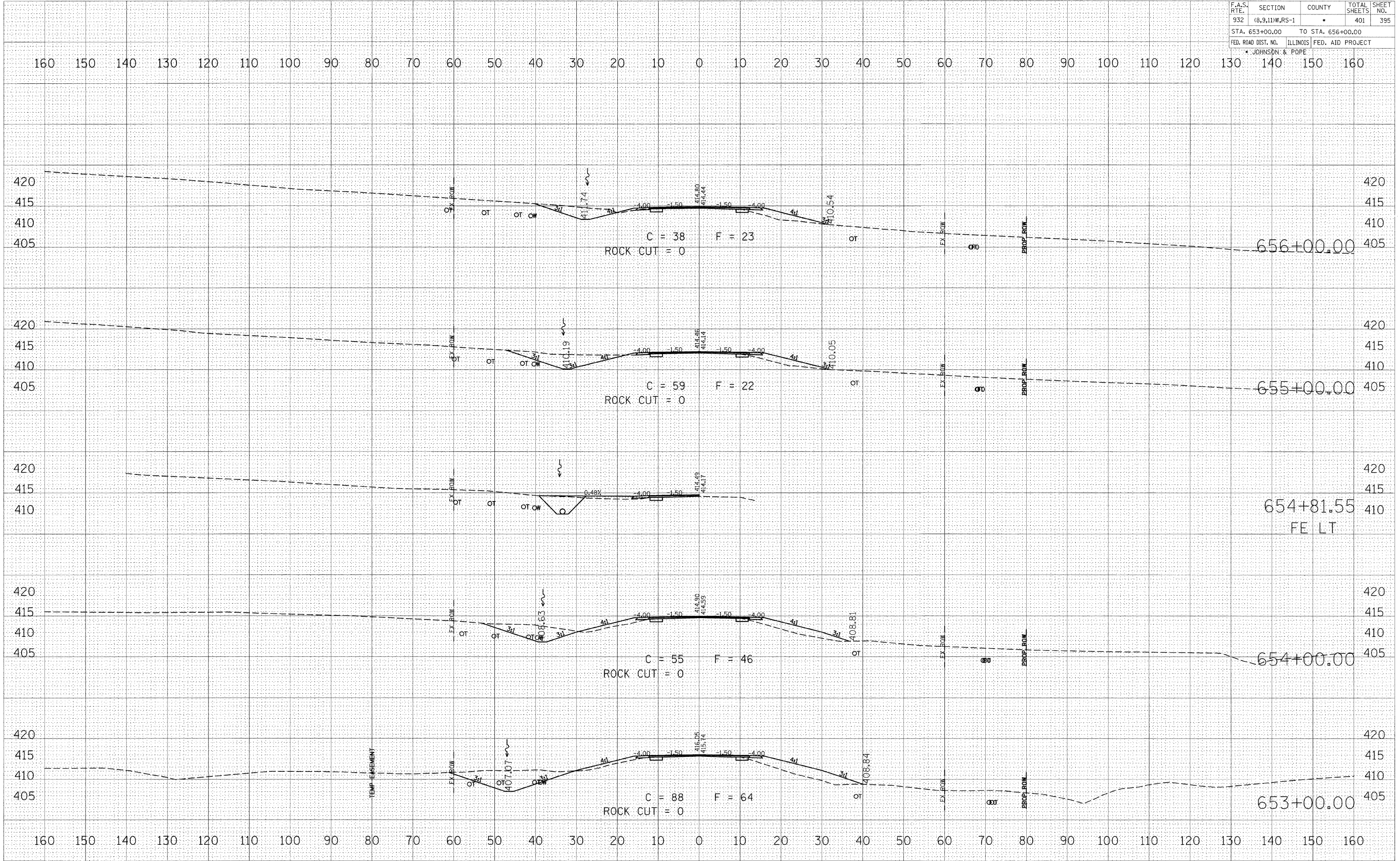

BY	DATE
ORIGINAL SURVEY	
PLOTTED	
TEMPLATE	
NOTE BOOK	
NO.	

PLOT DATE = #DATE*
PLOT SCALE = #SCALE*
USER NAME = #USER*