

NOTE:

1. UNLESS NOTED OTHERWISE, ALL STATIONS AND OFFSETS USED ARE TAKEN FROM EXISTING EB AND WB I-290 BASELINES.
2. FOR LEGEND SEE SHEET NO. 65

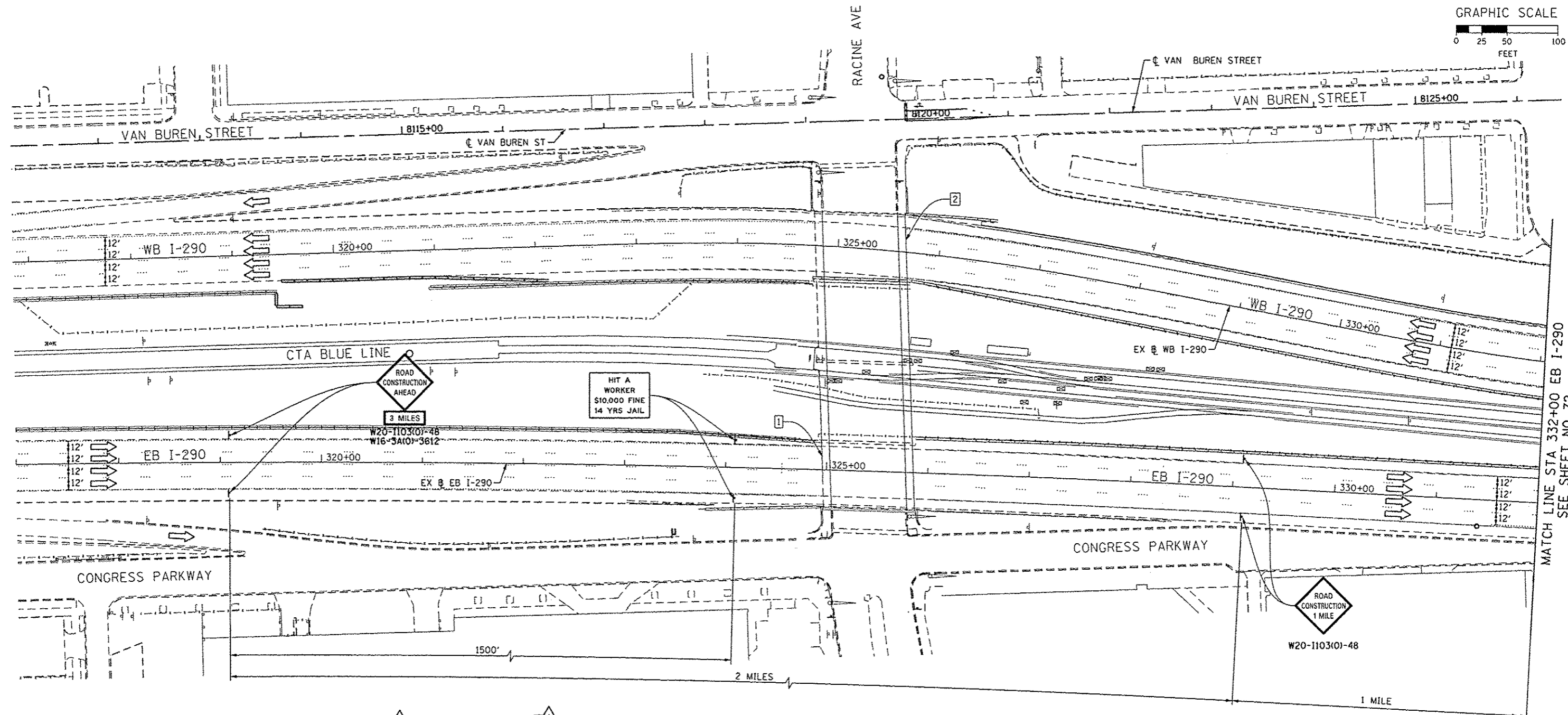
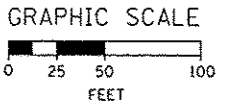

MATCH LINE STA 332+00 EB I-290
SEE SHEET NO. 72

1 EXISTING OVERHEAD SIGNS TO REMAIN

2 EXISTING OVERHEAD SIGNS TO REMAIN

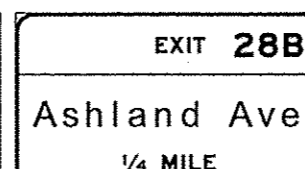
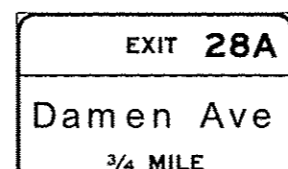
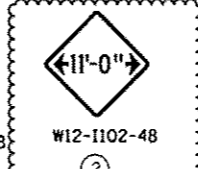
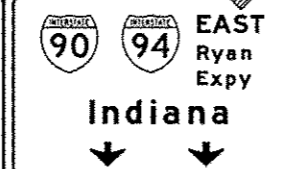
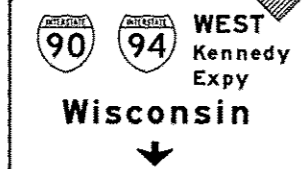
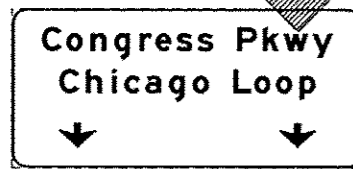

D:\60W26-Shr-Staging\A-ML-01
 USER NAME = PIMSARND
 PLOT SCALE = 50,0000 1/1 in.
 PLOT DATE = 10/14/2013

DESIGNED - OPS	REVISED - 10/15/2013
DRAWN - PHP	REVISED -
CHECKED - DBM	REVISED -
DATE - 9/15/13	REVISED -

STATE OF ILLINOIS
DEPARTMENT OF TRANSPORTATION

SUGGESTED STAGES OF CONSTRUCTION AND TRAFFIC CONTROL PLAN
MAINLINE STAGING 1A
 SCALE: 1" = 50' SHEET 1 OF 8 SHEETS STA. TO STA.

F.A.I. RTE.	SECTION	COUNTY	TOTAL SHEETS	SHEET NO.
90/94/290	2013-008R	COOK	559	71
CONTRACT NO. 60W26			ILLINOIS FED. AID PROJECT	

FILE PATH = p:\1\388833; p:\int\leason\loc\IPVAE\COMB\Documents\1\Americas\Transpor\station\60W26\9238_Circle\Phone_11\803_CAD\856_Readery\Sheet\60W26_Contract\0160W26-Shr-Staging\A-ML-01