

NOTE:

- UNLESS NOTED OTHERWISE, ALL STATIONS AND OFFSETS USED ARE TAKEN FROM EXISTING EB AND WB I-290 BASELINES.
- FOR LEGEND SEE SHEET NO. 65

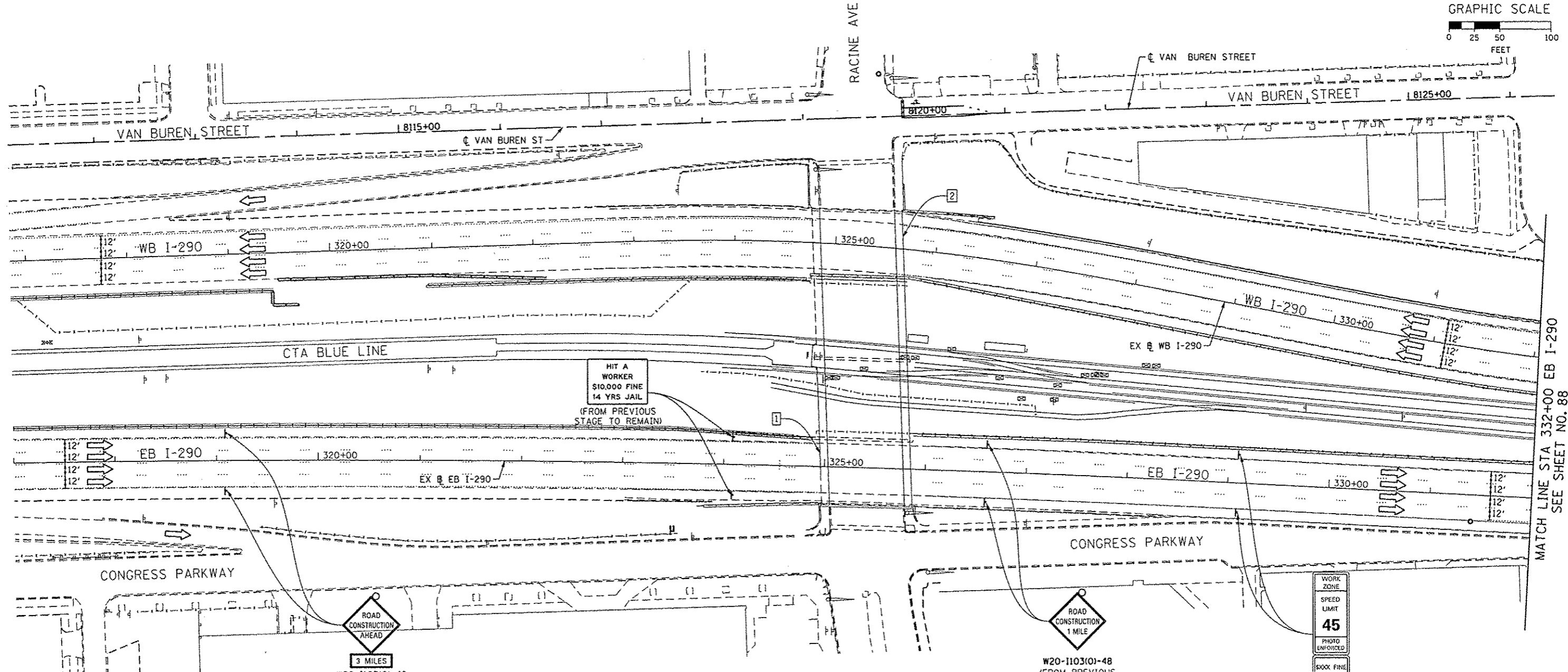
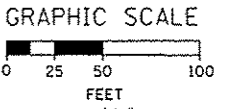

MATCH LINE STA 332+00 EB I-290
SEE SHEET NO. 88

1 EXISTING OVERHEAD SIGNS TO REMAIN

2 EXISTING OVERHEAD SIGNS TO REMAIN

Congress Pkwy
Chicago Loop

↓

↓

WEST Kennedy Expy
Wisconsin

↓

EAST Ryan Expy
Indiana

↓

ROAD CONSTRUCTION AHEAD

W20-1103(O)-48

1 (FROM PREVIOUS STAGE TO REMAIN)

← 12'-0" →

W12-1102-48

2 (FROM PREVIOUS STAGE TO REMAIN)

EXIT 28A

Damen Ave

3/4 MILE

EXIT 28B

Ashland Ave

1/4 MILE

WORK ZONE

SPEED LIMIT

45

PHOTO ENFORCED

BOOK FINE MINIMUM

W2-1115(O)-3618
R2-1-3648
R10-190P-3618
R2-1106-3618
(FROM PREVIOUS STAGE TO REMAIN)



D168W26-Sht-Staging2A-ML-81
USER NAME = PHSARNO
PLOT SCALE = 50.0000' / 1" = 100'
PLOT DATE = 10/15/2013

DESIGNED - OPS	REVISED - 10/15/2013
DRAWN - PHP	REVISED -
CHECKED - DBM	REVISED -
DATE - 9/15/13	REVISED -

STATE OF ILLINOIS
DEPARTMENT OF TRANSPORTATION

SUGGESTED STAGES OF CONSTRUCTION AND TRAFFIC CONTROL PLAN
MAINLINE STAGING 2A

SCALE: 1" = 50' SHEET 1 OF 8 SHEETS STA. TO STA.

F.A.I. RTE.	SECTION	COUNTY	TOTAL SHEETS	SHEET NO.
90/94/290	2013-008R	COOK	559	87
CONTRACT NO. 60W26			ILLINOIS FED. AID PROJECT	