

NOTE:

1. UNLESS NOTED OTHERWISE, ALL STATIONS AND OFFSETS USED ARE TAKEN FROM EXISTING NB AND SB I-90/94 BASELINES.
2. FOR LEGEND SEE SHEET NO. 65

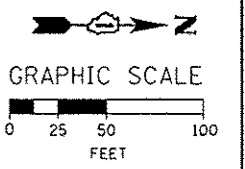
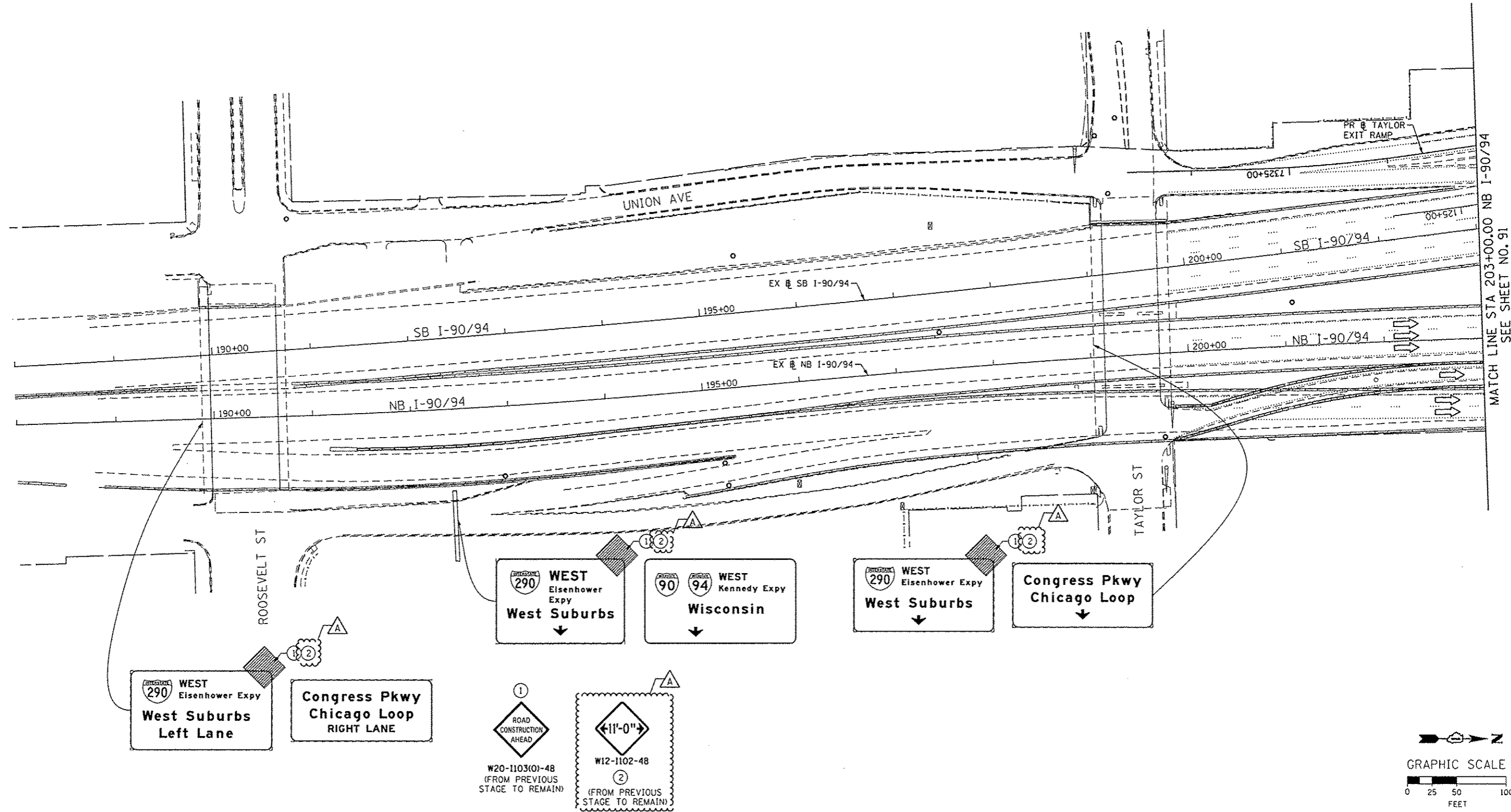

DISB026-Sht-Staging2A-ML-86	DESIGNED - OPS	REVISED - Δ 10/15/2013
USER NAME = PIMSARNO	DRAWN - PHP	REVISED -
PLOT SCALE = 50,000 / 1 in.	CHECKED - DBM	REVISED -
PLOT DATE = 10/15/2013	DATE - 9/15/13	REVISED -

**STATE OF ILLINOIS
DEPARTMENT OF TRANSPORTATION**

**SUGGESTED STAGES OF CONSTRUCTION AND TRAFFIC CONTROL PLAN
MAINLINE STAGING 2A**

SCALE: 1" = 50' SHEET 6 OF 8 SHEETS STA. TO STA.

F.A.I. RTE.	SECTION	COUNTY	TOTAL SHEETS	SHEET NO.
90/94/290	2013-008R	COOK	559	92
CONTRACT NO. 60W26				
ILLINOIS FED. AID PROJECT				

FILE PATH = G:\1\388235\p\int\seconline\local\PMAC\008\Documents\01_Americas\Tempor-to-tup\62269938_Circ\InPhase_11\0001_CAD\B06_Roadway\Sheet\60W26-Sht-Staging2A-ML-86