

FILE PATH: c:\388939\p\nt\seconon\line\local\p\MACD\20\Documents\RI\Americas\Transportation\62699338_Circle\Phase 1\N08_Cd\005_Roadway\Sheet\60W26_Contract\0160W26-At-Drain-Details-01

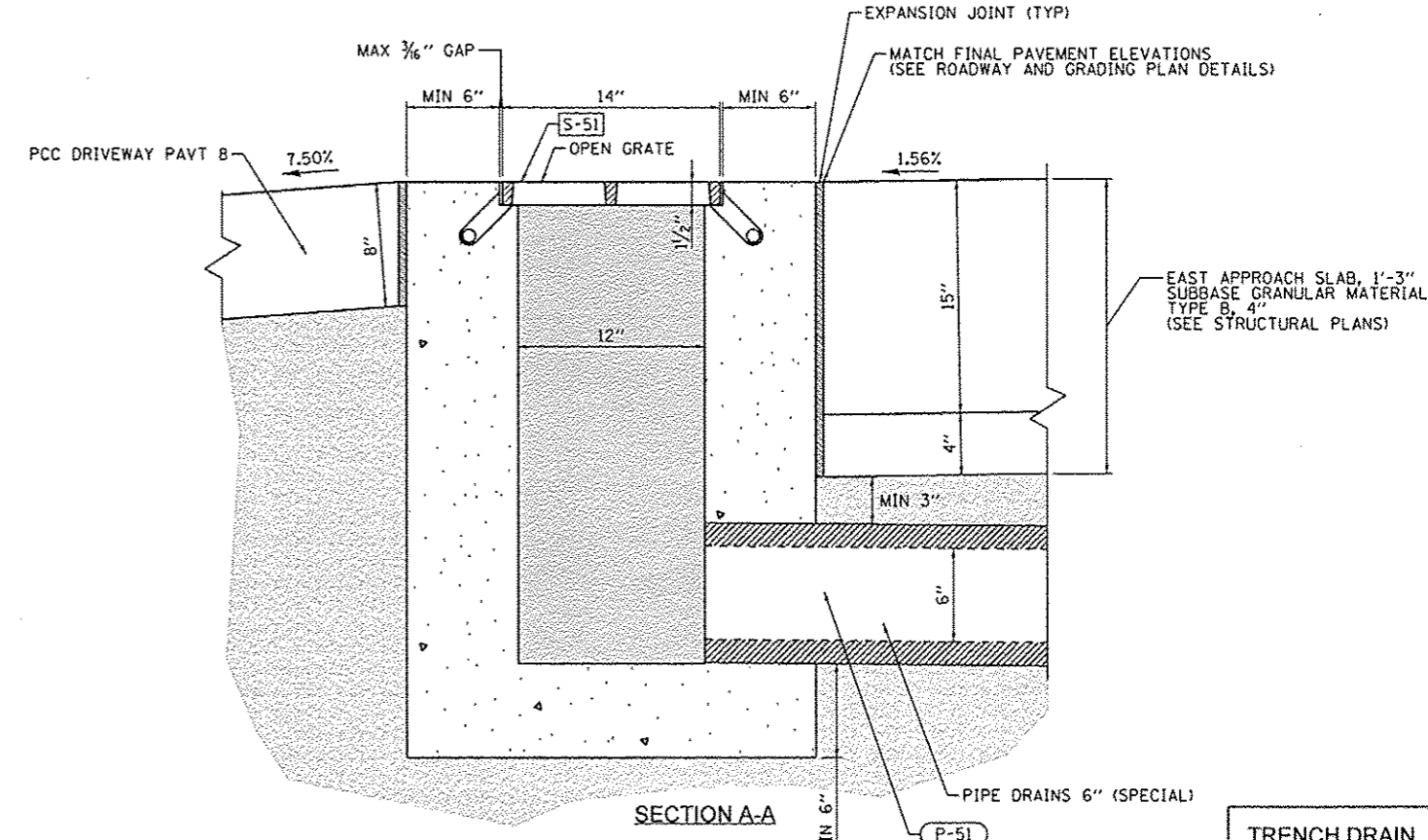

- NOTES:**
- SEE DRAINAGE SCHEDULES FOR RIM AND INVERT ELEVATIONS.
 - THE GRATE USED FOR THE TRENCH DRAIN WILL BE INCLUDED IN THE COST OF TRENCH DRAIN.
 - OUTLET PIPES AND PREFORMED CHANNEL INVERTS SHALL BE SLOPED AT 0.80% OR STEEPER TOWARD OUTLET REGARDLESS OF THE SURFACE SLOPE.
 - TRENCH EXCAVATION MUST ALLOW FOR A MINIMUM OF 6 INCHES OF CONCRETE TO BE PLACED UNDER AND ALONGSIDE THE TRENCH DRAIN SYSTEM.
 - TRENCH DRAINS SHALL BE IN ACCORDANCE WITH THE MANUFACTURERS DETAILS AND SPECIFICATIONS.
 - PROVIDE 1/2" EXPANSION JOINT WITH PREFORMED JOINT FILLER BETWEEN PAVEMENT AND TRENCH DRAIN ENCASMENT.

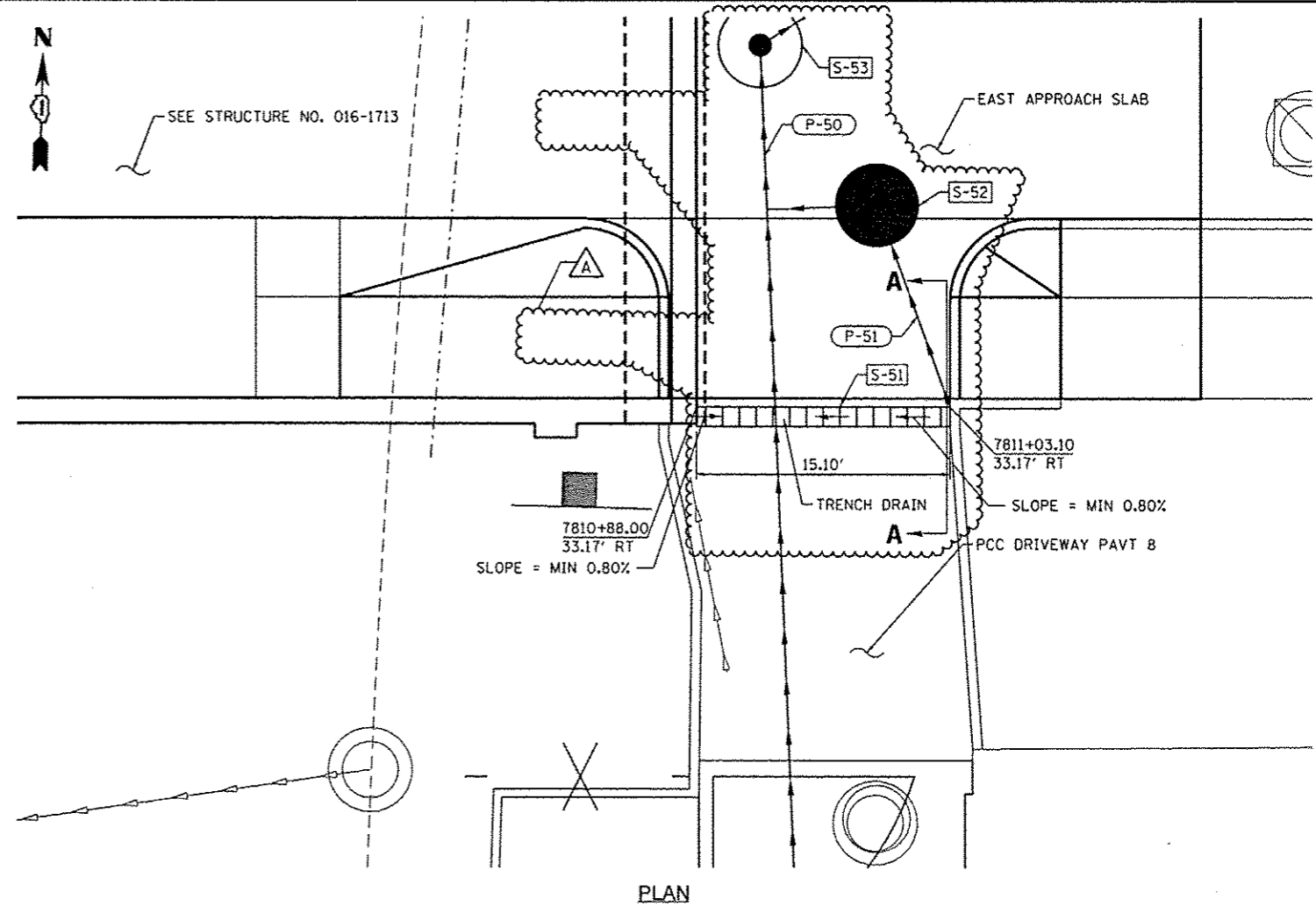

0160W26-At-Drain-Details-01
 USER NAME = chiuo
 PLOT SCALE = 5.0000' / 1" =
 PLOT DATE = 10/9/2013

DESIGNED - AFC	REVISED - 10/15/2013
DRAWN - AFC	REVISED -
CHECKED - DBM	REVISED -
DATE - 9/15/13	REVISED -

STATE OF ILLINOIS
 DEPARTMENT OF TRANSPORTATION

DRAINAGE DETAILS
 TRENCH DRAIN

SCALE: NTS SHEET 1 OF 1 SHEETS STA. TO STA.

F.A.I. RTE.	SECTION	COUNTY	TOTAL SHEETS	SHEET NO.
90/94/290	2013-008R	COOK	559	518
CONTRACT NO. 60W26				
ILLINOIS FED. AID PROJECT				

TRENCH DRAIN