

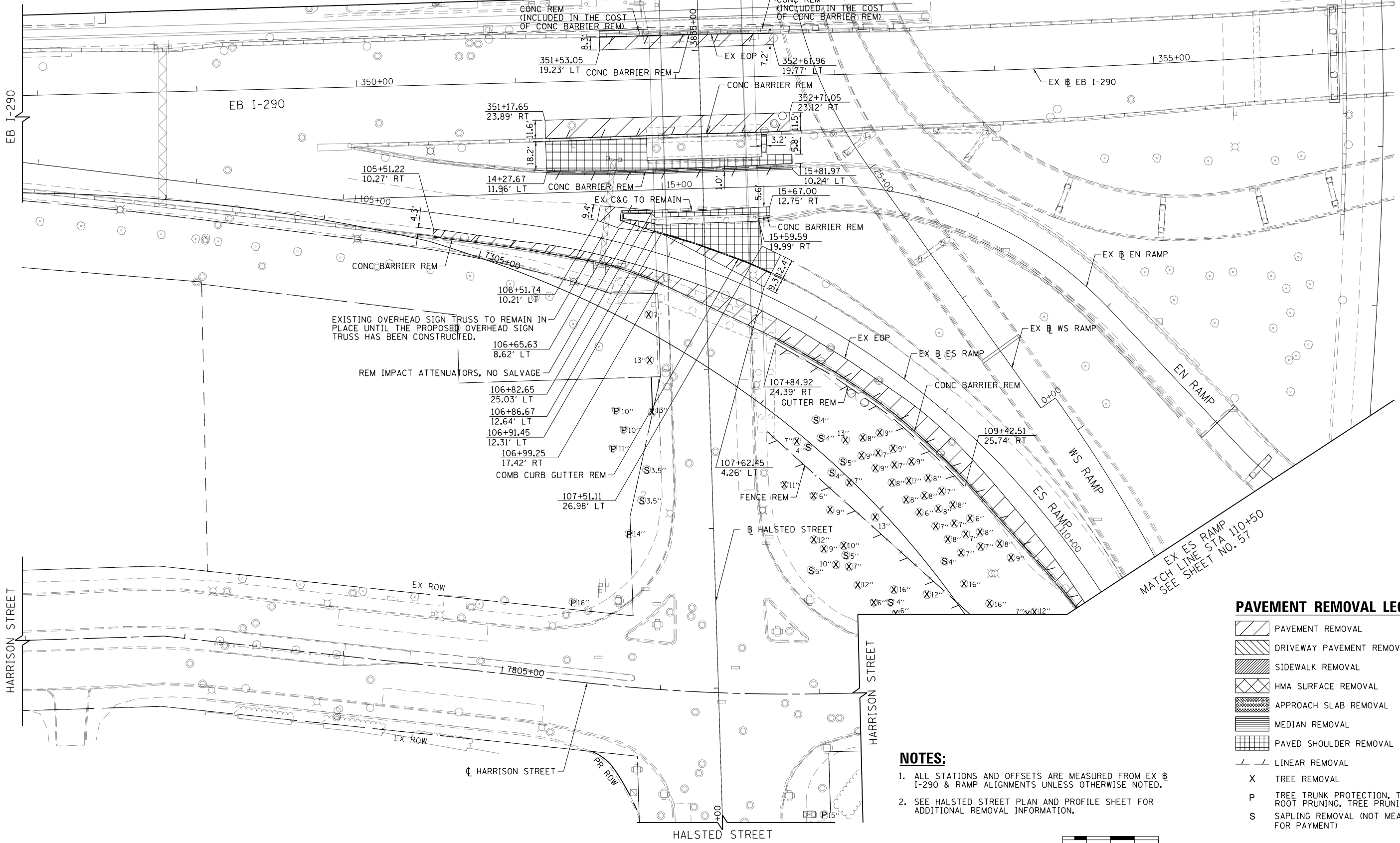

HALSTED STREET
MATCH LINE STA 3835+35
SEE SHEET NO. 51



EXISTING OVERHEAD SIGN TRUSS TO REMAIN IN PLACE UNTIL THE PROPOSED OVERHEAD SIGN TRUSS HAS BEEN CONSTRUCTED.

REM IMPACT ATTENUATORS, NO SALVAGE

NOTES:

1. ALL STATIONS AND OFFSETS ARE MEASURED FROM EX EB I-290 & RAMP ALIGNMENTS UNLESS OTHERWISE NOTED.
2. SEE HALSTED STREET PLAN AND PROFILE SHEET FOR ADDITIONAL REMOVAL INFORMATION.

PAVEMENT REMOVAL LEGEND

- PAVEMENT REMOVAL
- DRIVEWAY PAVEMENT REMOVAL
- SIDEWALK REMOVAL
- HMA SURFACE REMOVAL
- APPROACH SLAB REMOVAL
- MEDIAN REMOVAL
- PAVED SHOULDER REMOVAL
- LINEAR REMOVAL
- TREE REMOVAL
- TREE TRUNK PROTECTION, TREE ROOT PRUNING, TREE PRUNING
- SAPLING REMOVAL (NOT MEASURED FOR PAYMENT)

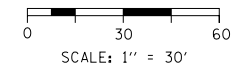

FILE PATH = c:\pwworking\luciano\work\2013\60W26-Sht-Plnprf-03.dgn



DI60W26-Sht-Plnprf-03.dgn	DESIGNED - YSK	REVISED -
USER NAME = kolorenz	DRAWN - YSK	REVISED -
PLOT SCALE = 30.0000' / in.	CHECKED - JLV	REVISED -
PLOT DATE = 9/12/2013	DATE - 9/15/13	REVISED -

**STATE OF ILLINOIS
DEPARTMENT OF TRANSPORTATION**

**ROADWAY REMOVAL PLAN
I-290**

SCALE: 1"=30' SHEET 3 OF 9 SHEETS STA. TO STA.

F.A.I. RTE. 90/94/290	SECTION 2013-008R	COUNTY COOK	TOTAL SHEETS 559	SHEET NO. 52
CONTRACT NO. 60W26			ILLINOIS FED. AID PROJECT	