

TRAFFIC CONTROL NOTES

1. Detour signing must be installed prior to closure of the Harrison Street Bridge.
2. The contractor is responsible for coordination with other road work in the area.
3. Coordinate with parking lot owner to close parking lot exit and direct lot traffic to an alternate exit to the east.

LEGEND

- WESTBOUND HARRISON DETOUR ROUTE
- EASTBOUND HARRISON DETOUR ROUTE
- ARROW BOARD
- TEMPORARY SIGN
- SIGN BARRICADE TYPE III
- ROADWAY DIRECTION

- ROAD CLOSED AHEAD
W20-3 48"x48"
- ROAD CLOSED 500 FT
W20-3 48"x48"
- DETOUR AHEAD
W20-2 48"x48"
- EAST HARRISON STREET
M3-2 24"x12"
- WEST HARRISON STREET
M3-4 24"x12"
- HARRISON STREET
CUSTOM SPECIAL BLACK LETTERS ON ORANGE BACKGROUND 24"x18"
- R3-1 24"x24"
- R3-2 24"x24"
- R11-1101 24"x18"
- ROAD CLOSED
R11-2 48"x30"
- END DETOUR
M4-8A 24"x18"
- ROAD CLOSED 3/4 MILES AHEAD LOCAL TRAFFIC ONLY
R11-3A 60"x30"
- M4-9R 24"x30"
- M4-9L 24"x30"
- M4-9 24"x30"
- M4-9L 30"x24"
- M4-9R 30"x24"
- ROAD CLOSED TO THRU TRAFFIC
R11-4 60"x30"
- M4-10L 48"x18"

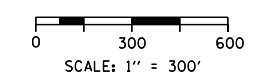
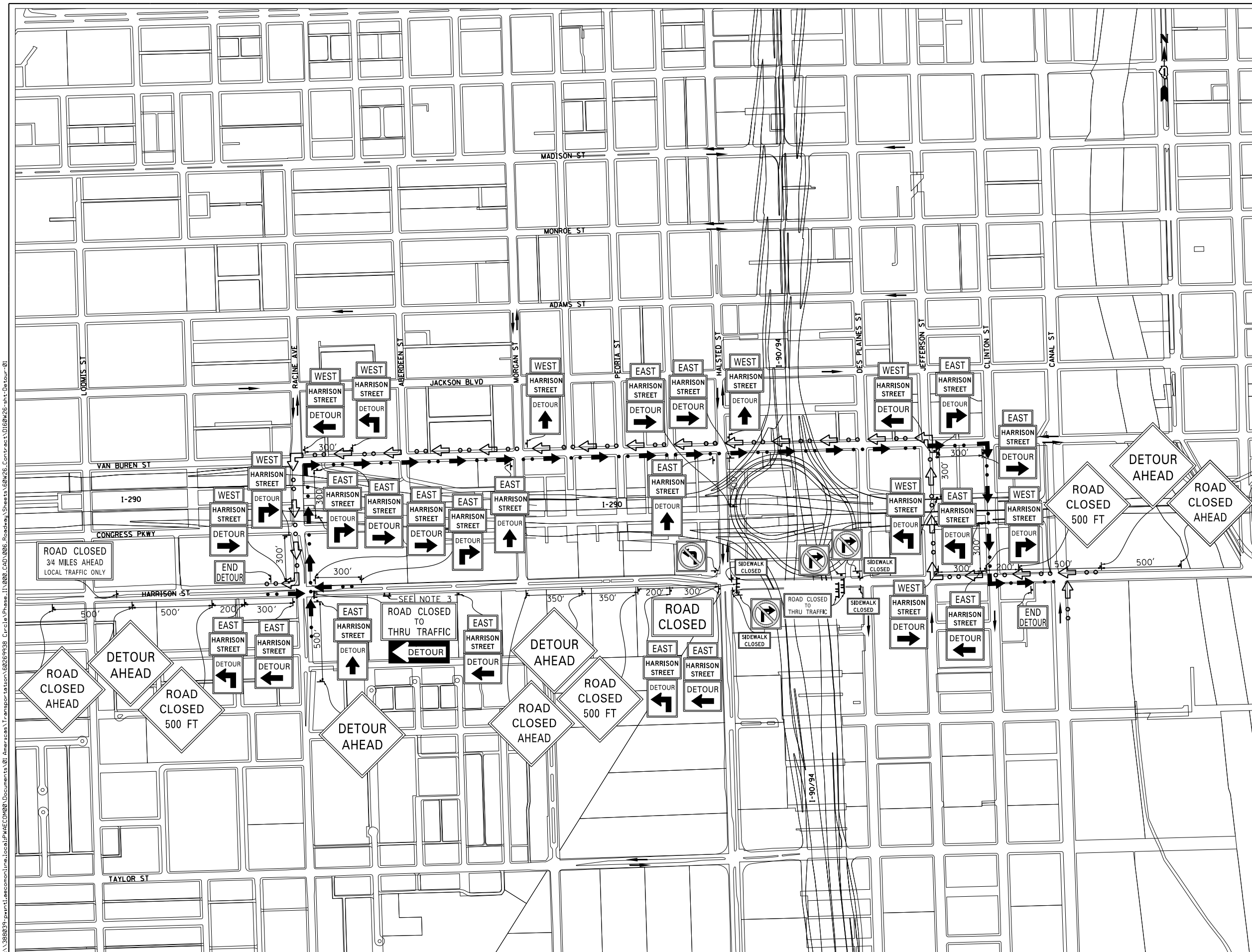

FILE PATH = p:\388935-p\m\l\escom\lme\local\p\AEC\000\Documents\01_Americas\Transportation\60269938_Circle Phase\11000_CAD\006_Roadway_Sheets\60W26-sht-Detour-01



D160W26-sht-Detour-01
 USER NAME = pimserno
 PLOT SCALE = 300.0000' / in.
 PLOT DATE = 9/15/2013

DESIGNED - JRB
 DRAWN - JRB
 CHECKED - SLW
 DATE - 9/15/13

REVISED -
 REVISED -
 REVISED -
 REVISED -

**STATE OF ILLINOIS
DEPARTMENT OF TRANSPORTATION**

**DETOUR PLAN
HARRISON STREET**

SCALE: 1"=300' SHEET 1 OF 1 SHEETS STA. TO STA. #PLN06

F.A.I. RTE.	SECTION	COUNTY	TOTAL SHEETS	SHEET NO.
90/94/290	2013-008R	COOK	559	59
				CONTRACT NO. 60W26
ILLINOIS FED. AID PROJECT				