

**NOTE:**

1. UNLESS NOTED OTHERWISE, ALL STATIONS AND OFFSETS USED ARE TAKEN FROM EXISTING EB AND WB I-290 BASELINES.
2. FOR LEGEND SEE SHEET NO. 65

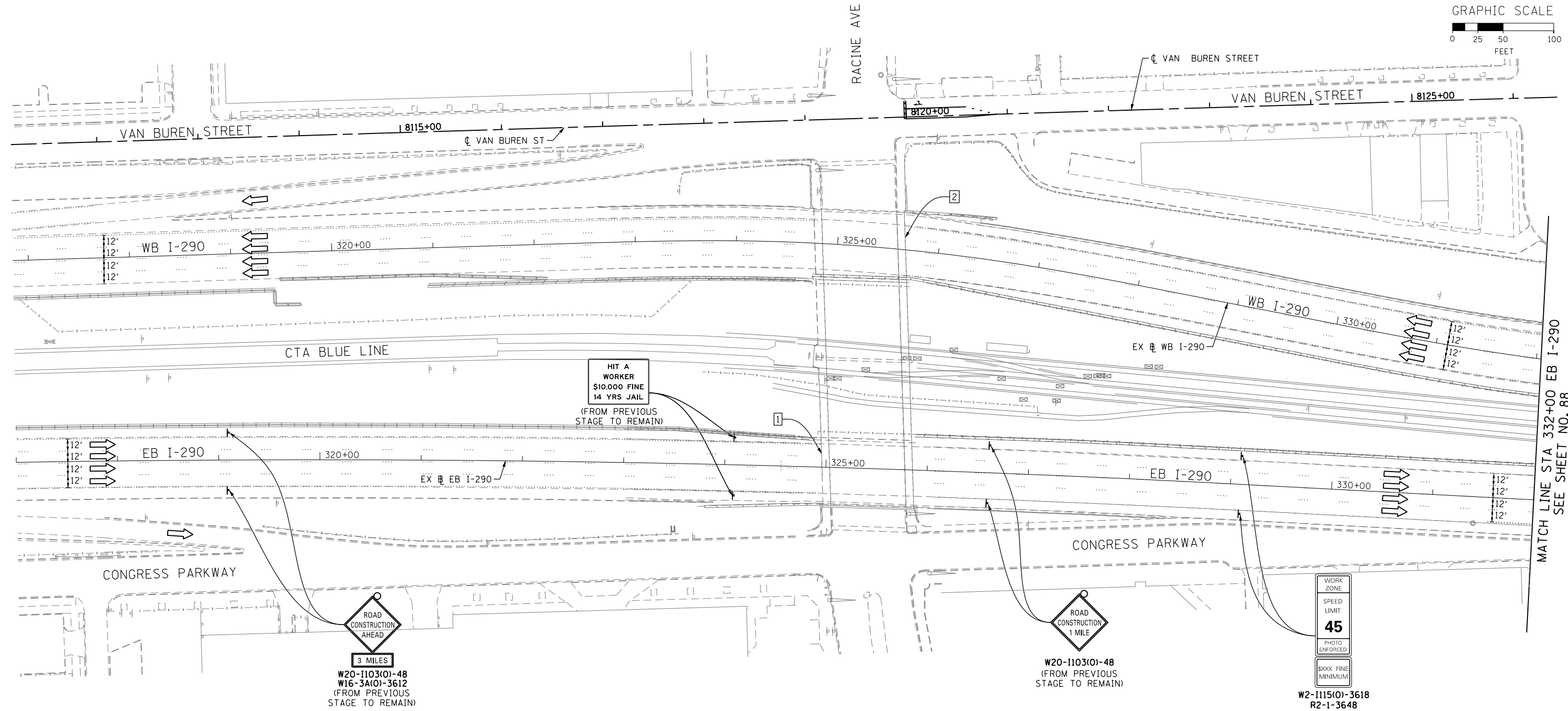
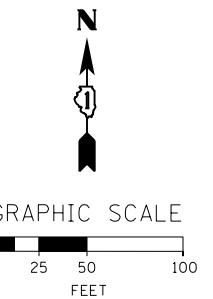

MATCH LINE STA 332+00 EB I-290  
SEE SHEET NO. 88

1 EXISTING OVERHEAD SIGNS TO REMAIN

2 EXISTING OVERHEAD SIGNS TO REMAIN

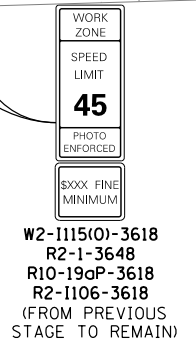
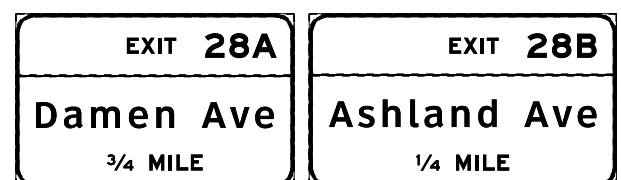
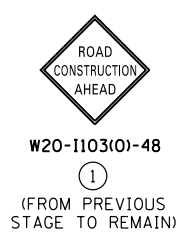
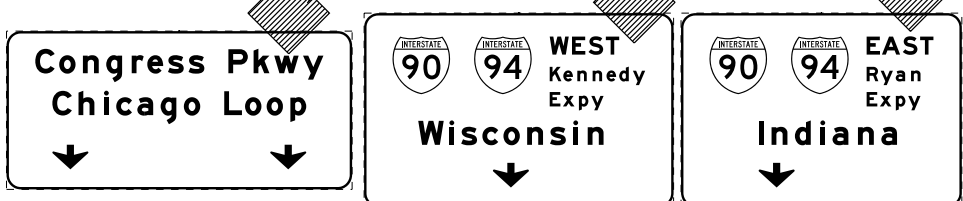

	D160W26-Sht-Staging2A-ML-01 USER NAME = pimsarno PLOT SCALE = 50.0000' / in. PLOT DATE = 9/15/2013	DESIGNED - OPS DRAWN - PHP CHECKED - DBM DATE - 9/15/13	REVISED - REVISED - REVISED - REVISED -
--	---	--	--

STATE OF ILLINOIS  
DEPARTMENT OF TRANSPORTATION

SUGGESTED STAGES OF CONSTRUCTION AND TRAFFIC CONTROL PLAN			
MAINLINE STAGING 2A			
SCALE: 1" = 50'	SHEET 1 OF 8 SHEETS	STA.	TO STA.

F.A.I. RTE.	SECTION	COUNTY	TOTAL SHEETS	SHEET NO.
90/94/290	2013-008R	COOK	559	87
				CONTRACT NO. 60W26
ILLINOIS FED. AID PROJECT				