

**NOTES:**

- BOTH THE TUNNEL AND THE ABANDONED CTA ELEVATED FOUNDATIONS ARE LOCATED BASED UPON RECORD DRAWINGS FROM BRIDGE AND EXPRESSWAY CONSTRUCTION.
- THE ABANDONED 5' BRICK WATER TUNNEL IS ESTIMATED TO BE BETWEEN 110 AND 120 YEARS OLD AND THE CONDITION IS UNKNOWN. THE TUNNEL HAS NOT BEEN UTILIZED FOR MANY YEARS.
- THE EXISTING BULKHEADS AND FILLED TUNNEL AT HALSTED STREET WERE INSTALLED OVER 50 YEARS AGO.
- BULKHEAD TUNNEL, CHICAGO (BY OTHERS) AT THE WESTERN LIMITS OF CLSM PLACEMENT WILL LIMIT THE INSTALLATION OF CONTROLLED LOW STRENGTH MATERIAL WITHIN THE AREAS OF PROPOSED RETAINING WALLS FOR FUTURE PROJECTS.
- WHERE GROUT HOLES ARE REQUIRED WITHIN THE TRAVEL LANES OF THE EISENHOWER EXPRESSWAY OR RAMPS, THE CLOSURE OF SUCH LANES SHALL BE MADE IN ACCORDANCE WITH THE REQUIREMENTS OF TRAFFIC CONTROL AND PROTECTION (EXPRESSWAYS), KEEPING THE EXPRESSWAYS OPEN TO TRAFFIC, AND FAILURE TO OPEN TRAFFIC LANES TO TRAFFIC. APPROPRIATE HIGHWAY STANDARDS MUST BE USED AS REQUIRED BASED UPON THE CHOSEN CONTRACTOR OPERATIONS AND SCHEDULE.
- WHERE GROUT HOLES ARE REQUIRED WITHIN THE TRAVEL LANES, SIDEWALKS OR PARKWAY OF PEORIA STREET, THE CONTRACTOR SHALL PROVIDE A PEDESTRIAN PROTECTION PLAN AND PARKING RESTRICTION PLAN FOR APPROVAL BY THE ENGINEER.
- RESTORATION OF GROUT HOLES SHOULD CONFORM TO PAVEMENT DESIGNS IDENTIFIED WITHIN THE TYPICAL SECTIONS.

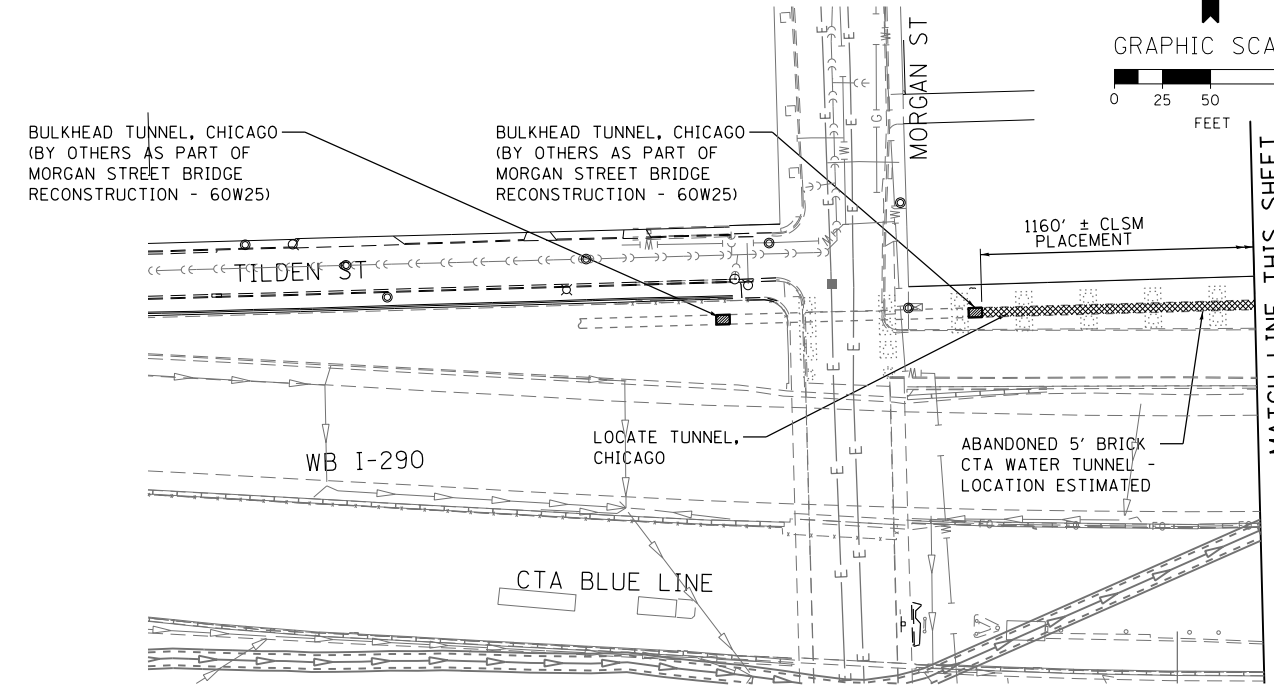
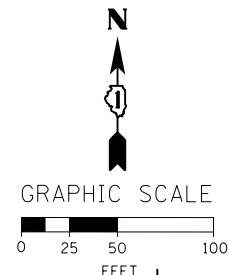

**LEGEND**

- EXISTING FILLED TUNNEL
- PROPOSED BULKHEAD TUNNEL, CHICAGO
- FILL WITH CONTROLLED LOW STRENGTH MATERIAL

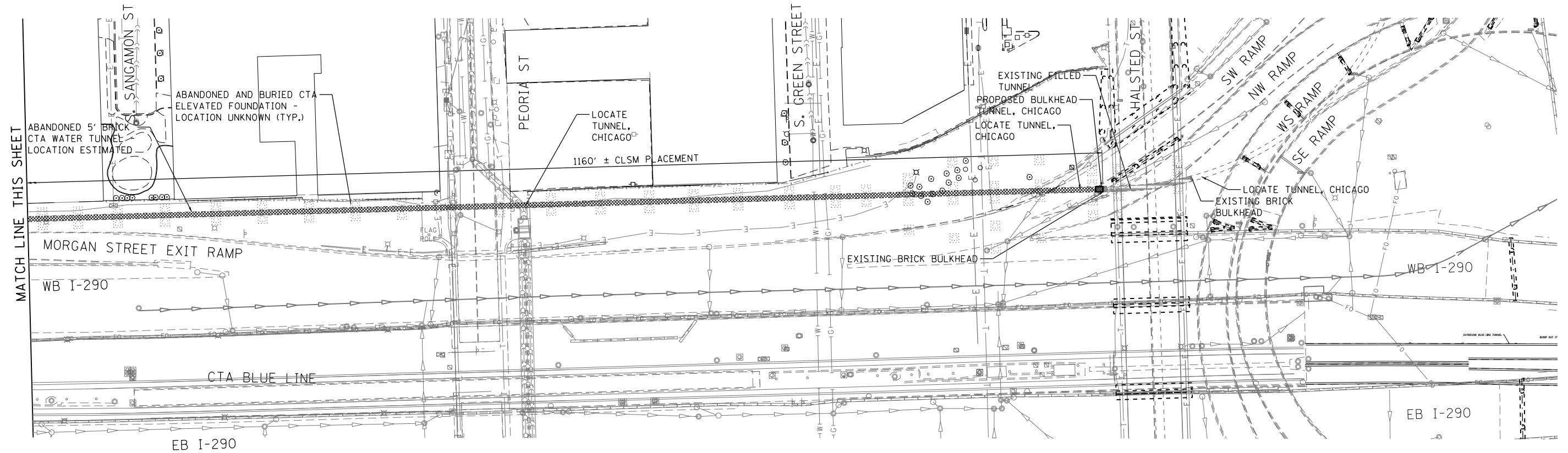

FILE PATH = p:\388035-p\m\1\escomon\line\local\p\AECD\000\Documents\01\_Americas\Transportation\60269938\_Circle\Phase\_1\1\000\_CAD\006\_Roadway\Sheets\60W26-sht-Tunnel\_Filling



DI60W26-sht-Tunnel\_Filling  
 USER NAME = chitua  
 PLOT SCALE = 50.0000' / in.  
 PLOT DATE = 8/17/2013

DESIGNED - MSC	REVISED -
DRAWN - MSC	REVISED -
CHECKED - DBM	REVISED -
DATE - 8/20/13	REVISED -

**STATE OF ILLINOIS  
 DEPARTMENT OF TRANSPORTATION**

**ABANDONED CTA WATER TUNNEL  
 BULKHEADING AND FILLING PLAN**

SCALE: 1" = 50' SHEET 1 OF 1 SHEETS STA. TO STA.

F.A.I. RTE. 90/94/290	SECTION 2013-008R	COUNTY COOK	TOTAL SHEETS 559	SHEET NO. 154
CONTRACT NO. 60W26				
ILLINOIS FED. AID PROJECT				