

NOTES:

1. SEE DRAWING E-01 FOR IDOT ELECTRICAL SYMBOLS.
2. THE EXISTING UTILITY SERVICE TO THE IDOT COMMUNICATIONS HUT SHALL BE REMOVED. THE SERVICE SHALL NOT BE DISCONNECTED AND THE BRIDGE DEMOLITION WORK STARTED UNTIL THE PROPOSED TEMPORARY SERVICE FEED TO THE HUT HAS BEEN INSTALLED, ENERGIZED, TESTED AND APPROVED BY IDOT. THE PROPOSED TEMPORARY SERVICE FEED WORK IS SHOWN ON DRAWING E-03.

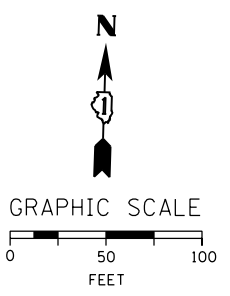
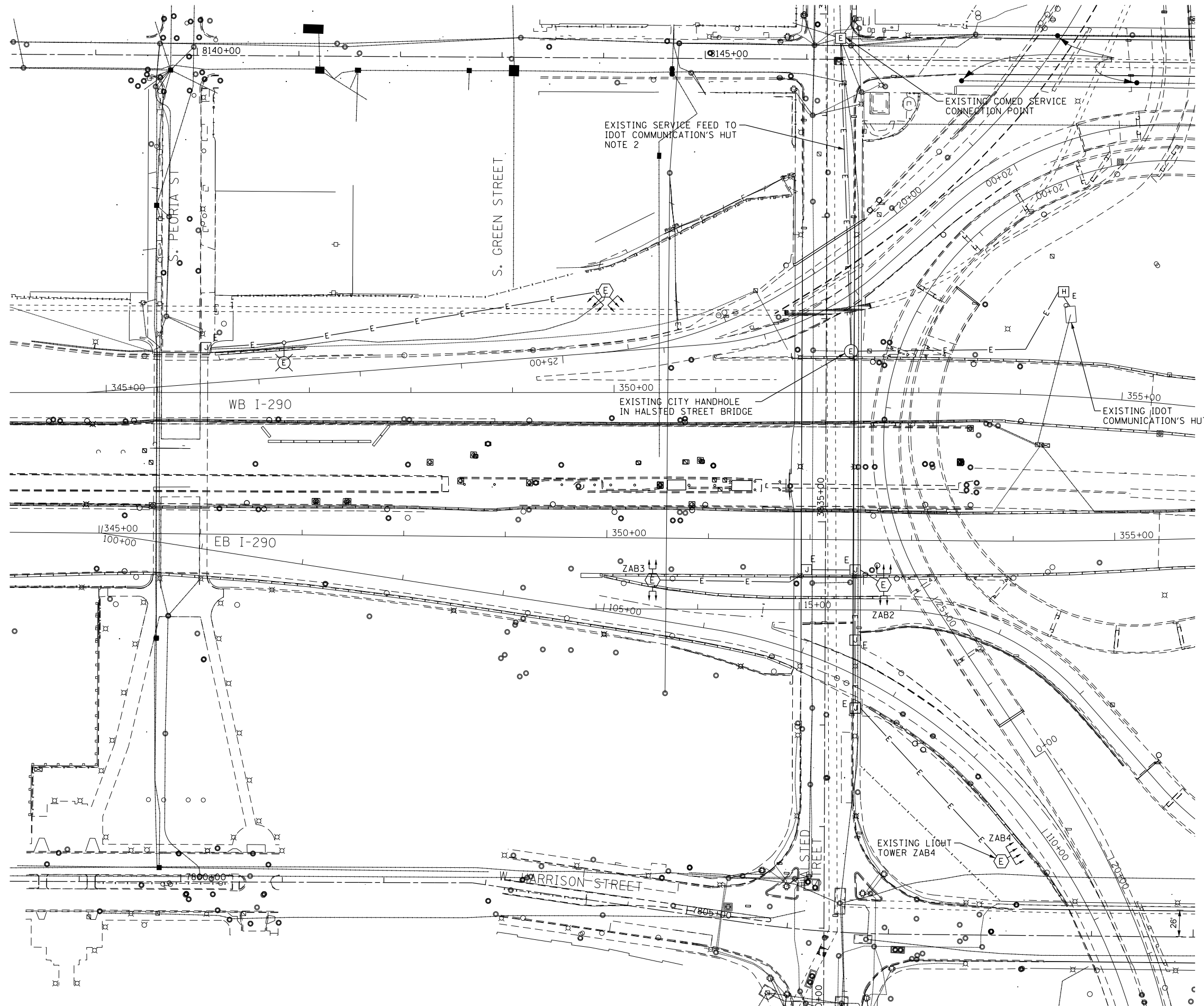

E-02

FILE PATH = p:\38803\p\m\l\escom\line\local\p\AECOM\Documents\01_Americas\Transportation\60269938_Circle\Phase_1\1000_CAD\01E_Electrical\Sheets\60W26-Contract\160W26-sht-Light-02



D160W26-sht-Light-02
 USER NAME = myersc
 PLOT SCALE = 50.0000' / in.
 PLOT DATE = 8/15/2013

DESIGNED - WDS	REVISED -
DRAWN - CAM	REVISED -
CHECKED - WDS	REVISED -
DATE - 8/20/13	REVISED -

**STATE OF ILLINOIS
 DEPARTMENT OF TRANSPORTATION**

**I-290 EXISTING/DEMOLITION
 LIGHTING PLAN**

SCALE: 1"=50' SHEET 2 OF 22 SHEETS STA. TO STA.

F.A.I. RTE.	SECTION	COUNTY	TOTAL SHEETS	SHEET NO.
90/94/290	2013-008R	COOK	559	225
CONTRACT NO. 60W26				
ILLINOIS FED. AID PROJECT				