

**NOTES:**

See sheet S1-25 of S1-48 for Detail A.  
 Approach slab concrete shall be paid for as Concrete Superstructure.  
 Approach footing concrete shall be paid for as Concrete Structures.  
 Reinforcement shall be paid for as Reinforcement Bars, Epoxy Coated.  
 For v(E) bar details, see sheet S1-39.  
 The approach footing maximum applied service bearing pressure (Qmax) = 2.0 ksf.  
 For bar splicer details, see sheet S1-45.  
 Cost of excavation for approach footing included with Concrete Structures.  
 For Granular Backfill for Structures details, see sheet S1-03.  
 V.I.F. = Contractor to verify in field.

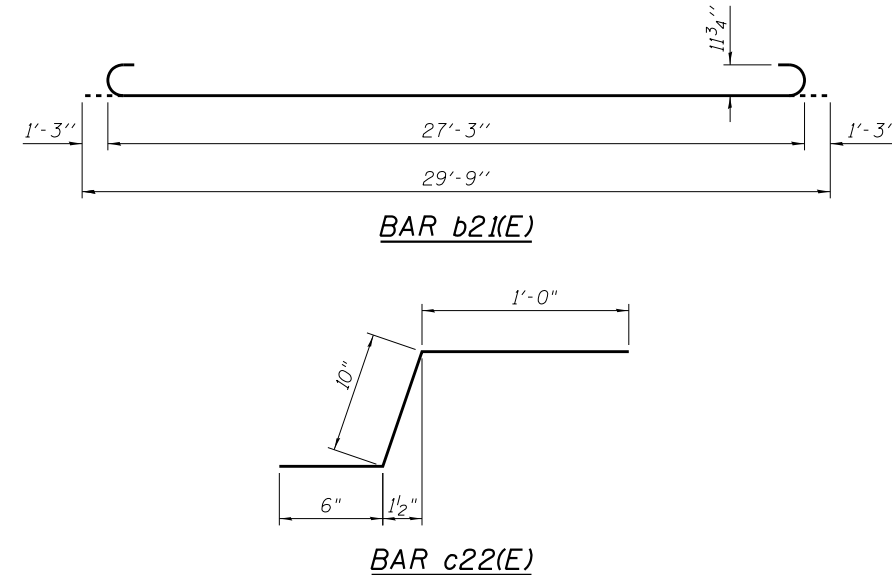
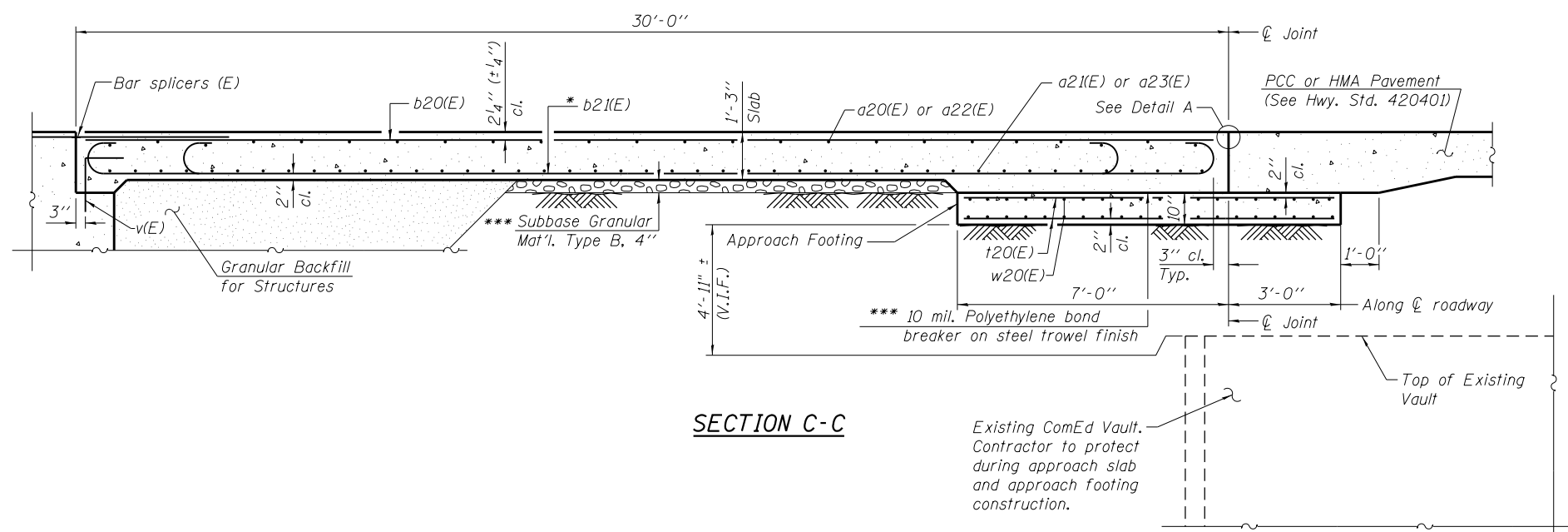

\* Tilt #9 b21(E) bars as required to maintain clearance.

\*\*\* Cost included with Concrete Superstructure.

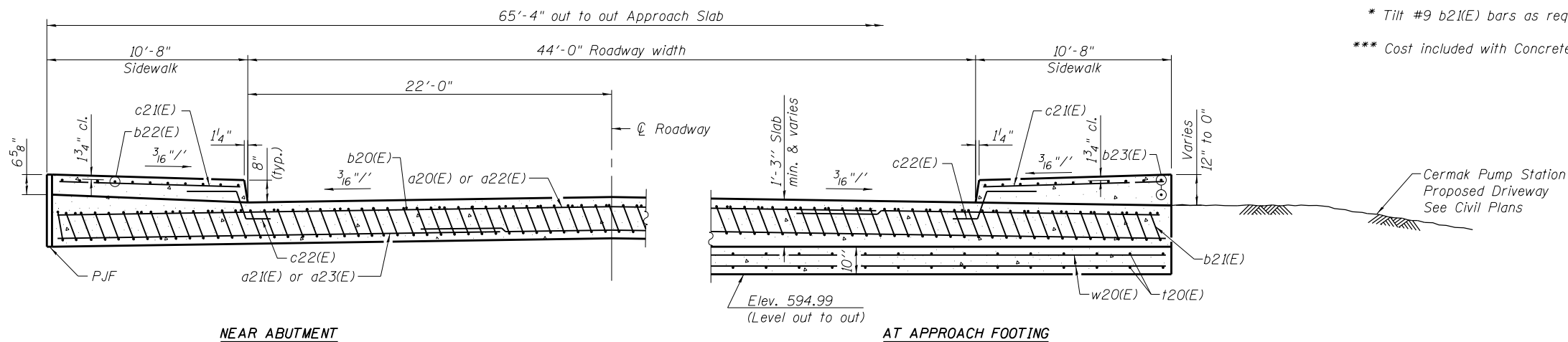

NEAR ABUTMENT

AT APPROACH FOOTING

**SECTION D-D**

(See Plan for dimensions not shown)

**BILL OF MATERIAL**

Bar	No.	Size	Length	Shape
a20(E)	25	#4	40'-0"	—
a21(E)	46	#5	28'-3"	—
a22(E)	25	#4	27'-7"	—
a23(E)	46	#5	40'-0"	—
a24(E)	8	#5	3'-6"	—
b20(E)	53	#4	29'-8"	—
b21(E)	157	#9	29'-9"	⌋
b22(E)	11	#5	29'-8"	—
b23(E)	12	#5	11'-5"	—
c21(E)	44	#5	10'-4"	—
c22(E)	44	#5	2'-4"	⌋
t20(E)	132	#4	9'-8"	—
w20(E)	80	#5	34'-2"	—
Concrete Superstructure			Cu. Yd.	103
Concrete Structures			Cu. Yd.	21
Reinforcement Bars, Epoxy Coated			Pound	26140
Protective Coat			Sq. Yd.	205
Bridge Deck Grooving			Sq. Yd.	159

0161713-60W26-S26-Appr Slab



USER NAME = dunkerleyb	DESIGNED - EJO	REVISED
PLOT SCALE = N.T.S.	CHECKED - ATB	REVISED
PLOT DATE = 9/15/2013	DRAWN - BRD	REVISED
	CHECKED - EJO	REVISED

STATE OF ILLINOIS  
DEPARTMENT OF TRANSPORTATION

EAST APPROACH SLAB DETAILS  
STRUCTURE NO. 016-1713

SHEET NO. S1-26 OF S1-48 SHEETS

F.A.I. RTE. 90/94/290	SECTION 2013-008R	COUNTY COOK	TOTAL SHEETS 559	SHEET NO. 276
CONTRACT NO. 60W26			ILLINOIS FED. AID PROJECT	