

**ANCHOR BOLT LAYOUT**

2x2-#5 s112(E) bars @ 4" cts. T&BEE\*  
 2x2-#5 s113(E) bars @ 4" cts. T&BEE\*  
 2x2-#5 s114(E) bars @ 4" cts. T&BEE\*  
 2x2-#5 s115(E) bars @ 4" cts. T&BEE\*

\*T&BEE = Top and Bottom Each End

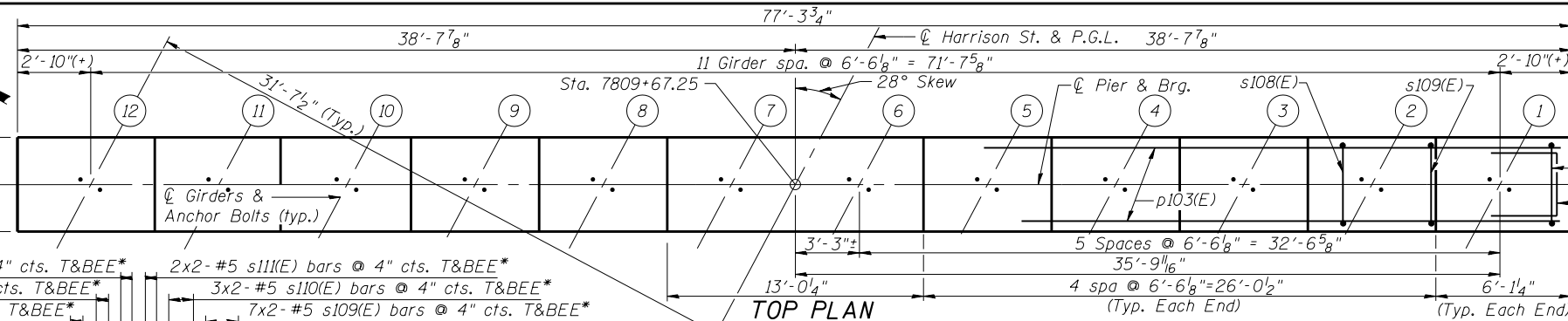

**TOP PLAN**

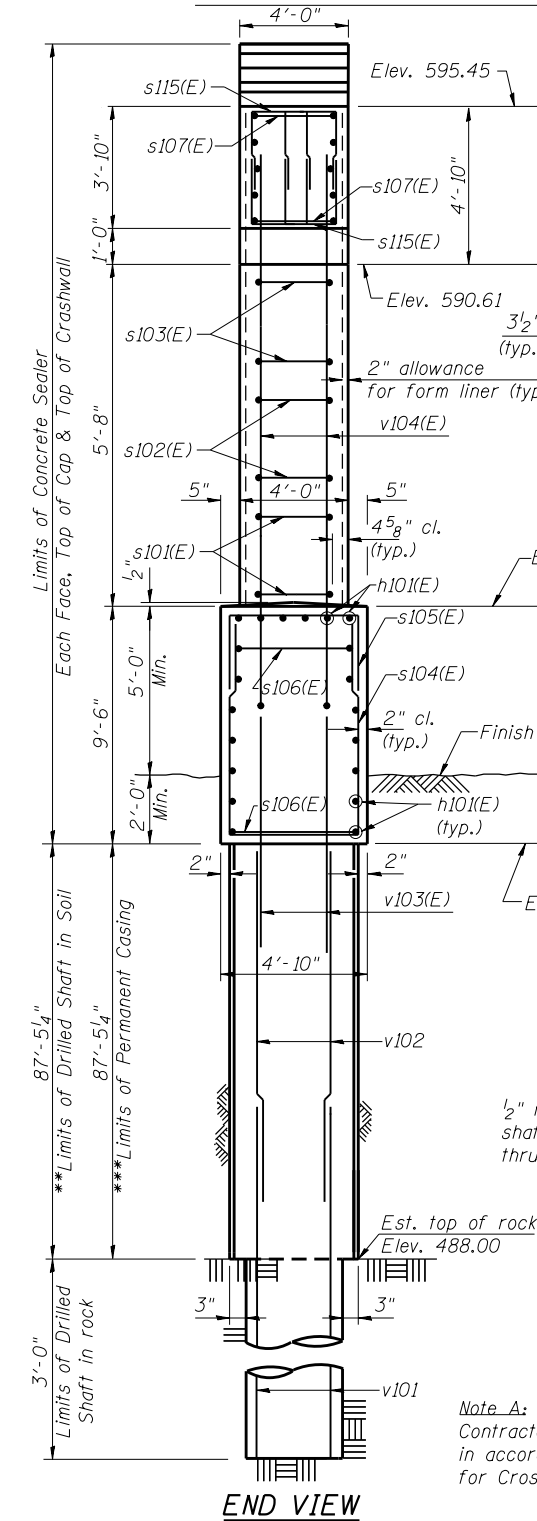

**END VIEW**

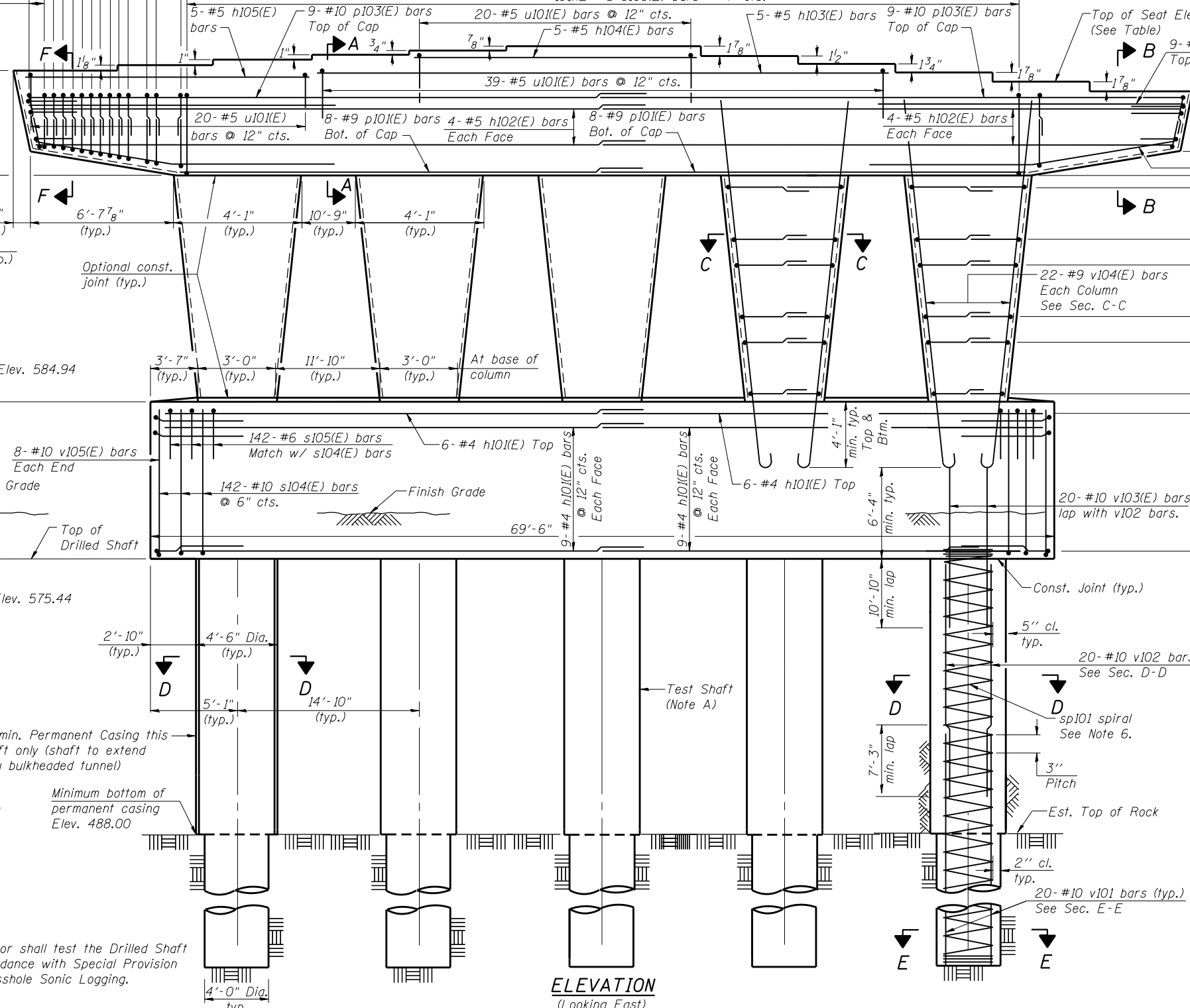

**ELEVATION**  
(Looking East)

- NOTES:**
1. Space reinforcement in cap to miss anchor bolts.
  2. Pour steps monolithically with cap.
  3. For section cuts see next sheet.
  4. For Anchor Bolt Details see sheet S1-33.
  5. Bars noted thus, 3x2-#5 indicates 3 lines of bars with 2 lengths of bars per line.
  6. #6 sp101 spiral, each drilled shaft
    1. Provide 1/2 extra turns, shop welded together per AWS D1.4 top and bottom. Extend spiral 2" into crashwall. Provide 4-#4 spacers or equivalent.
    2. When splicing spiral reinforcement is necessary, the spiral shall be provided with 1/2 extra turns at the ends to be spliced. These additional turns shall either be welded together according to AWS D1.4 or shall both terminate with a 135° standard hook.

**TYP. MIN. BAR LAP**

- (Unless Noted Otherwise)
- #4 bar = 2'-7"
  - #5 bar = 3'-3"
  - #9 bar = 8'-7"
  - #10 bar = 10'-10"
  - #11 bar = 13'-4"

**TOP OF SEAT ELEVATION**

Girder No.	Seat Elevation
1	595.11
2	595.27
3	595.42
4	595.56
5	595.69
6	595.85
7	595.85
8	595.78
9	595.71
10	595.63
11	595.54
12	595.45

\*\* The quantities and reinforcement detailing are based on the top of shaft and the estimated top of rock elevations shown and may change based on the actual top of rock elevations encountered at each shaft and the final top of shaft elevation.

\*\*\* Contractor may need to increase the casing thickness to withstand the installation process. The Estimated Top of Rock/Bottom of Permanent Casing Elevation is shown. The limits of casing shall be adjusted as necessary, and as approved, such that the actual installed casing length extends to the as-encountered top of rock at each shaft. See Article 516.06(d) of the Standard Specifications.



USER NAME = dunkerleyb	DESIGNED - EJO	REVISED
PLOT SCALE = N.T.S.	CHECKED - ATB	REVISED
PLOT DATE = 9/15/2013	DRAWN - BRD	REVISED
	CHECKED - EJO	REVISED

STATE OF ILLINOIS  
DEPARTMENT OF TRANSPORTATION

PIER PLAN AND ELEVATION  
STRUCTURE NO. 016-1713

F.A.I. RTE. 90/94/290	SECTION 2013-008R	COUNTY COOK	TOTAL SHEETS 559	SHEET NO. 292
CONTRACT NO. 60W26			ILLINOIS FED. AID PROJECT	

SHEET NO. S1-42 OF S1-48 SHEETS