

STAGE I POURING SEQUENCE

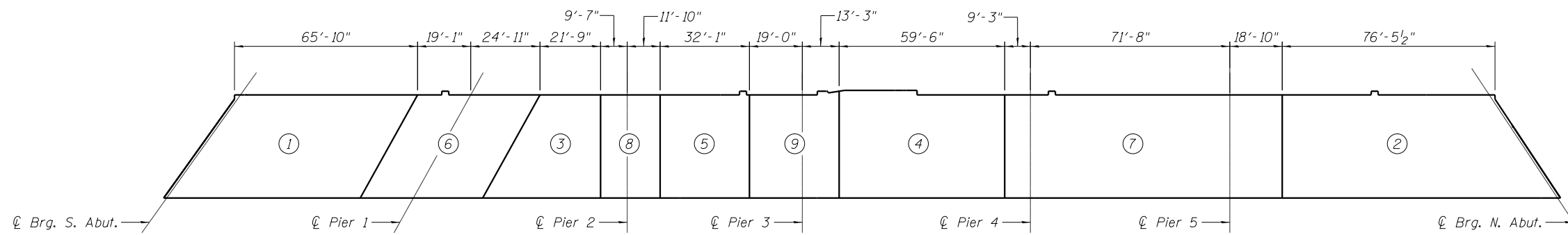

STAGE II POURING SEQUENCE

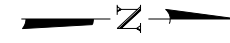
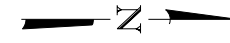

DECK POURING SEQUENCE

When the deck pour is stopped for the day at one or more of the transverse Bonded Construction Joints in the Deck Pouring Sequence as shown, the next pour shall not be made until both of the following requirements are met:

1. At least 72 hours shall have elapsed from the end of the previous pour.
2. The concrete strength shall have attained a minimum flexural strength of 650 psi or a minimum compressive strength of 3500 psi.

Concrete pours shall follow the numerical order shown in the pouring sequence. Deviation from this pour sequence requires approval from the Engineer.

Note: Dimensions along the existing CTA station are taken from survey. Contractor to field verify dimensions.

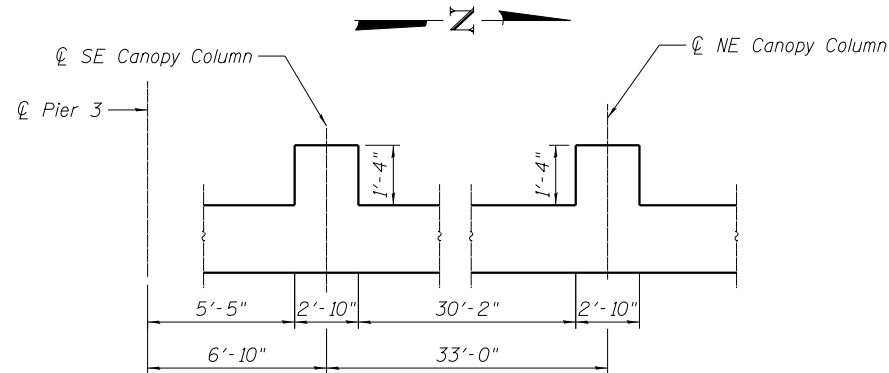

EAST CANOPY SUPPORT DETAIL

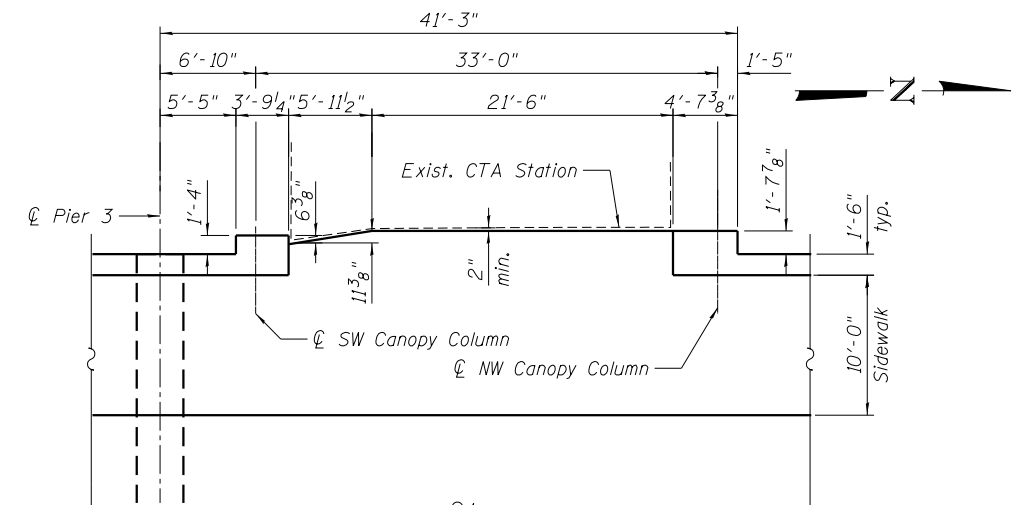

DECK OVERHANG DETAIL AT CTA STATION

4/3/2017 PM 0161716-60W26-S031-Deck_Detail2.dgn



USER NAME = rlschultz	DESIGNED - WJC	REVISED
	CHECKED - DL	REVISED
PLOT SCALE = 24:0.0028 ' : ' / in.	DRAWN - WJC/KAH	REVISED
PLOT DATE = 9/15/2013	CHECKED - DL	REVISED

STATE OF ILLINOIS
DEPARTMENT OF TRANSPORTATION

SUPERSTRUCTURE DETAILS 2
STRUCTURE NO. 016-1716

SHEET NO. S2-31 OF S2-81 SHEETS

F.A.U. RTE.	SECTION	COUNTY	TOTAL SHEETS	SHEET NO.
3730	2013-008R	COOK	559	391
CONTRACT NO. 60W26				

ILLINOIS FED. AID PROJECT