

PLAN

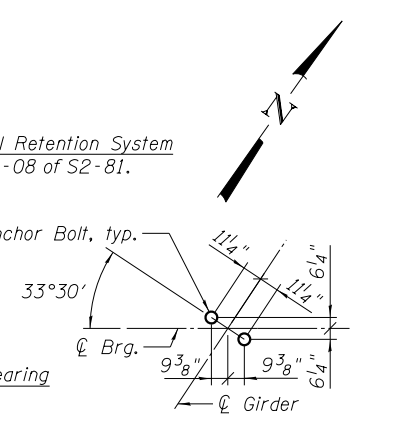

ANCHOR BOLT LAYOUT

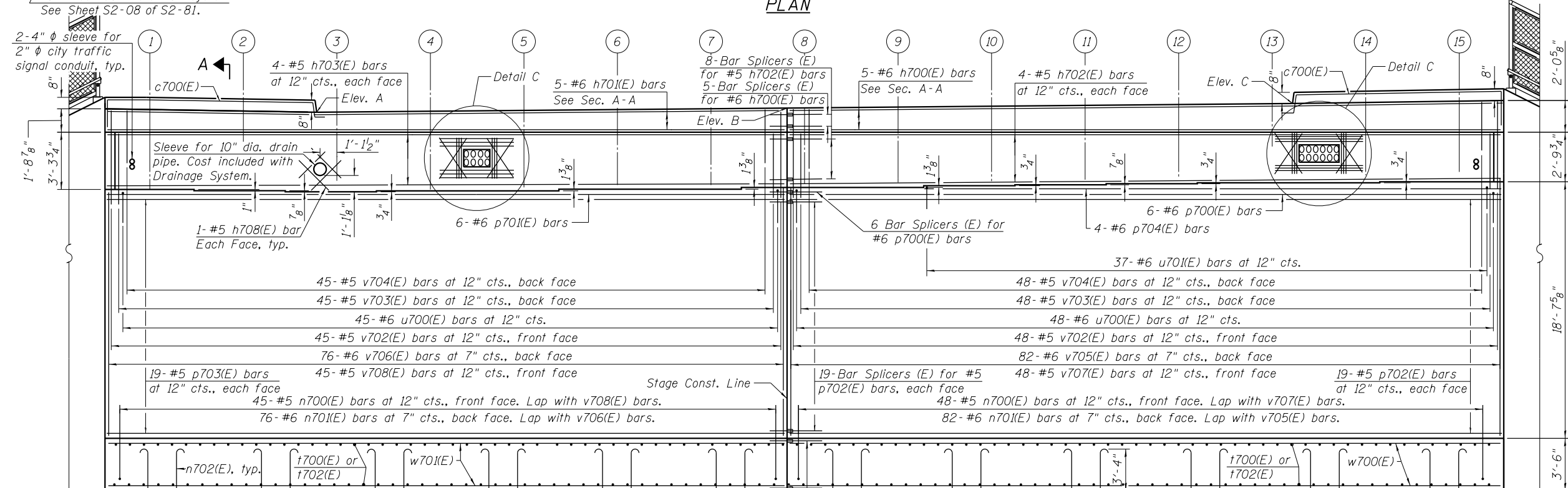

ELEVATION

TOP OF SEAT ELEVATIONS

Girder No.	Seat Elevation
1	589.69
2	589.61
3	589.54
4	589.60
5	589.60
6	589.71
7	589.71
8	589.82
9	589.82
10	589.94
11	590.00
12	590.07
13	590.13
14	590.13
15	590.19

TOP OF BACK WALL ELEVATIONS

POINTS	FRONT FACE	BACK FACE
A - West Curb Line	594.38	594.34
B - Stage Const. Line	594.65	594.61
C - East Curb Line	594.99	594.96

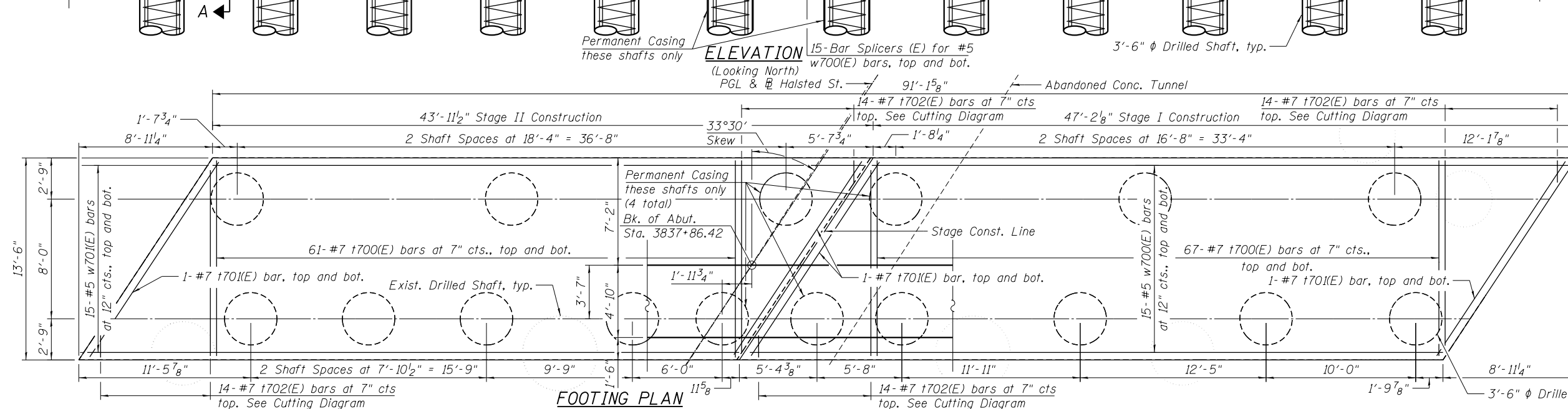

FOOTING PLAN

Notes:
 For Section A-A and Detail C, see Sheet S2-56.
 For Detail A and Detail D, see Sheet S2-57.
 Existing drilled shafts are belled at the base. Contractor shall drill through the bells to place the proposed shafts.

4:33:38 PM 0161716-60W26-S054-Abutment_NorthP&E.dgn



USER NAME = rlschultz	DESIGNED - JRM	REVISD
PLOT SCALE = 4:0.0005 ' / in.	CHECKED - SAS	REVISD
PLOT DATE = 9/15/2013	DRAWN - MTS	REVISD
	CHECKED - MDS	REVISD

**STATE OF ILLINOIS
DEPARTMENT OF TRANSPORTATION**

**NORTH ABUTMENT PLAN AND ELEVATION
STRUCTURE NO. 016-1716**

SHEET NO. S2-55 OF S2-81 SHEETS

F.A.U. RTE.	SECTION	COUNTY	TOTAL SHEETS	SHEET NO.
3730	2013-008R	COOK	559	415
CONTRACT NO.			60W26	
ILLINOIS FED. AID PROJECT				