

**AUXILIARY LANE MARKINGS**

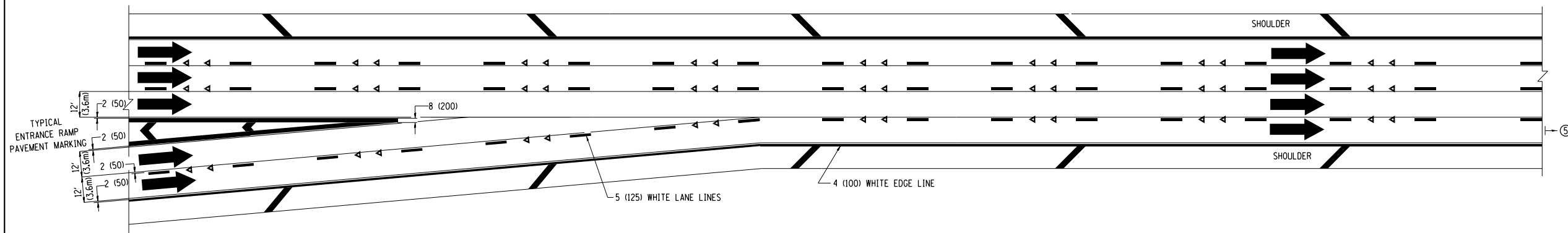

**TWO LANE ENTRANCE RAMP WITH MERGE MARKINGS**

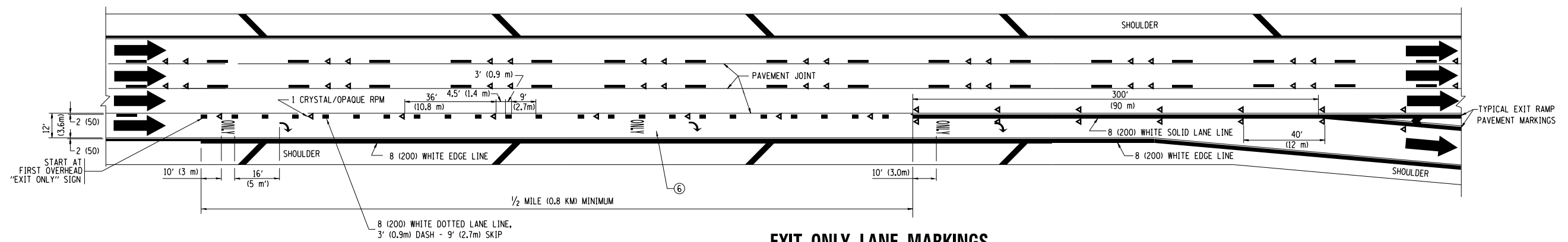

**EXIT ONLY LANE MARKINGS**

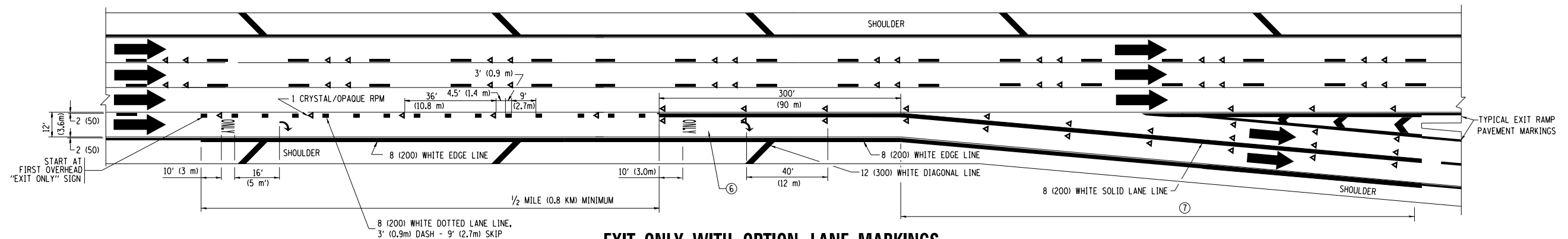

**EXIT ONLY WITH OPTION LANE MARKINGS**

- NOTES**
- ③ OMIT WHEN LENGTH OF AUXILIARY LANE IS LESS THAN 500' (150 m).
  - ④ 8-INCH WIDE DOTTED LANE LINE MARKINGS SHALL BE USED WHEN THE LENGTH OF THE AUXILIARY LANE IS 2 MILES OR LESS.
  - ⑤ FOR TWO-LANE ENTRANCE RAMP, IF RIGHT LANE ENDS, USE TYPICAL ENTRANCE RAMP PAVEMENT MARKINGS.
  - ⑥ ONLY AND ARROWS EQUALLY SPACED, 500' (150 m) MAXIMUM SPACING. FULL SIZE LETTERS AND ARROW SHALL BE USED.
  - ⑦ CONTINUE 8" SOLID LANE LINE THROUGH EXIT TO END OF PAVED GORE.

FILE NAME =	USER NAME = ougeungh	DESIGNED - D.W.S.	REVISED - D.W.S. 07-96
pw:\388039-pwintl\ecomonline\local\pwaecom\Documents\01 Americas\Transportation\0000\0000\CAD\006.Road\REVISED\60W26.Cad\02-09-06-26-SHT-D1		DRAWN CirclePhase.II.000.CAD\006.Road\REVISED\60W26.Cad\02-09-06-26-SHT-D1	REVISED - S.P.B. 01-07
	PLOT SCALE = 50.000' / in.	CHECKED -	REVISED - S.P.B. 01-10
	PLOT DATE = 8/16/2013	DATE - 01-90	

**STATE OF ILLINOIS  
DEPARTMENT OF TRANSPORTATION**

<b>MULTI-LANE FREEWAY PAVEMENT MARKING DETAILS</b>	
SCALE: NONE	SHEET NO. 19 OF 27 SHEETS
STA.	TO STA.

F.A.I. RTE.	SECTION	COUNTY	TOTAL SHEETS	SHEET NO.
	2013-008R	COOK	559	479
<b>TC-12</b>		<b>CONTRACT NO. 60W26</b>		
FED. ROAD DIST. NO. 1 ILLINOIS FED. AID PROJECT				
90/94/290				