











**ROUTE MARKERS**

-  FOR U.S. ROUTES  
MI-40-2424
-  FOR ILLINOIS ROUTES  
MI-50-2424
-  R.R. UNMARKED ROUTES  
SPECIAL 24" x 18" VARIABLE  
4" BLACK LETTERS ON WHITE  
REFLECTIVE BACKGROUND

**ARROWS SIGNS**

-  M5-1L-2115
-  M5-1R-2115
-  M6-1-2115
-  M6-1-2115
-  M6-3-2115

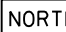
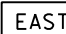
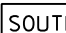
**CARDINAL DIRECTION & DETOUR SIGNS**

-  NORTH M3-1-2412
-  EAST M3-2-2412
-  SOUTH M3-3-2412
-  WEST M3-4-2412
-  DETOUR M4-8-2412

**STATE ROUTE**

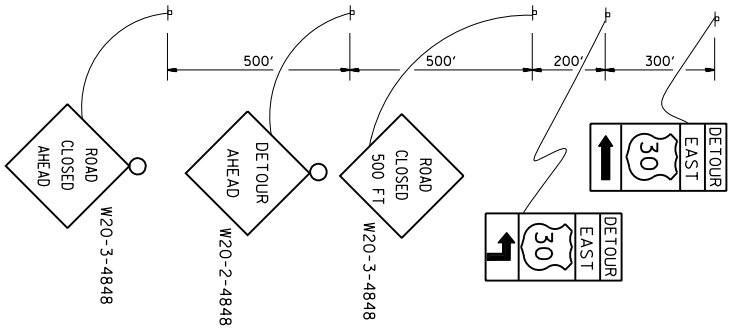

**COMPLETELY CLOSED PORTION**

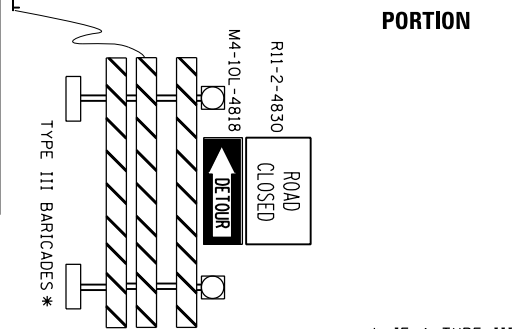

**PARTIALLY CLOSED PORTION**

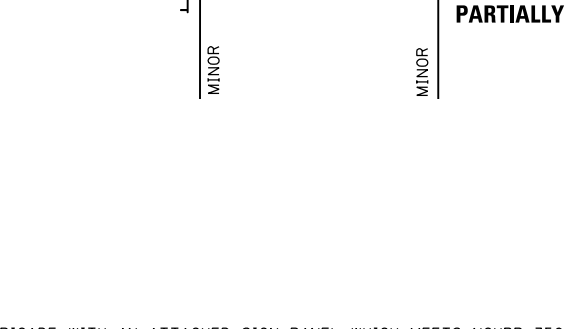

**STATE ROUTE**

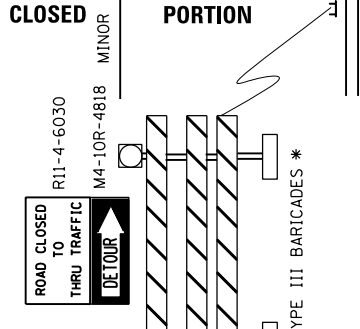

\* IF A TYPE III BARRICADE WITH AN ATTACHED SIGN PANEL WHICH MEETS NCHRP 350 REQUIREMENTS IS NOT AVAILABLE, THE SIGNS SHALL BE MOUNTED, ABOVE THE BARRICADES, ON SEPARATE SIGNS SUPPORTS THAT MEET NCHRP 350 REQUIREMENTS.

FILE NAME =	USER NAME = ougeungh	DESIGNED -	REVISED - 10-18-02
pw:\388039\pwin\l.econom\lne.local\PAE\COM\Documents\01 Americas\Transportation\4000\Drawn\Circle\Phase 11\000 CAD\006.Road\60W26\TC-21-0964209.DWG	DATE = 8/16/2013	CHECKED -	REVISED -
		DATE -	REVISED -

**STATE OF ILLINOIS  
DEPARTMENT OF TRANSPORTATION**

<b>DETOUR SIGNING</b>		<b>FOR CLOSING STATE HIGHWAYS</b>	
SCALE: NONE	SHEET NO. 22 OF 27 SHEETS	STA.	TO STA.

F.A.I. RTE.	SECTION	COUNTY	TOTAL SHEETS	SHEET NO.
	2013-008R	COOK	559	482
<b>TC-21</b>		<b>CONTRACT NO. 60W26</b>		
FED. ROAD DIST. NO. 1 ILLINOIS FED. AID PROJECT				