

DATE	
BY	
FINAL SURVEY	SURVEYED
NOTE BOOK	PLOTTED
NO.	TEMPLATE
	AREAS CHECKED

DATE	
BY	
ORIGINAL SURVEY	SURVEYED
NOTE BOOK	PLOTTED
NO.	TEMPLATE
	AREAS CHECKED

FILE PATH = p:\38803\p\1\loc\com\line\local\p\AEC\000\Documents\01_Americas\Transportation\60269938_Circle\Phase_1\000_CAD\006_Roadway\Sheets\60W26_Contract\0160W26-shr-XS-TAY-XR.dgn

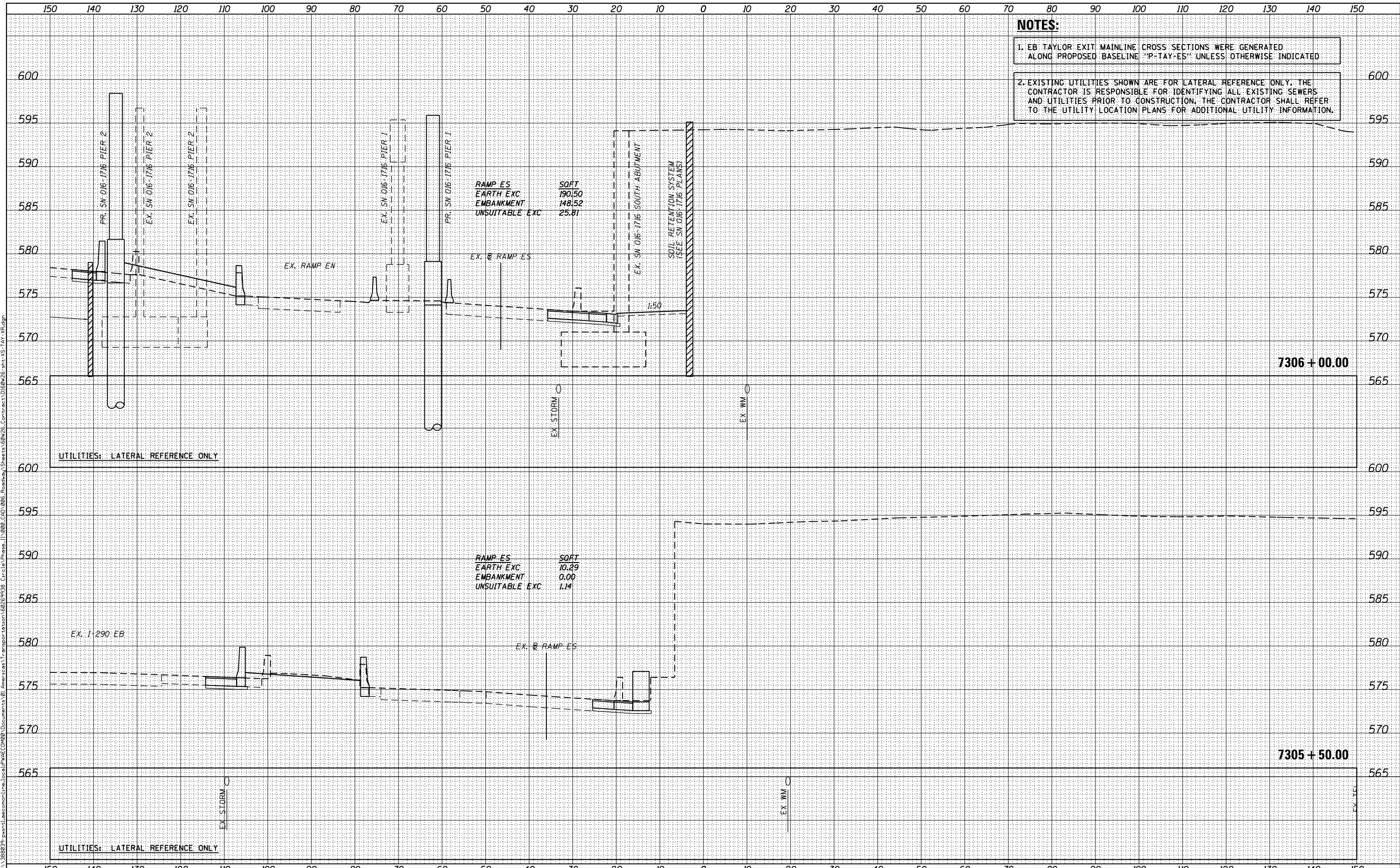

NOTES:

1. EB TAYLOR EXIT MAINLINE CROSS SECTIONS WERE GENERATED ALONG PROPOSED BASELINE "P-TAY-ES" UNLESS OTHERWISE INDICATED

2. EXISTING UTILITIES SHOWN ARE FOR LATERAL REFERENCE ONLY. THE CONTRACTOR IS RESPONSIBLE FOR IDENTIFYING ALL EXISTING SEWERS AND UTILITIES PRIOR TO CONSTRUCTION. THE CONTRACTOR SHALL REFER TO THE UTILITY LOCATION PLANS FOR ADDITIONAL UTILITY INFORMATION.



D160W26-shr-XS-TAY-XR.dgn
 USER NAME = chitua
 PLOT SCALE = 10.0000' / in.
 PLOT DATE = 9/12/2013

DESIGNED - OPS
 DRAWN - OPS
 CHECKED - DBM
 DATE - 09/15/13

REVISED -
 REVISED -
 REVISED -
 REVISED -

STATE OF ILLINOIS
 DEPARTMENT OF TRANSPORTATION

EB TAYLOR EXIT MAINLINE CROSS SECTION

SCALE: 1:5V, 1:10H SHEET 33 OF 41 SHEETS STA. 7305+50.00 TO STA. 7306+00.00

F.A.I. RTE.	SECTION	COUNTY	TOTAL SHEETS	SHEET NO.
90/94/290	2013-007R	COOK	559	551
CONTRACT NO. 60W26			ILLINOIS FED. AID PROJECT	