

DATE	
BY	
FINAL SURVEY	
SURVEYED	
PLOTTED	
TEMPLATE	
AREAS	
CHECKED	
NO.	

DATE	
BY	
ORIGINAL SURVEY	
SURVEYED	
PLOTTED	
TEMPLATE	
AREAS	
CHECKED	
NO.	

FILE PATH = p:\388039\p\1\l\com\line\local\p\AEC\DWG\Documents\01\Americas\Transportation\6229938\_Circle\Phase 1\000\_CDD\006\_Roadway\Sheets\60W26\_Contract\DI60W26-sht-XS-SB\_1-90-94.dgn

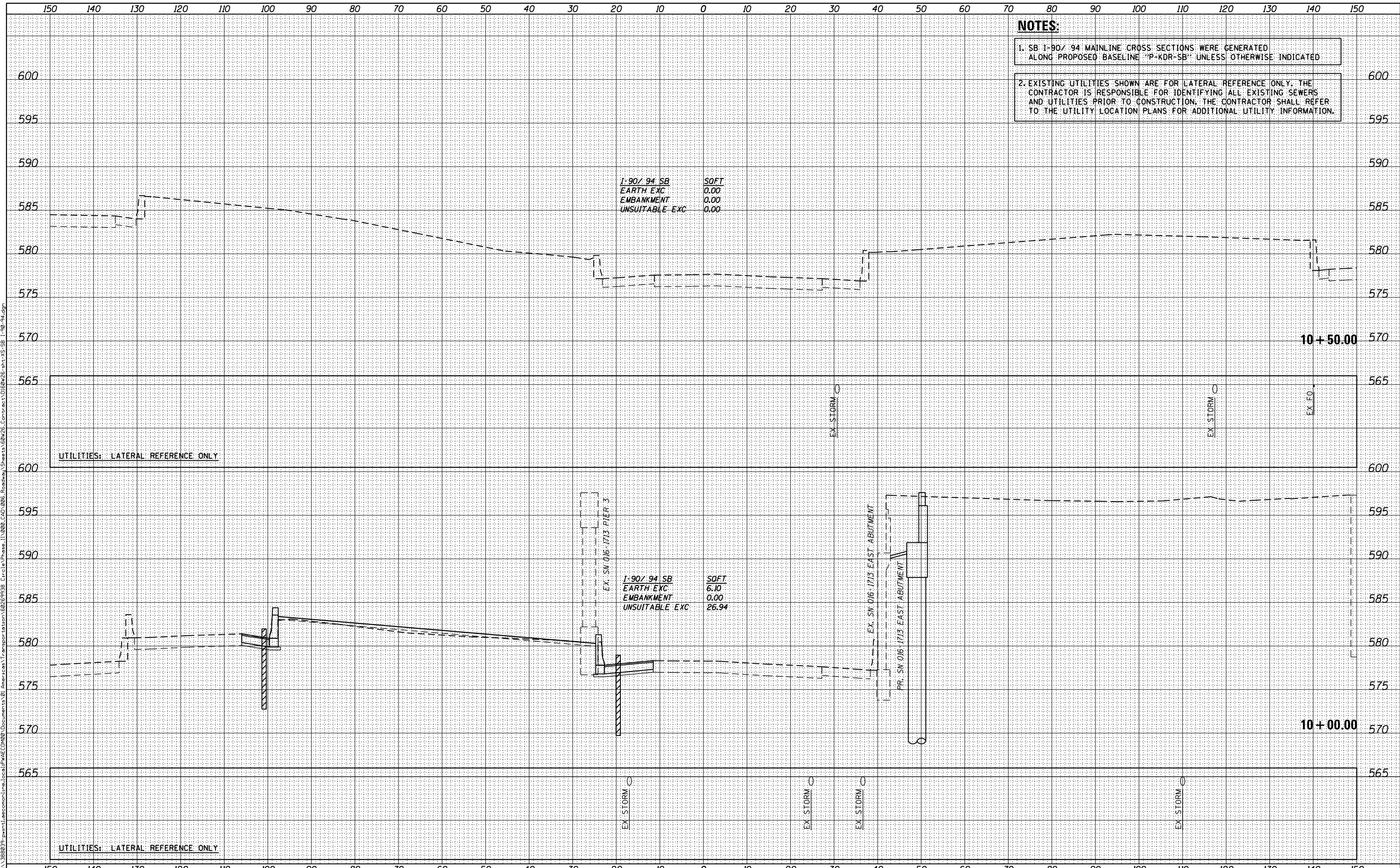

**NOTES:**

1. SB 1-90/ 94 MAINLINE CROSS SECTIONS WERE GENERATED ALONG PROPOSED BASELINE "P-KDR-SB" UNLESS OTHERWISE INDICATED

2. EXISTING UTILITIES SHOWN ARE FOR LATERAL REFERENCE ONLY. THE CONTRACTOR IS RESPONSIBLE FOR IDENTIFYING ALL EXISTING SEWERS AND UTILITIES PRIOR TO CONSTRUCTION. THE CONTRACTOR SHALL REFER TO THE UTILITY LOCATION PLANS FOR ADDITIONAL UTILITY INFORMATION.

1-90/ 94 SB  
EARTH EXC 0.00  
EMBANKMENT 0.00  
UNSUITABLE EXC 0.00

1-90/ 94 SB  
EARTH EXC 6.10  
EMBANKMENT 0.00  
UNSUITABLE EXC 26.94

EX. SW 016-1713 PIER 3

EX. SW 016-1713 EAST ABUTMENT

PR. SW 016-1713 EAST ABUTMENT

10 + 50.00

10 + 00.00



DI60W26-sht-XS-SB 1-90-94.dgn  
USER NAME = chitua  
PLOT SCALE = 10.0000' / in.  
PLOT DATE = 9/12/2013

DESIGNED - OPS  
DRAWN - OPS  
CHECKED - DBM  
DATE - 09/15/13

REVISED -  
REVISED -  
REVISED -  
REVISED -

STATE OF ILLINOIS  
DEPARTMENT OF TRANSPORTATION

SB I-90/94 MAINLINE CROSS SECTION

SCALE: 1:5V,1:10H SHEET 41 OF 41 SHEETS STA. 6229+50.00 TO STA. 6230+00.00

F.A.I. RTE.	SECTION	COUNTY	TOTAL SHEETS	SHEET NO.
90/94/290	2013-007R	COOK	559	559
CONTRACT NO. 60W26				

ILLINOIS FED. AID PROJECT