

**BENCH MARKS**  
 First Avenue Bridge over Des Plaines River, West Walk - Southwest Corner, Chiselad Square Elev. 630.74  
 BM 30445- First Ave and Fullerton (River Grove) Concrete Monument on S.W. Corner with Iron Pin set in center. CCHD Elev. 623.533.  
 50.0' W. of E. of First Ave.  
 44.0' So of E. of Fullerton

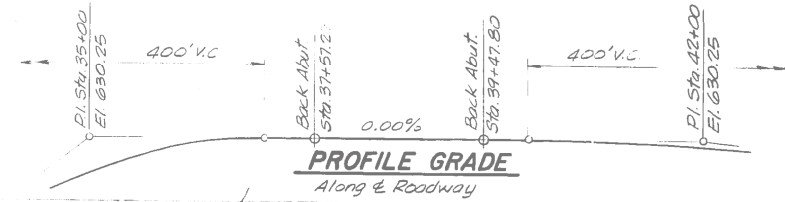

**DESCRIPTION OF IMPROVEMENT**  
 The Improvement includes the bridge superstructure replacement and repair of substructure and approaches (includes widening) of the structure carrying First Avenue over the Des Plaines River, consisting of a three-span (190'-6 3/8" back to back of abutments) new reinforced concrete deck slab (63'-2" out to out) on new precast prestressed I-beams, on existing piers and abutments with new caps, utilizing stage construction so as to maintain traffic at all times.

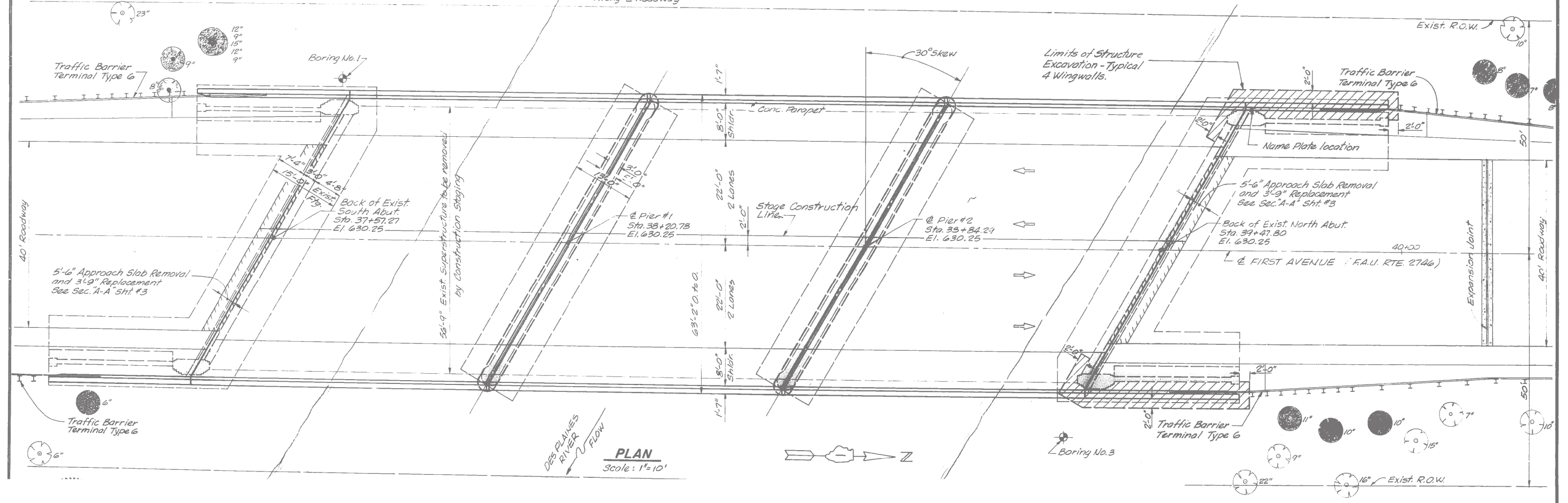

For Information Only

FILE NAME =	USER NAME = josephm	DESIGNED -	REVISED -	<b>STATE OF ILLINOIS DEPARTMENT OF TRANSPORTATION</b>	<b>IL 171 (FIRST AVE) OVER DES PALINES RIVER GENERAL PLAN &amp; ELEVATION</b>	F.A.P. RTE.	SECTION	COUNTY	TOTAL SHEETS	SHEET NO.	
Default	Plot Scale = 100.0000' / in.	DRAWN -	REVISED -			372	0606-BR	COOK	9	4	
	Plot Date = 8/27/2013	CHECKED -	REVISED -			<b>CONTRACT NO. 60W88</b>					
		DATE -	REVISED -			ILLINOIS FED. AID PROJECT					
					SCALE:	SHEET	1 OF 1 SHEETS	STA.	TO STA.		