

F.A.P. RTE.	SECTION	COUNTY	TOTAL SHEETS	SHEET NO.
372	0606-BR	COOK	9	1
		ILLINOIS	CONTRACT NO. 60W88	

STATE OF ILLINOIS  
DEPARTMENT OF TRANSPORTATION  
DIVISION OF HIGHWAYS

**PROPOSED  
HIGHWAY PLANS**

F.A.P. ROUTE 372: IL 171 (FIRST AVE)  
OVER DES PLAINES RIVER  
SECTION: 0606-BR  
SUBSTRUCTURE REPAIRS  
COOK COUNTY  
C-91-397-13

FOR INDEX OF SHEETS, SEE SHEET NO. 2

THIS IMPROVEMENT IS LOCATED  
IN THE VILLAGE OF RIVER GROVE

D-91-397-13

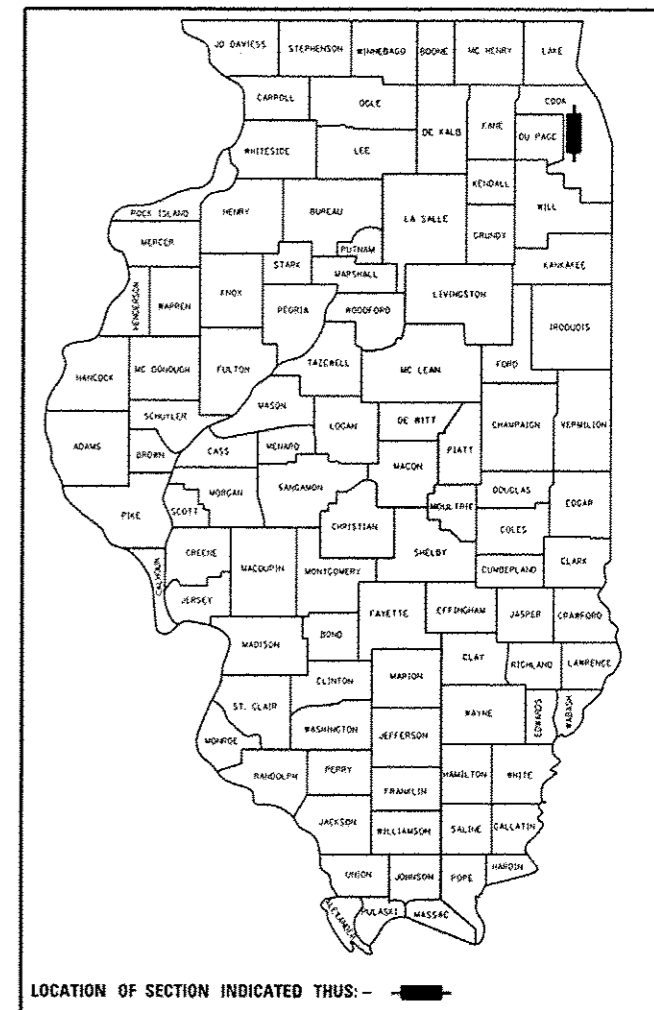

SN 016-0697-IL 171 (FIRST AVE)  
OVER DES PLAINES RIVER

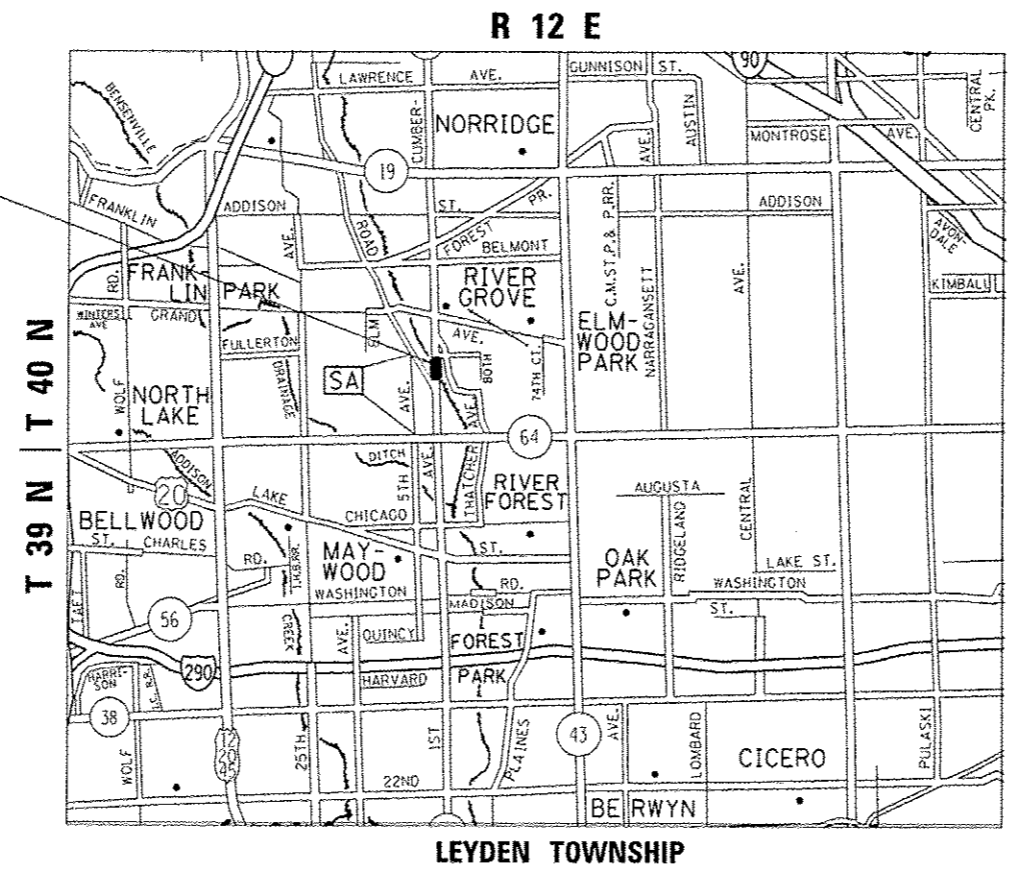

TRAFFIC DATA  
ADT = 17900  
POSTED SPEED LIMIT = 40 MPH

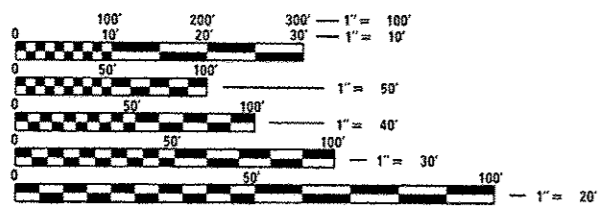

FULL SIZE PLANS HAVE BEEN PREPARED USING STANDARD ENGINEERING SCALES. REDUCED SIZED PLANS WILL NOT CONFORM TO STANDARD SCALES. IN MAKING MEASUREMENTS ON REDUCED PLANS, THE ABOVE SCALES MAY BE USED.

J.U.L.I.E.  
JOINT UTILITY LOCATION INFORMATION FOR EXCAVATION  
1-800-892-0123  
OR 811

PROJECT ENGINEER: J. ALAIN MIDY (847) 221-3056  
PROJECT MANAGER: ISSAM RAYYAN (847) 847-4178

GROSS & NET LENGTH = 193.5 FT. = 0.03667 MILE

CONTRACT NO. 60W88

STATE OF ILLINOIS  
DEPARTMENT OF TRANSPORTATION  
DIVISION OF HIGHWAYS

SUBMITTED August 21, 2013  
John F. ...  
DEPUTY DIRECTOR OF HIGHWAYS, REGION ENGINEER

October 4, 2013  
John D. Baranelli, P.E.  
ENGINEER OF DESIGN AND ENVIRONMENT

October 4, 2013  
Omer Osman, P.E.  
DIRECTOR OF HIGHWAYS, CHIEF ENGINEER

PRINTED BY THE AUTHORITY  
OF THE STATE OF ILLINOIS