

**CONTROLLER SEQUENCE**

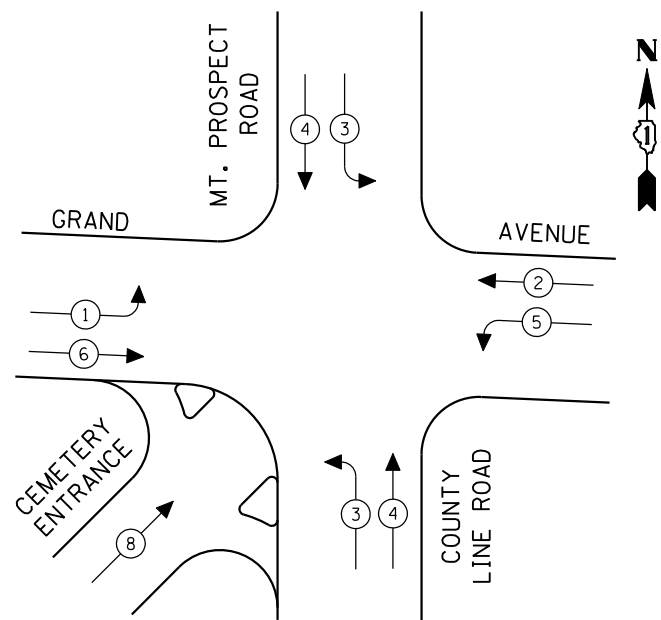

**EXISTING PHASE DESIGNATION DIAGRAM**

**EXISTING EMERGENCY VEHICLE PREEMPTION SEQUENCE**

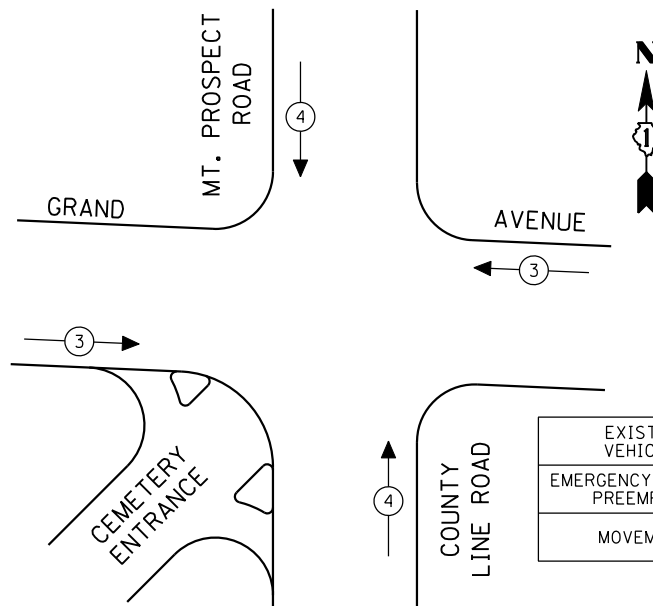

| EXISTING EMERGENCY VEHICLE PREEMPTORS |   |   |
|---------------------------------------|---|---|
| EMERGENCY VEHICLE PREEMPTOR           | 3 | 4 |
| MOVEMENT                              | ← | ↓ |

- THE FOLLOWING ITEMS SHALL BE REMOVED BY THE CONTRACTOR AND SHALL BE DISPOSED OF BY THEM OUTSIDE THE RIGHT-OF-WAY AT THEIR EXPENSE. THE SALVAGE VALUE OF THE REMOVED EQUIPMENT SHALL BE REFLECTED IN THE CONTRACTOR'S BID PRICE.
- 2 EACH SIGNAL HEAD, 1-FACE, 3-SECTION, MAST-ARM MOUNTED
  - 2 EACH SIGNAL HEAD, 1-FACE, 5-SECTION, BRACKET MOUNTED
  - 2 EACH SIGNAL HEAD, 1-FACE, 5-SECTION, MAST-ARM MOUNTED
  - 2 EACH OPTICALLY PROGRAMMED SIGNAL HEAD, 1-FACE, 3-SECTION, MAST ARM MOUNTED
  - 1 EACH OPTICALLY PROGRAMMED SIGNAL HEAD, 1-FACE, 3-SECTION, BRACKET MOUNTED
  - 2 EACH OPTICALLY PROGRAMMED SIGNAL HEAD, 1-FACE, 5-SECTION, MAST ARM MOUNTED
  - 1 EACH OPTICALLY PROGRAMMED SIGNAL HEAD, 1-FACE, 5-SECTION, BRACKET MOUNTED
  - 1 EACH OPTICALLY PROGRAMMED SIGNAL HEAD, 2-FACE, 1-3 SECTION, 1-5 SECTION, BRACKET MOUNTED
  - 8 EACH TRAFFIC SIGNAL BACKPLATE

**SCHEDULE OF QUANTITIES**

| QUANTITY | UNIT | ITEM   |
|----------|------|--|
| 1        | EACH | MAINTENANCE OF EXISTING TRAFFIC SIGNAL INSTALLATION                                      |
| 2        | EACH | SIGNAL HEAD, LED, 1-FACE, 3-SECTION, MAST ARM MOUNTED                                    |
| 2        | EACH | SIGNAL HEAD, LED, 1-FACE, 5-SECTION, BRACKET MOUNTED                                     |
| 2        | EACH | SIGNAL HEAD, LED, 1-FACE, 5-SECTION, MAST ARM MOUNTED                                    |
| 1        | EACH | OPTICALLY PROGRAMMED SIGNAL HEAD, LED, 1-FACE, 3-SECTION, BRACKET MOUNTED                |
| 2        | EACH | OPTICALLY PROGRAMMED SIGNAL HEAD, LED, 1-FACE, 3-SECTION, MAST ARM MOUNTED               |
| 1        | EACH | OPTICALLY PROGRAMMED SIGNAL HEAD, LED, 1-FACE, 5-SECTION, BRACKET MOUNTED                |
| 2        | EACH | OPTICALLY PROGRAMMED SIGNAL HEAD, LED, 1-FACE, 5-SECTION, MAST ARM MOUNTED               |
| 8        | EACH | TRAFFIC SIGNAL BACKPLATE, RETROREFLECTIVE  |
| 1        | EACH | MODIFY EXISTING CONTROLLER CABINET   |
| 1        | EACH | REMOVE EXISTING TRAFFIC SIGNAL EQUIPMENT   |
| 1        | EACH | UNINTERRUPTIBLE POWER SUPPLY, SPECIAL  |
| 1        | EACH | OPTICALLY PROGRAMMED SIGNAL HEAD, LED, 2-FACE, 1-3 SECTION, 1-5 SECTION, BRACKET MOUNTED |

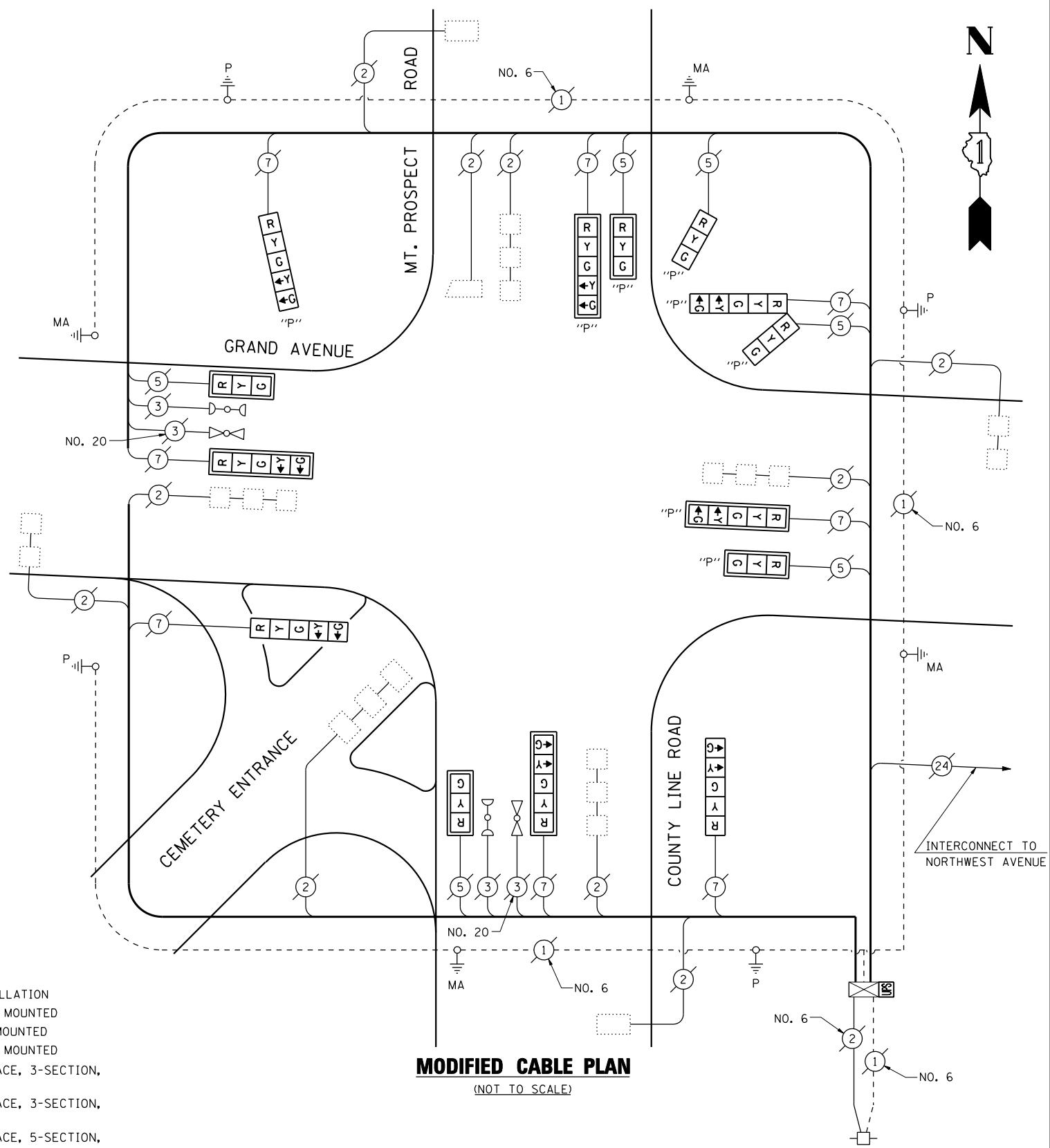

**MODIFIED CABLE PLAN**  
(NOT TO SCALE)

THE TRAFFIC SIGNAL CONTROL EQUIPMENT FOR THIS PROJECT SHALL BE "EAGLE" TO MATCH THE EXISTING ADJACENT SYSTEM.

| I.D.O.T. TRAFFIC SIGNAL INSTALLATION ELECTRICAL SERVICE REQUIREMENTS   |          |                 |     |            | TOTAL WATTAGE |
|--|----------|-----------------|-----|------------|---------------|
| TYPE   | NO LAMPS | WATTAGE INCAND. | LED | %OPERATION |               |
| SIGNAL (RED)   | 14       | 17              |     | 0.50       | 119           |
| (YELLOW)   | 14       |                 | 25  | 0.25       | 87.5          |
| (GREEN)  | 14       |                 | 15  | 0.25       | 52.5          |
| ARROW  | 16       |                 | 12  | 0.10       | 19.2          |
| PED. SIGNAL  |          |                 | 25  | 1.00       |               |
| CONTROLLER ILLUM. SIGN   | 1        |                 | 100 | 1.00       | 100           |
| VIDEO SYSTEM   |          | 150             |     | 1.00       |               |
| FLASHER  |          |                 |     | 0.50       |               |
| ENERGY COSTS TO:   |          |                 |     |            | TOTAL = 378.2 |
| ILLINOIS DEPARTMENT OF TRANSPORTATION<br>201 WEST CENTER COURT<br>SCHAUMBURG, ILLINOIS 60196-1096<br>ENERGY SUPPLY CONTACT: JENNIFER BERTHOLD<br>PHONE: (708) 410-5314<br>COMPANY: COMMONWEALTH EDISON |          |                 |     |            |               |

|             |                        |                  |           |
|-------------|------------------------|------------------|-----------|
| FILE NAME = | USER NAME = \$USER\$   | DESIGNED - PKG   | REVISED - |
| \$FILEL\$   |                        | DRAWN - EA       | REVISED - |
|             | PLOT SCALE = \$SCALE\$ | CHECKED - PKG    | REVISED - |
|             | PLOT DATE = \$DATE\$   | DATE - 8/15/2013 | REVISED - |

**STATE OF ILLINOIS  
DEPARTMENT OF TRANSPORTATION**

**CABLE PLAN, EXISTING PHASE DESIGNATION DIAGRAM,  
EXISTING EMERGENCY VEHICLE PREEMPTION SEQUENCE, AND SCHEDULE OF QUANTITIES  
GRAND AVENUE AT MT. PROSPECT ROAD / COUNTY LINE ROAD**

|   |            |        |              |           |
|---|------------|--------|--------------|-----------|
| F.A.U. RTE.                                     | SECTION    | COUNTY | TOTAL SHEETS | SHEET NO. |
| 1376  | 2013-045TS | COOK   | 24           | 15        |
| CONTRACT NO. 60W98                              |            |        |              |           |
| FED. ROAD DIST. NO. - ILLINOIS FED. AID PROJECT |            |        |              |           |

SCALE: N.T.S. SHEET NO. OF SHEETS STA. TO STA.