

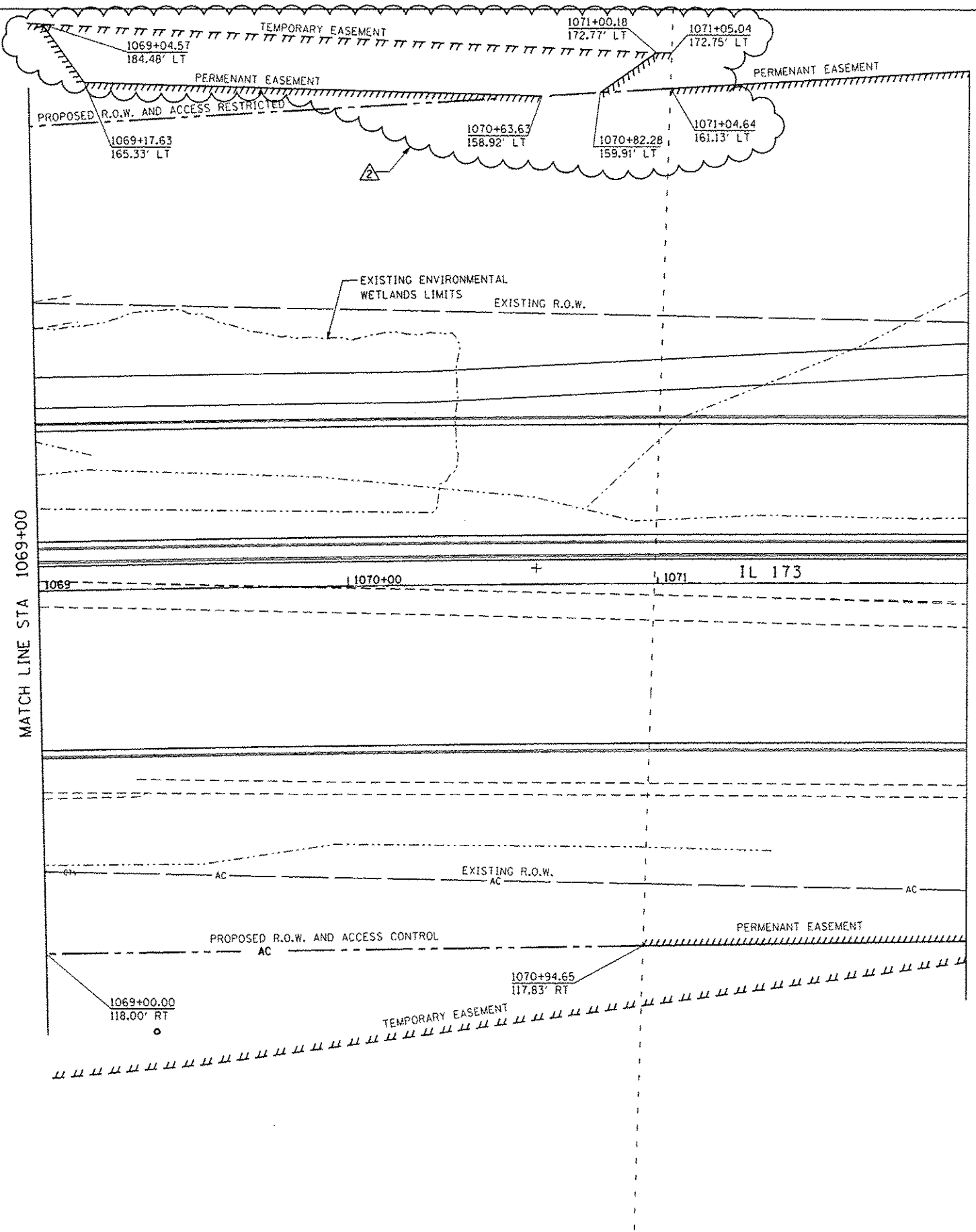

PROP. CURVE 74330
 PI STA. = 1070+60.92
 Δ = 3° 13' 46" (RT)
 D = 0° 26' 00"
 R = 13,225.13'
 T = 372.80'
 L = 745.40'
 E = 5.25'
 θ = -----
 T.R. = -----
 S.E. RUN = -----
 P.C. STA = 1066+88.12
 P.T. STA = 1074+33.52



REV. 9-21-13

FILE NAME: I:\SAP\projects\2013\JOBS\10-21\lpc\work\1069-1072\ALPINE\RIGHT OF WAY\1069-1072.dwg
 PLOT SCALE: 1/4" = 20'
 PLOT DRIVER: PLOTDRIVER



USER NAME = rgoertz	DESIGNED - KEC	REVISED -
PLOT SCALE = 1/4" = 20'	DRAWN - KEC	REVISED -
PLOT DATE = 9/17/2013 04:03:34 AM	CHECKED - MTM	REVISED -
	DATE - APRIL 30, 2013	REVISED -

**STATE OF ILLINOIS
 DEPARTMENT OF TRANSPORTATION**

RIGHT OF WAY PLANS	
IL 173 FROM ALPINE ROAD TO I-90	
PROJECT	JOB NO.
SCALE: 1"=20'	SHEET NO. 9 OF 41 SHEETS
STA. 1069+00 TO STA. 1072+00	

F.A.P. RTE.	SECTION	COUNTY	TOTAL SHEETS	SHEET NO.
303	129R	WINNEBAGO	968	497
CONTRACT NO. 64988				
ILLINOIS FED. AID PROJECT				