

PROP. CURVE 360
 PI STA. = 456+97.71
 $\Delta = 19^\circ 47' 56''$ (LT)
 $D = 5^\circ 32' 49''$
 $R = 1,032.92'$
 $T = 180.26'$
 $L = 356.93'$
 $E = 15.61'$
 $e = \text{---}$
 $T.R. = \text{---}$
 $S.E. \text{ RUN} = \text{---}$
 $P.C. \text{ STA} = 455+17.45$
 $P.T. \text{ STA} = 458+74.38$

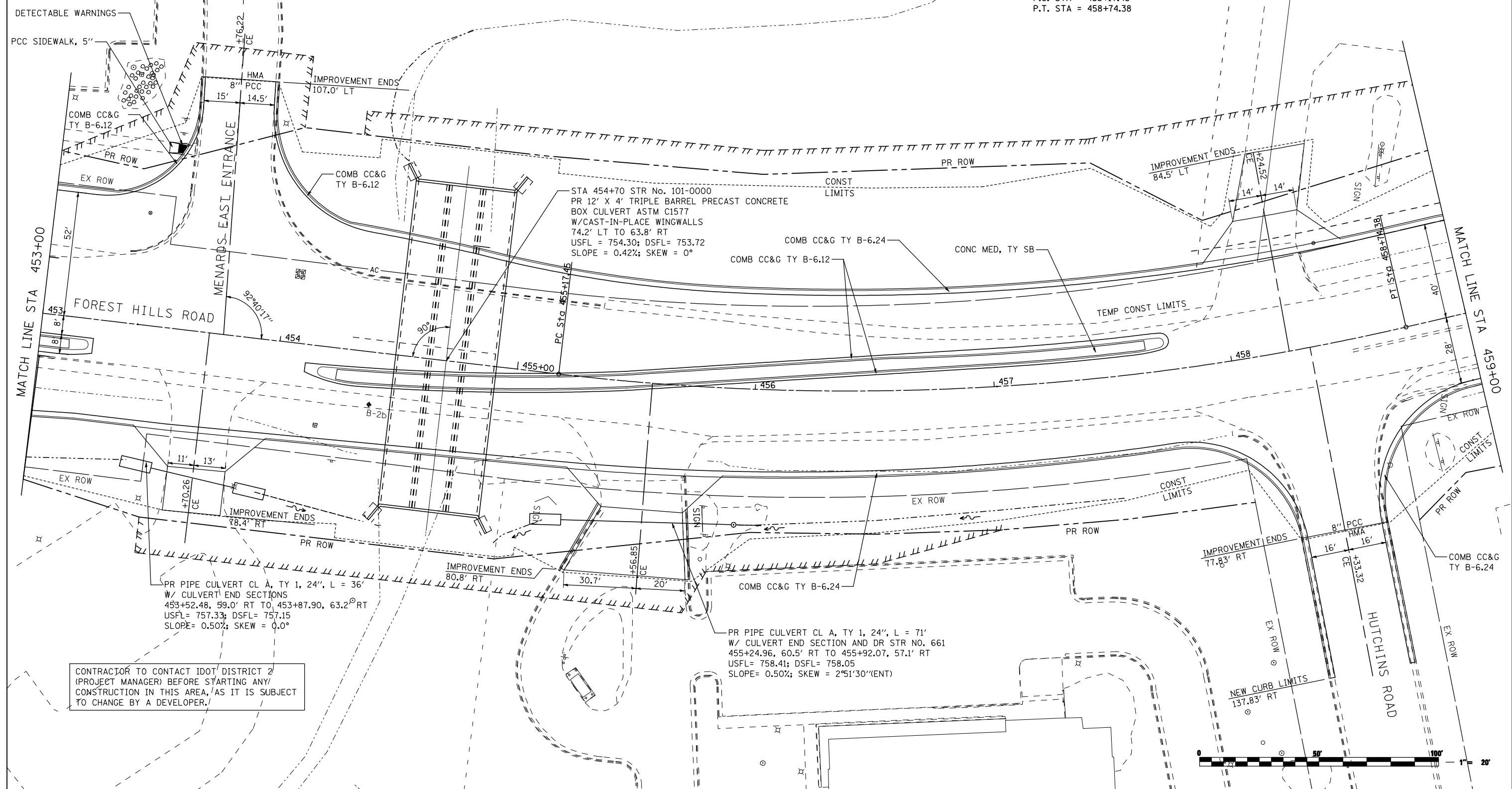

STA 454+70 STR No. 101-0000
 PR 12' X 4' TRIPLE BARREL PRECAST CONCRETE
 BOX CULVERT ASTM C1577
 W/CAST-IN-PLACE WINGWALLS
 74.2' LT TO 63.8' RT
 USFL = 754.30; DSFL = 753.72
 SLOPE = 0.42%; SKEW = 0°

PR PIPE CULVERT CL A, TY 1, 24", L = 36'
 W/ CULVERT END SECTIONS
 453+52.48, 59.0' RT TO 453+87.90, 63.2' RT
 USFL = 757.33; DSFL = 757.15
 SLOPE = 0.50%; SKEW = 0.0°

PR PIPE CULVERT CL A, TY 1, 24", L = 71'
 W/ CULVERT END SECTION AND DR STR NO. 661
 455+24.96, 60.5' RT TO 455+92.07, 57.1' RT
 USFL = 758.41; DSFL = 758.05
 SLOPE = 0.50%; SKEW = 2°51'30" (ENT)

CONTRACTOR TO CONTACT IDOT DISTRICT 2
 (PROJECT MANAGER) BEFORE STARTING ANY
 CONSTRUCTION IN THIS AREA, AS IT IS SUBJECT
 TO CHANGE BY A DEVELOPER.



FILE NAME = ... \CADD SHEETS\Z00793PLN35.dgn	USER NAME = Elgin 110	DESIGNED - MJS	REVISED -	STATE OF ILLINOIS DEPARTMENT OF TRANSPORTATION	ROADWAY PLANS FOREST HILLS ROAD			F.A.P. RTE. 303	SECTION 129R	COUNTY WINNEBAGO	TOTAL SHEETS 968	SHEET NO. 180	
THE UPCHURCH GROUP, INC.	PLOT SCALE = 40.0000' / IN.	CHECKED - RLH	REVISED -		SCALE: 1"=20'	SHEET NO.	OF SHEETS	STA. 453+00	TO STA. 459+00	CONTRACT NO. 64988			
	PLOT DATE = 5/6/2013 2:37:00 PM	DATE - APRIL 30, 2013	REVISED -		ILLINOIS FED. AID PROJECT								