

STAGE 3 - TYPICAL SECTION
STA 450+00.00 TO STA 453+71.89

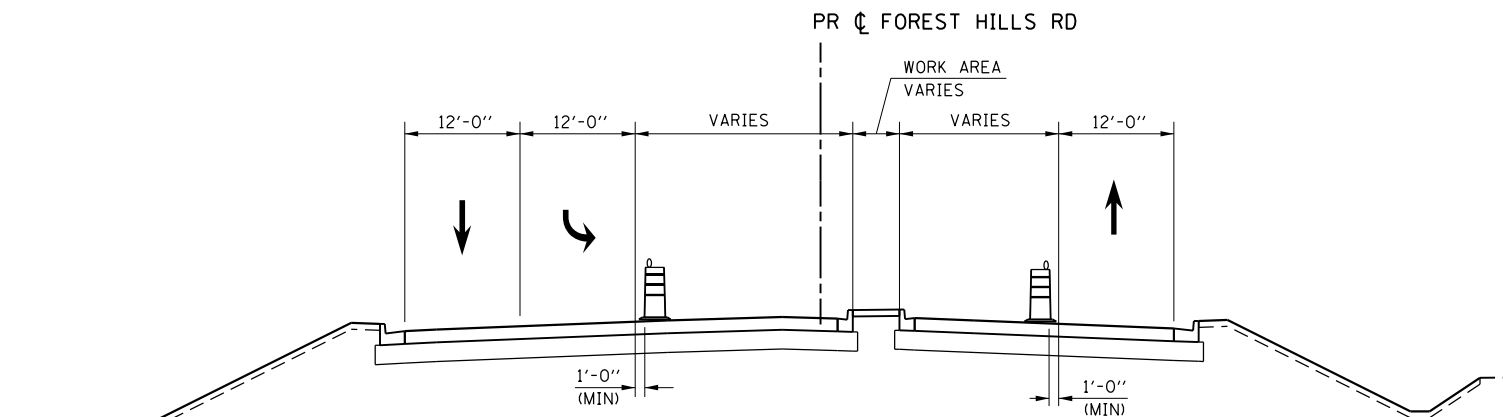

STAGE 3 - TYPICAL SECTION
STA 453+71.89 TO STA 455+17.45

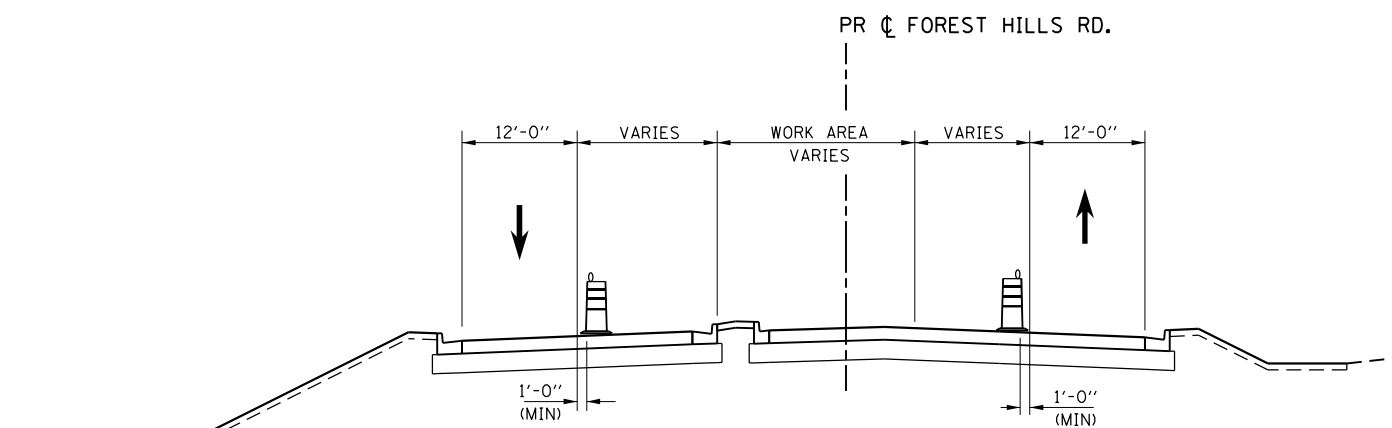

STAGE 3 - TYPICAL SECTION
STA 455+17.45 TO STA 458+00.00

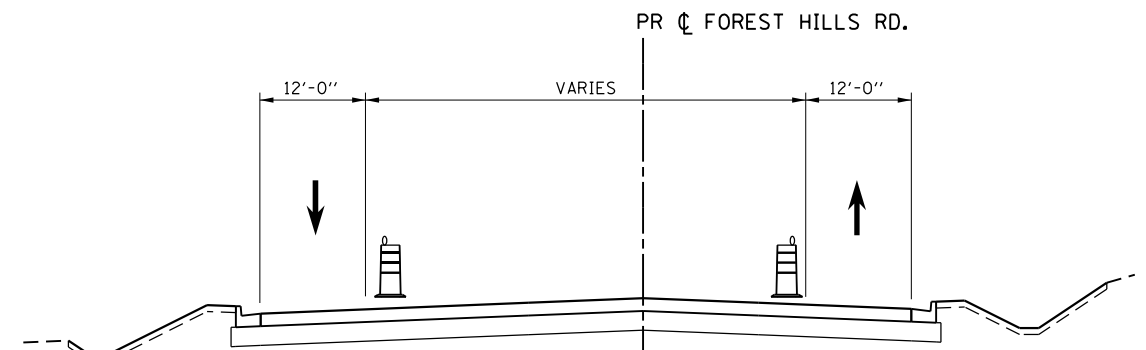

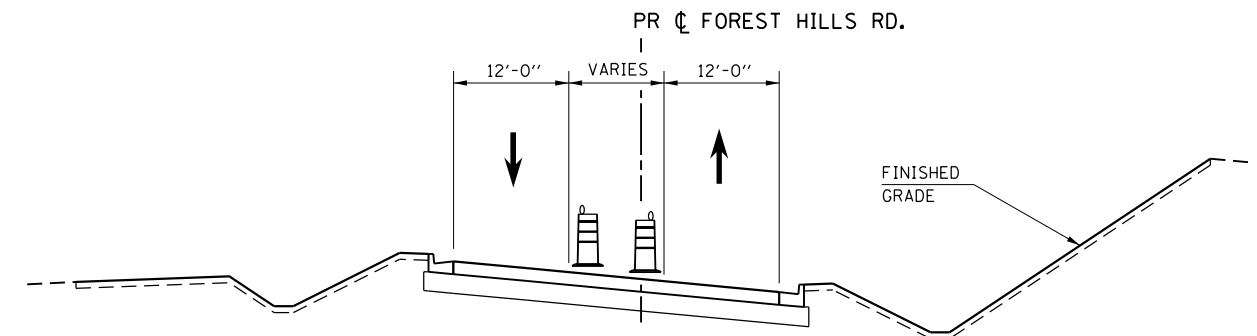

STAGE 3 - TYPICAL SECTION
STA 458+00.00 TO STA 462+12.70



STAGE 3 - TYPICAL SECTION
STA 462+12.70 TO STA 466+17.00

LEGEND

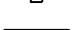
-  VERTICAL PANEL
-  TYPE II BARRICADE OR DRUM WITH STEADY BURN BI-DIRECTIONAL LIGHT
-  TEMPORARY CONCRETE BARRIER
-  EX PAVEMENT, EX SHOULDER, OR TEMPORARY PAVEMENT REMOVAL

NOTES:

1. SEE "STAGING PLANS - STAGE 3" FOR LANE CONFIGURATION & TEMPORARY STRIPING.

FILE NAME = Z007935TG-TYP-IL173.01.dgn
MODEL = Default
PLOT DRIVER = Vb...IDOT...PDF...1x17.pltcf9



USER NAME = rgoertz	DESIGNED - RG	REVISED -
PLOT SCALE = 240.0000' / ft.	DRAWN - TRF	REVISED -
PLOT DATE = 5/3/2013	CHECKED - CMS	REVISED -
	DATE - APRIL 30, 2013	REVISED -

**STATE OF ILLINOIS
DEPARTMENT OF TRANSPORTATION**

**STAGING TYPICAL SECTIONS - STAGE 3
FOREST HILLS RD**

SCALE: SHEET NO. OF SHEETS STA. TO STA.

F.A.P. RTE. 303	SECTION 129R	COUNTY WINNEBAGO	TOTAL SHEETS 968	SHEET NO. 311
CONTRACT NO. 64988				
FED. ROAD DIST. NO. 2 ILLINOIS FED. AID PROJECT				